



EASTGATE

Englefield Green | Surrey



A DETACHED HOUSE IN ENGLEFIELD GREEN

set in circa 0.5 acre with a heated swimming pool.



4 - 5



5



4

EPC

D



Local Authority: Runnymede Borough Council

Council Tax band: H

Tenure: Freehold

Guide Price: £2,500,000



EASTGATE

Eastgate sits on Coopers Hill Lane in the well-located and desirable village of Englefield Green. There is a large reception hall with open fireplace which leads into the stunning bespoke kitchen / breakfast / family room which has a part vaulted ceiling and enjoys access and splendid views over the rear gardens.

There is superb reception space which is perfect for those who like to spread out or work from home. The amazing studio/workspace could suit an artist or house a gym and there is a large utility room that accesses the 500+ bottle sunken wine cellar.

The master bedroom suite has a separate large dressing room and bathroom, and there are three further double bedrooms, all of which have en-suites, and a downstairs cloakroom with bathroom. All the upstairs rooms are air conditioned.









OUTDOORS

Electric double gates lead onto a large gravelled parking area where the carport is located, and a gate leads into the main gardens where the house sits central to its beautiful plot with privacy provided by the mature trees and shrubbery.

The orchard area has apple, damson and plum trees, and throughout the garden the borders are beautifully stocked. There is plenty of space for children to run around and there is a heated swimming pool measuring approx. 32' x 16' with 'walk on cover'.







LOCAL AMENITIES

The best of village charm with excellent connectivity.

This charming location offers everyday conveniences with a selection of local shops, cafés, and amenities, while nearby Egham provides a wider range of services. For more extensive shopping and leisure options, both Windsor and Staines are within easy reach.

Excellent transport links make this an ideal location for commuters. Rail services to London Waterloo are available from Egham (1.6 miles), Staines, and Virginia Water, with journey times from 40 minutes. Road connections are equally strong, with nearby access to the M25 (Junction 13), offering links to the M4, M3, and Heathrow Airport.

The area is renowned for its outstanding choice of schools, including prestigious institutions such as Eton College, Wellington College, St. George's School, St Mary's School, Papplewick, Bishopsgate School, St. John's Beaumont, and Lambrook School. For international education, both TASIS and ACS International School are close by.

Please note: all times and distances are approximate.







LOCATION

Englefield Green is known for its strong sense of community, village green cricket, and historic character. It is home to the beautiful campus of Royal Holloway, University of London, and is moments from the open spaces of Windsor Great Park, the tranquil Savill Garden, and the historic site of Runnymede, where the Magna Carta was signed in 1215. The nearby RAF Memorial provides a peaceful place for reflection with breathtaking panoramic views across the Thames Valley.

Nearby Windsor hosts a vibrant calendar of events including the Royal Windsor Horse Show, Windsor Farmers' Market, Windsor Dog Show, Windsor on Ice, and a full programme at the Theatre Royal Windsor. The iconic Changing of the Guard at Windsor Castle remains a spectacular reminder of the town's royal heritage.

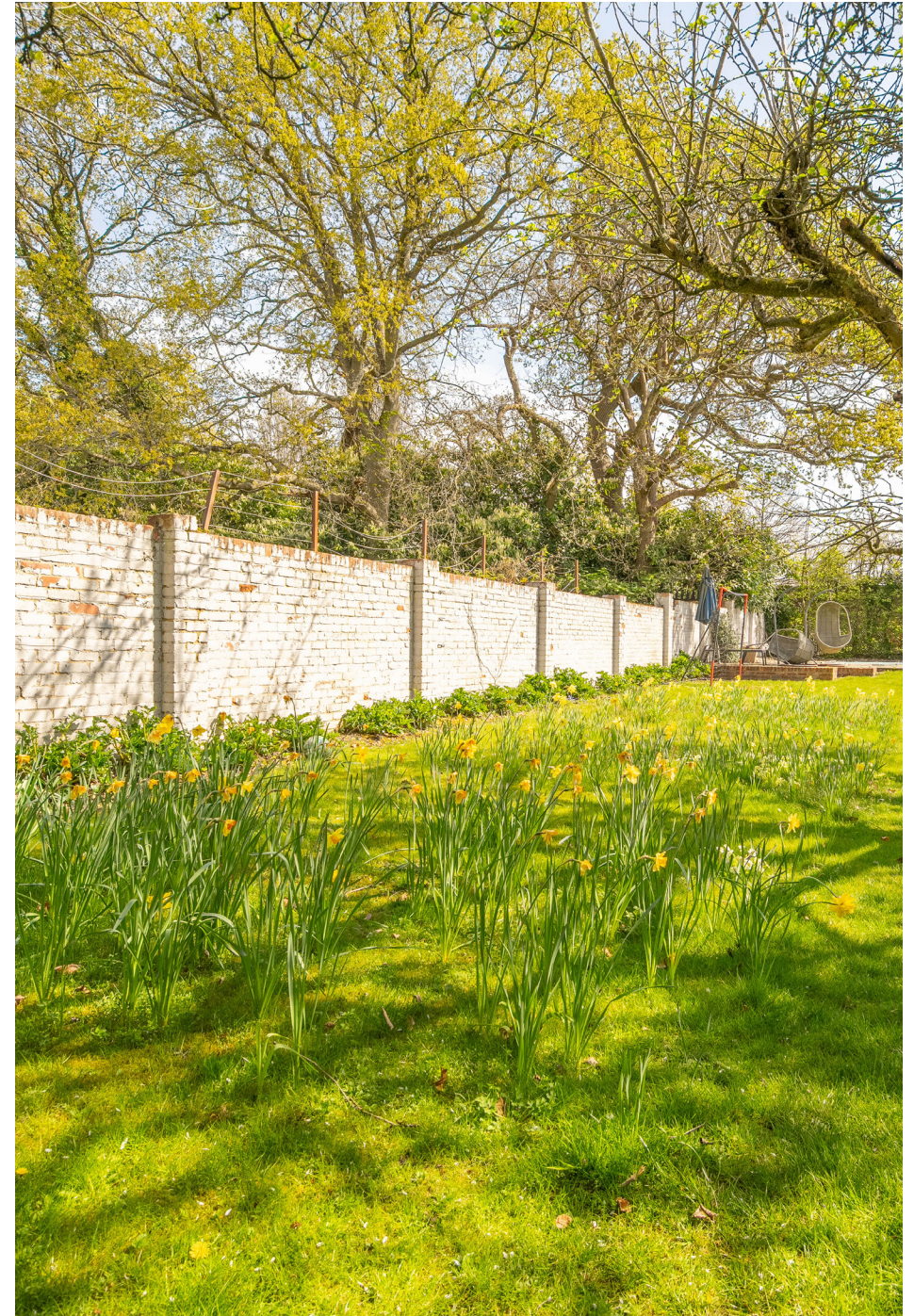



APPROXIMATE FLOOR AREA
House - 354.00 sq m - 3807 sq ft
(Gross Internal Area)

NOT TO SCALE
This plan is for illustration purposes only

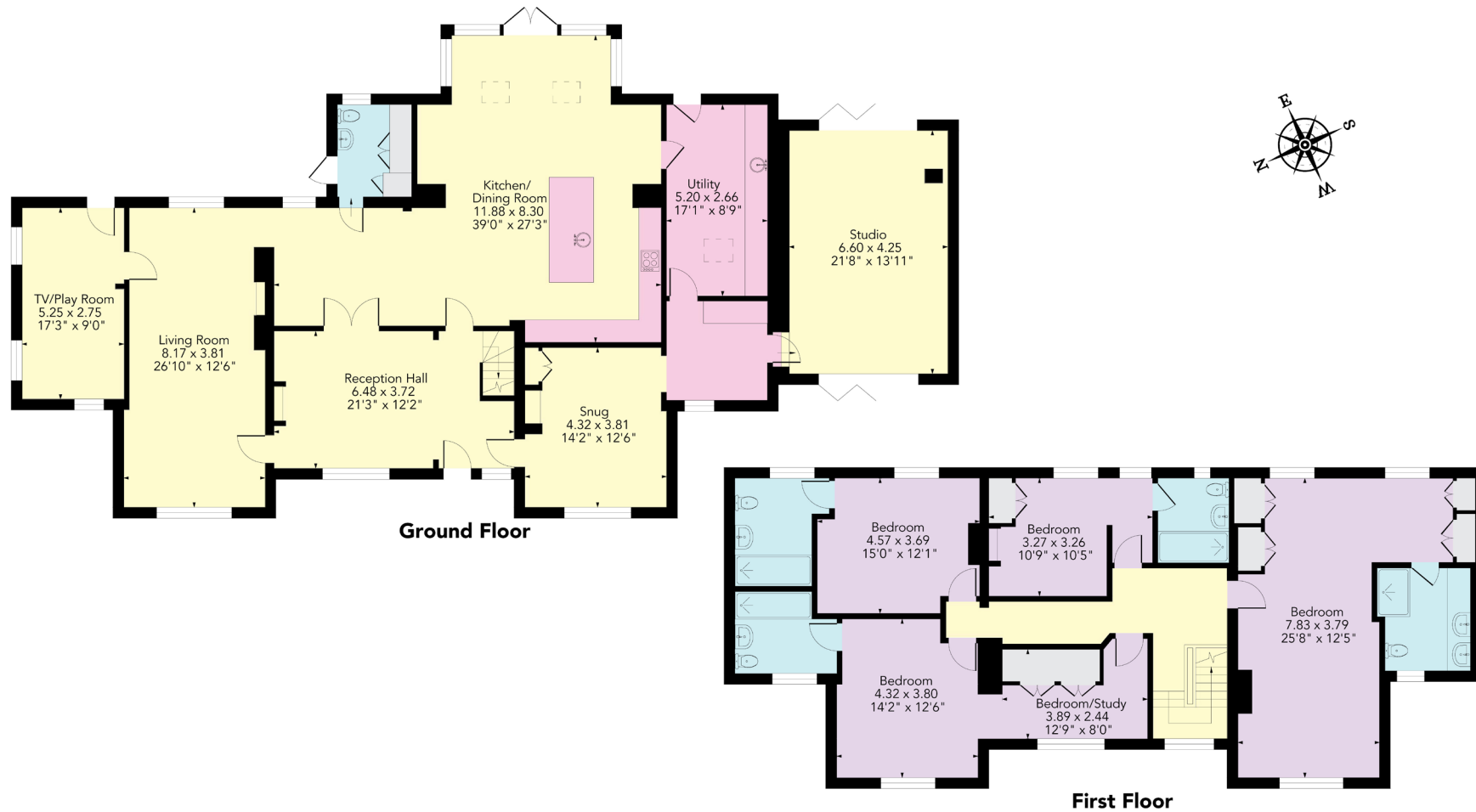

This plan is for layout guidance only. Not drawn to scale unless stated. Windows and door openings are approximate. Whilst ever in the preparation of this plan, please check all dimensions, shapes and compass bearings before making any decisions reliant u

©PROPERTYSHOOT

This plan is for layout guidance only. Not drawn to scale unless stated. Windows and door openings are approximate. Whilst every care is taken in the preparation of this plan, please check all dimensions, shapes and compass bearings before making any decisions reliant upon them. (ID767266)



Alex Hancock

+44 1344 293153

alex.hancock@knightfrank.com

Knight Frank Ascot & Virginia Water

20 Station Approach, Virginia Water, GU25 4DW

59 High Street, Ascot, SL5 7HP

[knightfrank.co.uk](https://www.knightfrank.co.uk)

Your partners in property

1. Particulars: These particulars are not an offer or contract, nor part of one. You should not rely on statements given by Knight Frank in the particulars, by word of mouth or in writing ("information") as being factually accurate about the property, its condition or its value. Neither Knight Frank nor any joint agent has any authority to make any representations about the property, and accordingly any information given is entirely without responsibility on the part of Knight Frank. 2. Material Information: Please note that the material information is provided to Knight Frank by third parties and is provided here as a guide only. While Knight Frank has taken steps to verify this information, we advise you to confirm the details of any such material information prior to any offer being submitted. If we are informed of changes to this information by the seller or another third party, we will use reasonable endeavours to update this as soon as practical. 3. Photos, Videos etc: The photographs, property videos and virtual viewings etc. show only certain parts of the property as they appeared at the time they were taken. Areas, measurements and distances given are approximate only. 4. Regulations etc: Any reference to alterations to, or use of, any part of the property does not mean that any necessary planning, building regulations or other consent has been obtained. A buyer must find out by inspection or in other ways that these matters have been properly dealt with and that all information is correct. 5. Fixtures and fittings: A list of the fitted carpets, curtains, light fittings and other items fixed to the property which are included in the sale (or may be available by separate negotiation) will be provided by the Seller's Solicitors. 6. VAT: The VAT position relating to the property may change without notice. 7. To find out how we process Personal Data, please refer to our Group Privacy Statement and other notices at <https://www.knightfrank.com/legals/privacy-statement>.

Particulars dated November 2025. Photographs and videos dated May 2025. All information is correct at the time of going to print. Knight Frank is the trading name of Knight Frank LLP. Knight Frank LLP is a limited liability partnership registered in England and Wales with registered number OC305934. Our registered office is at 55 Baker Street, London W1U 8AN. We use the term 'partner' to refer to a member of Knight Frank LLP, or an employee or consultant. A list of members names of Knight Frank LLP may be inspected at our registered office. If you do not want us to contact you further about our services then please contact us by either calling 020 3544 0692, email to marketing.help@knightfrank.com or post to our UK Residential Marketing Manager at our registered office (above) providing your name and address.

