



GROVE LANE

Bracknell, RG42



RENOVATED, EXTENDED AND MODERNISED

The property was built in 1871 and comprises the main house, a foaling box which is now an office and kitchenette, a barn, two carports, a large driveway providing parking for many vehicles, electric security gates and pedestrian access.



Local Authority: Bracknell Forest Borough Council

Council Tax band: F

Furniture: Furnished

Minimum length of tenancy: Available for both long and short lets

Deposit amount: £9,692.30

Available date: 1st February 2026

Guide Price: £7,000 (Long Let) or £9,000 (Short Let) per month



REFINED COMFORT FOR FAMILIES

The house is set in a plot of just over one third of an acre and enclosed by an outer walled garden, and an inner walled garden surrounding the central courtyard. The stunning private garden has a formal area at the rear with a small greenhouse and a large fig tree, an orchard with apple, pear and plum trees, and a rose arch which leads from the orchard to the main garden. The property is located directly opposite Lambrook school. The wonderful open plan kitchen dining/sitting room has two sets of bifold doors that open into the central courtyard. Also on the ground floor is an open study/playroom, a WC, utility room, living room/snug, entrance hall, and a large main living room and games room with access to the courtyard. A veranda provides an additional covered outdoor seating area with lovely views over the garden. On the second floor there are four bedrooms, two with wet room ensuites, and two sharing a glorious principal bathroom.









A SUPERBLY LOCATED FAMILY HOME

Winkfield Row offers a prime location near Ascot with easy access to local amenities. The property is situated opposite the prestigious Lambrook private school, and just 0.5 miles from Winkfield Row Primary School, making morning drop-offs convenient for families. For shopping needs, both Ascot and Bracknell Town Centres are 2 miles away, featuring a variety of high street stores, restaurants, and cafes. Nature enthusiasts will appreciate wonderful walks in the vicinity in Swinley Forest, Windsor Great Park and Virginia Water lake and Savill Gardens. The nearby Jubilee River Park, only 0.8 miles from the house, perfect for weekend walks and outdoor activities.

Commuters benefit from excellent transport links, with Ascot Railway Station located 3 miles away, providing regular services to London and other major destinations. Additionally, the M4 and M25 motorways are easily accessible, ensuring swift journeys for those traveling by car. Healthcare facilities are well-represented, with Riverside Medical Centre just 0.6 miles from the property.





Grove Lane, Winkfield Row, Bracknell

Approximate Area = 3249 sq ft / 301.8 sq m (excludes carport)

Outbuildings = 909 sq ft / 84.4 sq m

Total = 4158 sq ft / 386.2 sq m

For identification only - Not to scale



CARPORT / OUTBUILDING 1 / 2



GROUND FLOOR



FIRST FLOOR

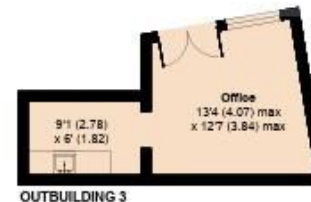

OUTBUILDING 3



Floor plan produced in accordance with RICS Property Measurement 2nd Edition, Incorporating International Property Measurement Standards (IPMS2 Residential). © nichicom 2025. Produced for Knight Frank LLP. REF: 1316833

(Including Basement / Loft Room)

Approximate Gross Internal Area = 4,158 sq ft

This plan is for layout guidance only. Not drawn to scale unless stated. Windows and door openings are approximate. Whilst every care is taken in the preparation of this plan, please check all dimensions, shapes and compass bearings before making any decisions reliant upon them. (ID767266)



Katie Green

01344 293156

katie.green@knightfrank.com

Knight Frank Ascot

59 High Street

SL5 7HP

knightfrank.co.uk

Your partners in property

1. Particulars: These particulars are not an offer or contract, nor part of one. You should not rely on statements given by Knight Frank in the particulars, by word of mouth or in writing ("information") as being factually accurate about the property, its condition or its value. Neither Knight Frank nor any joint agent has any authority to make any representations about the property, and accordingly any information given is entirely without responsibility on the part of Knight Frank. 2. Material Information: Please note that the material information above is provided to Knight Frank by third parties and is provided here as a guide only. Some of the information provided (such as the rent, deposit or length of tenancy) is subject to change, depending on offers received by the landlord. While Knight Frank has taken steps to verify this information, we advise you to confirm the details of any such material information prior to any offer for the tenancy being submitted. If we are informed of changes to this information by the landlord, we will use reasonable endeavours to update this as soon as practical. 3. Photos, Videos etc: The photographs, property videos and virtual viewings etc. show only certain parts of the property as they appeared at the time they were taken. Areas, measurements and distances given are approximate only. 4. Fixtures and fittings: Carpets, curtains, light fittings and other items fixed to the property (and not fixed to the property) belonging to the landlord are included in any tenancy as evidenced in the inventory, unless specifically noted otherwise. All those items regarded as tenant's fixtures and fittings, are specifically excluded from any tenancy and will not be evidenced in the inventory. 5. Deposit: All potential tenants should be advised that, as well as rent a holding deposit will be payable which is equal to one week's rent (if an AST) and two weeks' rent (if not an AST), a tenancy deposit will also be payable which is equal to 6 weeks rent (if not an AST and/or the annual rent is over £50,000), or 5 weeks' rent (if an AST and/or the annual rent is below £50,000). If the landlord agrees to you having a pet you may be required to pay a higher deposit (if not an AST) or higher weekly rent (if an AST). An administration fee of £288 and referencing fees of £60 per person will also apply when renting a property (if not an AST). (All fees shown are inclusive of VAT.) For other fees that might apply, please ask us or visit www.knightfrank.co.uk/tenantfees. 6. To find out how we process Personal Data, please refer to our Group Privacy Statement and other notices at <https://www.knightfrank.com/legals/privacy-statement>.

Particulars dated <Particularsdate>. Photographs and videos dated <Photosdate>. All information is correct at the time of going to print. Knight Frank is the trading name of Knight Frank LLP. Knight Frank LLP is a limited liability partnership registered in England and Wales with registered number OC305934. Our registered office is at 55 Baker Street, London W1U 8AN. We use the term 'partner' to refer to a member of Knight Frank LLP, or an employee or consultant. A list of members names of Knight Frank LLP may be inspected at our registered office. If you do not want us to contact you further about our services then please contact us by either calling 020 3544 0692, email to marketing.help@knightfrank.com or post to our UK Residential Marketing Manager at our registered office (above) providing your name and address.

