



The Tower, One St George Wharf, Nine Elms SW8

---



# The Tower, One St George Wharf, Nine Elms SW8

Set on the fifth floor of one of the most sought-after residential developments in South West London with excellent views of the River Thames. The accommodation consists of three double bedrooms, which all feature smart built-in storage. The principal bedroom benefits from a large en suite bathroom with a bath, shower and double sinks. The kitchen is fully fitted with high-end appliances and a plethora of wall and base storage units. The lounge is large enough to accommodate entertaining and benefits from amazing views through the large floor-to-ceiling windows.

The Tower is a highly luxurious development which features unrivalled amenities such as a spa, swimming pool, fully equipped gym, and cinema room as well as a private entertaining lounge and cinema for residents.



**Guide price:** £2,500,000

**Tenure:** Leasehold: approximately 989 years remaining

**Service charge:** £28,105.92 per annum, reviewed annually

**Ground rent:** £0 per annum, reviewed yearly

**Local authority:** London Borough of Lambeth

**Council tax band:** H

The concierge is on hand 24 hours a day to cater to the needs of residents as well.

## Location

The Tower, One St George Wharf is situated on Nine Elms lane and is the pinnacle of the development St George Wharf. Vauxhall station (Zone 1, Victoria line) is 0.2 miles away, whilst purchasers will also benefit from being walking distance to the newly opened Battersea Power Station and the various shops, bars and restaurants on offer there. The Thames Clippers runs services into the City from St George Wharf Pier, offering a slightly more refined way to commute. All times and distances are approximate.





An impressive apartment with stunning river views.

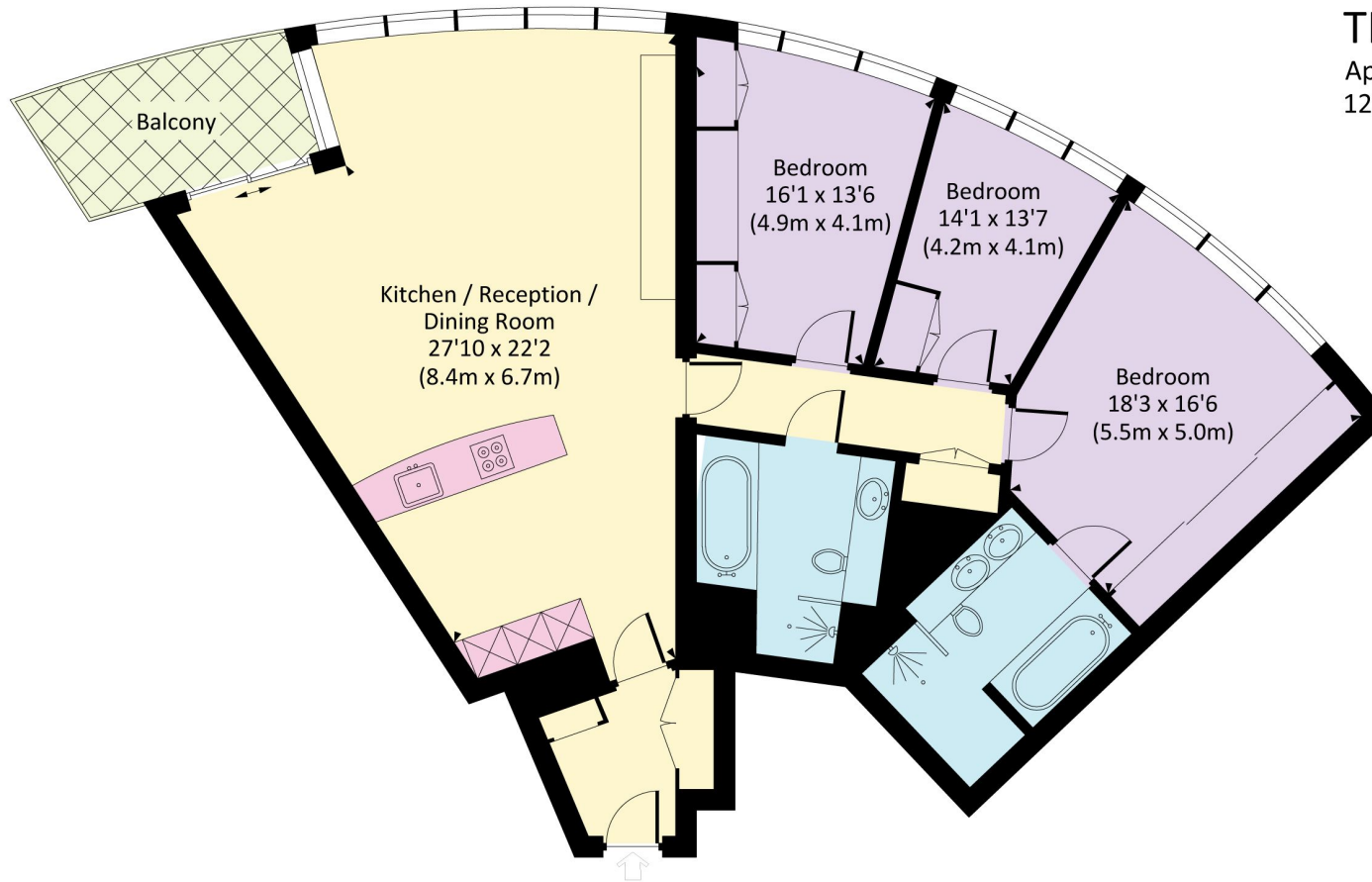

# THE TOWER, SW8

Approx. gross internal area  
1278 Sq Ft. / 118.7 Sq M.



FIFTH FLOOR

This plan is for guidance only and must not be relied upon as a statement of fact. Attention is drawn to the important notice on the last page of the text of the Particulars.



All measurements have been made in accordance with RICS code of Measuring Practice which are approximate only and only for illustrative purposes. For the avoidance of doubt, Dowling Jones Design shall not be liable for any reliance on these measurements. © 2023 www.dowlingjones.com 020 7610 9933

**Knight Frank**

London

346 Queenstown Road

London

SW11 8BY

[knightfrank.co.uk](http://knightfrank.co.uk)

We would be delighted to tell you more

Sian-Louise Tangney

+44 20 3866 2938

[sianlouise.tangney@knightfrank.com](mailto:sianlouise.tangney@knightfrank.com)



Fixtures and fittings: A list of the fitted carpets, curtains, light fittings and other items fixed to the property which are included in the sale (or may be available by separate negotiation) will be provided by the Seller's Solicitors.

Important Notice: 1. Particulars: These particulars are not an offer or contract, nor part of one. You should not rely on statements by Knight Frank LLP in the particulars or by word of mouth or in writing ("information") as being factually accurate about the property, its condition or its value. Neither Knight Frank LLP nor any joint agent has any authority to make any representations about the property, and accordingly any information given is entirely without responsibility on the part of the agents, seller(s) or lessor(s). 2. Photos, Videos etc: The photographs, property videos and virtual viewings etc. show only certain parts of the property as they appeared at the time they were taken. Areas, measurements and distances given are approximate only. 3. Regulations etc: Any reference to alterations to, or use of, any part of the property does not mean that any necessary planning, building regulations or other consent has been obtained. A buyer or lessee must find out by inspection or in other ways that these matters have been properly dealt with and that all information is correct. 4. VAT: The VAT position relating to the property may change without notice. 5. To find out how we process Personal Data, please refer to our Group Privacy Statement and other notices at <https://www.knightfrank.com/legals/privacy-statement>.

Particulars dated March 2023. Photographs and videos dated March 2023.

All information is correct at the time of going to print. Knight Frank is the trading name of Knight Frank LLP. Knight Frank LLP is a limited liability partnership registered in England and Wales with registered number OC305934. Our registered office is at 55 Baker Street, London W1U 8AN. We use the term 'partner' to refer to a member of Knight Frank LLP, or an employee or consultant. A list of members names of Knight Frank LLP may be inspected at our registered office. If you do not want us to contact you further about our services then please contact us by either calling 020 3544 0692, email to [marketing.help@knightfrank.com](mailto:marketing.help@knightfrank.com) or post to our UK Residential Marketing Manager at our registered office (above) providing your name and address.