



Howard Building, Chelsea Bridge Wharf SW11



# Howard Building, Battersea SW11

This exceptional two double bedroom property is arranged over the fifth floor of a contemporary development next to the river. The current owners have refurbished the apartment throughout with great attention to detail to create a stylish, yet practical home.

The open-plan kitchen living room is a fabulous space for entertaining; there is a fully integrated kitchen with a breakfast bar, wood flooring, and this room opens out to a south-west facing balcony which boasts views of the River Thames. There are two double bedrooms, one of which benefits from having a walk-in wardrobe and an en-suite bathroom, and there is a separate shower room. Both bedrooms have superb views of the River Thames, Battersea Power Station and the Shard.



**Guide price:** £950,000

**Tenure:** Leasehold: approximately 975 years remaining

**Service charge:** £7,035 per annum, reviewed yearly, next review due 2024

**Ground rent:** £500 per annum, reviewed yearly, next review due 2024

**Local authority:** London Borough of Wandsworth

**Council tax band:** F

## Location

Chelsea Bridge Wharf is located on the south side of the River Thames, right next to Chelsea Bridge. The beautiful Battersea Park is located within 50 yards from the ground floor of the Howard Building. The Battersea Power Station development is within 100 away, benefiting from new shopping, restaurants & further amenities as well as a new extension to the Northern Line. Sloane Square underground station (Circle and District lines, zone 1), Queenstown Road and Battersea Park rail station for quick links to Waterloo are within walking distance. Buses run regularly just outside the development. The location is also very convenient for shops and restaurants of Chelsea and Knightsbridge.





A beautiful  
apartment next to  
the river in Chelsea  
Bridge Wharf, SW11.

Key :  
CH - Ceiling Height

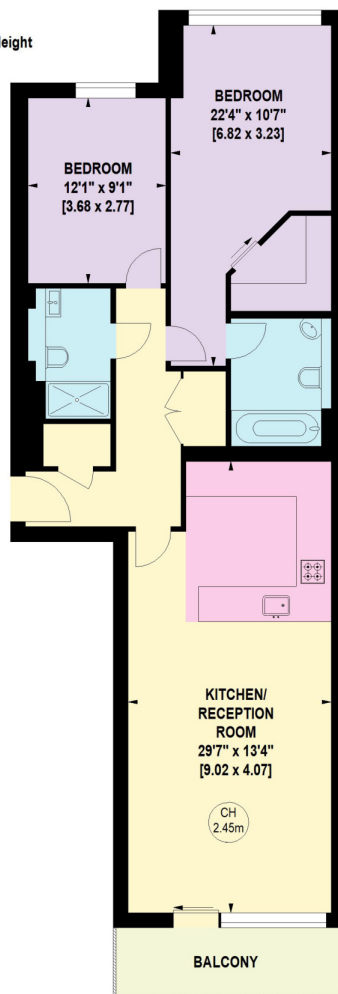

FIFTH FLOOR

## HOWARD BUILDING

Approximate Gross Internal Area : 87.23 Sq. metres  
939 Sq. feet

**Knight Frank**

**Battersea & Riverside Sales**

346 Queenstown Road

London

SW11 8BY

[knightfrank.co.uk](https://www.knightfrank.co.uk)

**We would be delighted to tell you more**

**Sian-Louise Tangney**

020 3866 2938

[sianlouise.tangney@knightfrank.com](mailto:sianlouise.tangney@knightfrank.com)

This plan is for guidance only and must not be relied upon as a statement of fact. Attention is drawn to the important notice on the last page of the text of the Particulars.



Fixtures and fittings: A list of the fitted carpets, curtains, light fittings and other items fixed to the property which are included in the sale (or may be available by separate negotiation) will be provided by the Seller's Solicitors.

Important Notice: 1. Particulars: These particulars are not an offer or contract, nor part of one. You should not rely on statements by Knight Frank LLP in the particulars or by word of mouth or in writing ("information") as being factually accurate about the property, its condition or its value. Neither Knight Frank LLP nor any joint agent has any authority to make any representations about the property, and accordingly any information given is entirely without responsibility on the part of the agents, seller(s) or lessor(s). 2. Photos, Videos etc: The photographs, property videos and virtual viewings etc. show only certain parts of the property as they appeared at the time they were taken. Areas, measurements and distances given are approximate only. 3. Regulations etc: Any reference to alterations to, or use of, any part of the property does not mean that any necessary planning, building regulations or other consent has been obtained. A buyer or lessee must find out by inspection or in other ways that these matters have been properly dealt with and that all information is correct. 4. VAT: The VAT position relating to the property may change without notice. 5. To find out how we process Personal Data, please refer to our Group Privacy Statement and other notices at <https://www.knightfrank.com/legals/privacy-statement>.

Particulars dated September 2023. Photographs and videos dated September 2023.

All information is correct at the time of going to print. Knight Frank is the trading name of Knight Frank LLP. Knight Frank LLP is a limited liability partnership registered in England and Wales with registered number OC305934. Our registered office is at 55 Baker Street, London W1U 8AN. We use the term 'partner' to refer to a member of Knight Frank LLP, or an employee or consultant. A list of members names of Knight Frank LLP may be inspected at our registered office. If you do not want us to contact you further about our services then please contact us by either calling 020 3544 0692, email to [marketing.help@knightfrank.com](mailto:marketing.help@knightfrank.com) or post to our UK Residential Marketing Manager at our registered office (above) providing your name and address.