



Alder House, Electric Boulevard, London SW11

---



# Electric Boulevard, London SW11

---

Located on the 10th floor of the prestigious Alder House, this exceptional three-bedroom lateral apartment offers contemporary luxury living with breath-taking views of the iconic Battersea Power Station. Boasting an expansive open-plan layout, this stylish apartment is designed to maximize both space and natural light. The modern kitchen, complete with high-end integrated appliances and sleek cabinetry, seamlessly connects to the spacious living and dining area, perfect for entertaining or relaxing while enjoying the stunning cityscape.



**Guide price:** £2,250,000

**Tenure:** Leasehold: approximately 987 years remaining

**Service charge:** £13,000 per annum, reviewed every year, next review due 2025

**Ground rent:** £850 per annum, reviewed every year, next review due 2025

**Local authority:** London Borough of Wandsworth

**Council tax band:** G





Large floor-to-ceiling windows throughout the property frame the panoramic views of Battersea Power Station, creating a unique backdrop and allowing natural light to flood the interior. The private winter garden, accessible from the living area, provides an ideal spot to simply soak in the vistas.

The property features three generously-sized bedrooms, each designed with comfort in mind. The principal bedroom includes a luxurious en-suite bathroom, while the remaining two bedrooms offer ample storage and share a well-appointed family bathroom, complete with modern fixtures and finishes.





## Alder House, SW11

**Approximate Gross Internal Floor Area  
130.7 sq m / 1407 sq ft**

This plan is for guidance only and must not be relied upon as a statement of fact. Attention is drawn to the important notice on the last page of the text of the Particulars.

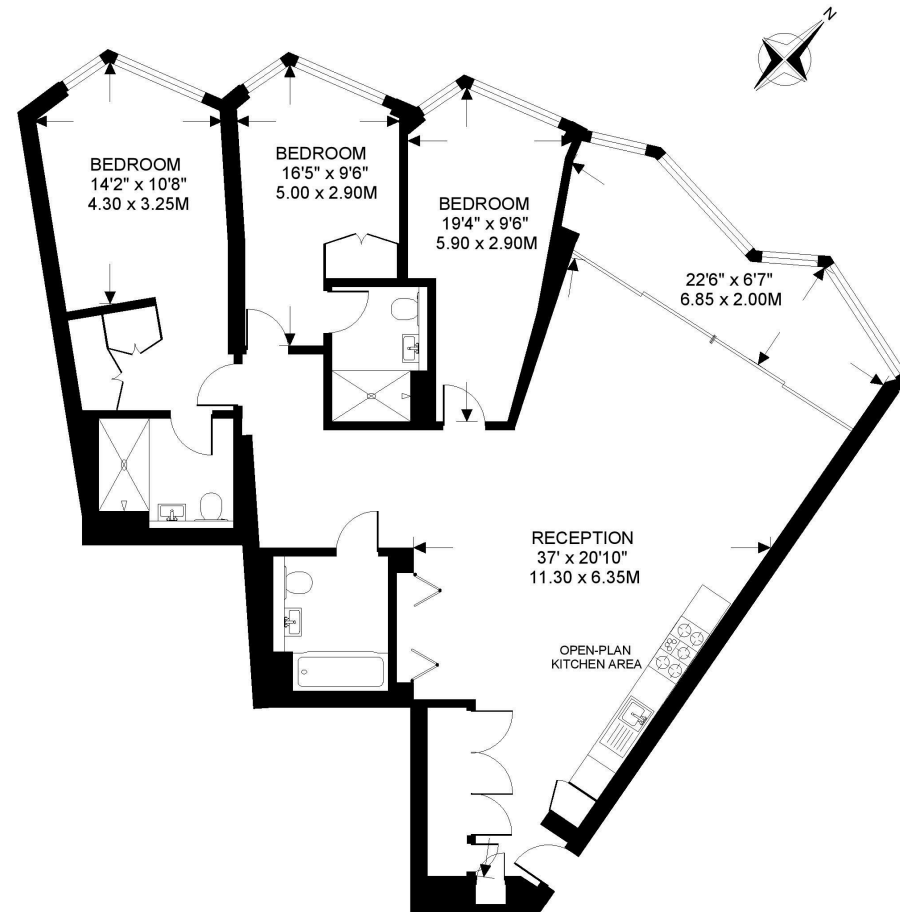

TENTH FLOOR

**Knight Frank**

**Battersea & Riverside**

346 Queenstown Road

London

SW11 8BY

[knightfrank.co.uk](https://www.knightfrank.co.uk)

We would be delighted to tell you more

**Sarah Gerrett**

020 3866 2924

[sarah.gerrett@knightfrank.com](mailto:sarah.gerrett@knightfrank.com)



Fixtures and fittings: A list of the fitted carpets, curtains, light fittings and other items fixed to the property which are included in the sale (or may be available by separate negotiation) will be provided by the Seller's Solicitors.

Important Notice: 1. Particulars: These particulars are not an offer or contract, nor part of one. You should not rely on statements by Knight Frank LLP in the particulars or by word of mouth or in writing ("Information") as being factually accurate about the property, its condition or its value. Neither Knight Frank LLP nor any joint agent has any authority to make any representations about the property, and accordingly any information given is entirely without responsibility on the part of the agents, seller(s) or lessor(s). 2. Photos, Videos etc: The photographs, property videos and virtual viewings etc. show only certain parts of the property as they appeared at the time they were taken. Areas, measurements and distances given are approximate only. 3. Regulations etc: Any reference to alterations to, or use of, any part of the property does not mean that any necessary planning, building regulations or other consent has been obtained. A buyer or lessee must find out by inspection or in other ways that these matters have been properly dealt with and that all information is correct. 4. VAT: The VAT position relating to the property may change without notice. 5. To find out how we process Personal Data, please refer to our Group Privacy Statement and other notices at <https://www.knightfrank.com/legals/privacy-statement>.

Particulars dated October 2024. Photographs and videos dated October 2024.

Knight Frank is the trading name of Knight Frank LLP. Knight Frank LLP is a limited liability partnership registered in England and Wales with registered number OC305934. Our registered office is at 55 Baker Street, London W1U 8AN where you may look at a list of members' names. If we use the term 'partner' when referring to one of our representatives, that person will either be a member, employee, worker or consultant of Knight Frank LLP and not a partner in a partnership. If you do not want us to contact you further about our services then please contact us by either calling 020 3544 0692, email to [marketing.help@knightfrank.com](mailto:marketing.help@knightfrank.com) or post to our UK Residential Marketing Manager at our registered office (above) providing your name and address.