

# THE AZTEC CENTRE



AZTEC WEST BUSINESS PARK, BS32 4TD



Photo for illustrative purposes

**PROMINENT GROUND FLOOR OFFICE SUITE**  
**2,030 SQ FT TO LET**

Situated at the The Aztec  
Centre, at the front of  
Bristol's Premier Business  
Park next to J16 of the M5

## AZTEC WEST OFFERS A WIDE RANGE OF ON-SITE AMENITIES WITH STAFF HEALTH AND WELLBEING IN MIND.

### The Aztec Centre Amenities

- Morrisons Daily convenience store and newsagent
- Car charging points
- Metro bus stops
- Allocated on-site parking based on a ratio of 1:250 sq ft.

### Aztec West Amenities

- Aztec Spa Health & Fitness Club
- The Thornbury Deli
- Kitchen Coffee Social
- Curious Kitchen
- Black Sheep Bar and Kitchen
- Mr Tacos
- Hotels
- Nurseries

### Ground floor availability:

Unit 8	2,030 SQ FT
--------	-------------

### Specification:

- Highly prominent office suite
- Excellent natural light
- Suspended ceilings with LED lighting
- Under floor trunking
- New carpets

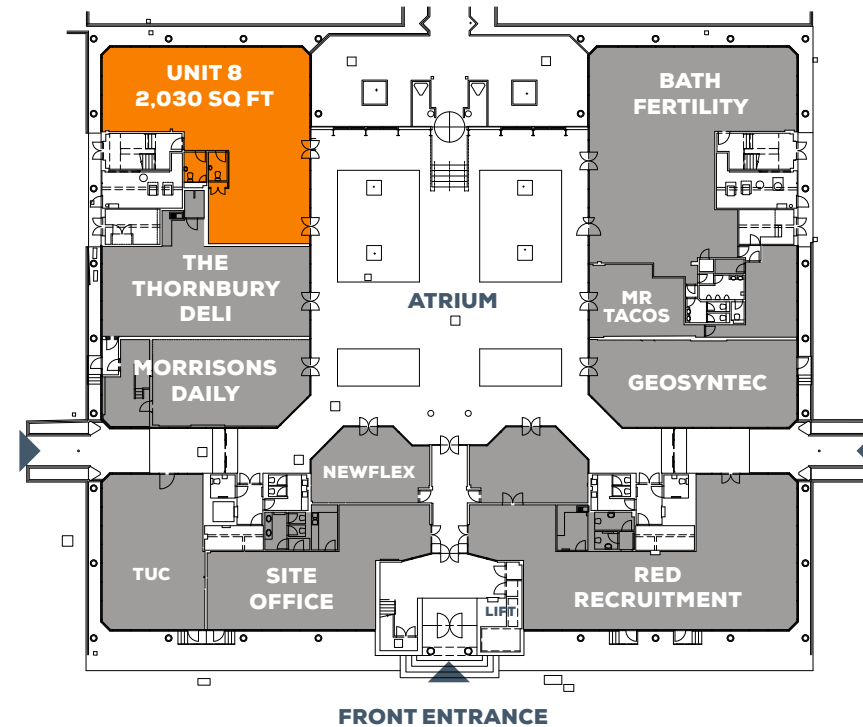

Easy access to the M5 & the M4/M5 Interchange

Regular bus stops around the park

Part of the National Cycle Network

Dedicated footpaths



SAT NAV: BS32 4TD

**Tenure** The office is available on a new effective full repairing & insuring lease by way of a service charge for a term to be agreed. Service charge details are available from the agents.

**Legal Costs** Each party to bear their own legal costs incurred in the transaction.

**Rent** On application.

**Business Rates** Interested parties are advised to make their own enquiries with the local billing authority as to the exact rates liability for the suite.

**Service Charge** A service charge will be applicable.

**EPC** The Aztec Centre has an energy performance rating of D92.

**Anti-Money Laundering** The occupier will be required to submit documentation to satisfy anti-money laundering regulations.

**Viewing** Please contact the joint sole agents for further information or to make arrangements to view.

**CBRE**

**Knight Frank**

**RICHARD KIDD**  
Richard.Kidd@cbre.com  
07827 230 295

**ANDY SMITH**  
Andy.Smith@knightfrank.com  
07443 983 253

**ALEX HAYMAN**  
Alex.Hayman@cbre.com  
07827 252 847

**POLLY SMART**  
Polly.Smart@knightfrank.com  
07929 673 626

CBRE, Inc. This information has been obtained from sources believed reliable. We have not verified it and make no guarantee, warranty or representation about it. Any projections, opinions, assumptions or estimates used are for example only and do not represent the current or future performance of the property. You and your advisors should conduct a careful, independent investigation of the property to determine to your satisfaction the suitability of the property for your needs. Photos herein are the property of their respective owners and use of these images without the express written consent of the owner is prohibited. SEPTEMBER 2024