

Eaton Place, Belgravia SW1X

---



# Eaton Place

## Belgravia **SW1X**

Eaton Place is a residential street in Belgravia comprising 104 mainly white stucco fronted buildings arranged as flats. This apartment is located at the favoured Western end of the street close to Sloane Square, The Kings Road and, Sloane Street. The internationally renowned shops can be found in Knightsbridge, and Hyde Park is close by.



**Guide price:** £7,250,000

**Tenure:** Leasehold: approximately 124 years remaining

**Service charge:** £9,171.67 per annum, reviewed every year, next review due 2025

**Ground rent:** Peppercorn

**Local authority:** Royal Borough of Kensington & Chelsea

**Council tax band:** H



Arranged over the ground and lower ground floor of a White stucco fronted building in Belgravia, this apartment has been recently refurbished by prestigious developers Residence One and is presented in immaculate condition throughout. Held on a lease with approximately 124 years remaining and covering 2,555 square feet (excluding vaults) accommodation benefits from air conditioning and underfloor heating throughout and with bespoke kitchen, bathrooms and, interior design. The reception room and dining room on the ground floor both benefit from superb proportions with ceiling height in excess of 3.6 meters. All the bedrooms have air conditioning and en-suite bathrooms, and the conservatory has a retractable glass roof providing a space which can be used all year round. This really is an exceptional apartment presented in immaculate condition.





This plan is for guidance only and must not be relied upon as a statement of fact. Attention is drawn to the important notice on the last page of the text of the Particulars.

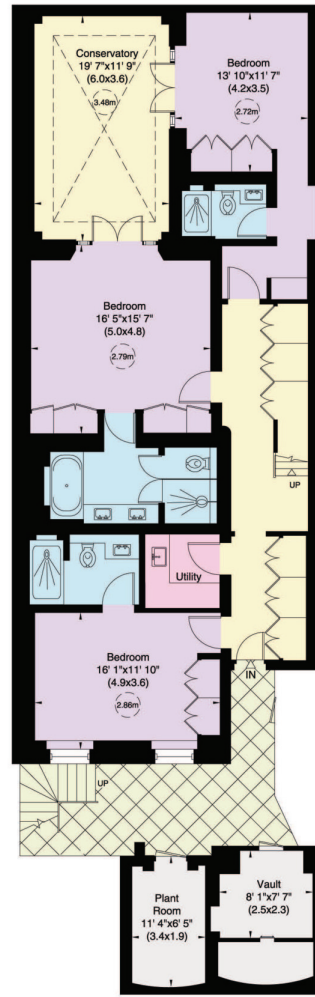

Lower Ground Floor

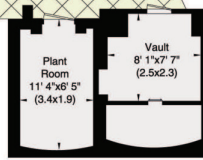

Ground Floor

### Eaton Place, SW1

Approximate Gross Internal Area  
 252 sq m/ 2714 sq ft Including Vault and Plant Room  
 237 sq m/ 2555 sq ft Excluding Vault and Plant Room



**Knight Frank**  
 Belgravia & Westminster  
 Sales  
 47 Lower Belgrave Street  
 London SW1W 0LS  
[knightfrank.co.uk](http://knightfrank.co.uk)

We would be delighted to tell you more  
**Matthew Armstrong**  
 020 7881 7728  
[matthew.armstrong@knightfrank.com](mailto:matthew.armstrong@knightfrank.com)



Fixtures and fittings: A list of the fitted carpets, curtains, light fittings and other items fixed to the property which are included in the sale (or may be available by separate negotiation) will be provided by the Seller's Solicitors.

Important Notice: 1. Particulars: These particulars are not an offer or contract, nor part of one. You should not rely on statements by Knight Frank LLP in the particulars or by word of mouth or in writing ("information") as being factually accurate about the property, its condition or its value. Neither Knight Frank LLP nor any joint agent has any authority to make any representations about the property, and accordingly any information given is entirely without responsibility on the part of the agents, seller(s) or lessor(s). 2. Photos, Videos etc: The photographs, property videos and virtual viewings etc. show only certain parts of the property as they appeared at the time they were taken. Areas, measurements and distances given are approximate only. 3. Regulations etc: Any reference to alterations to, or use of, any part of the property does not mean that any necessary planning, building regulations or other consent has been obtained. A buyer or lessee must find out by inspection or in other ways that these matters have been properly dealt with and that all information is correct. 4. VAT: The VAT position relating to the property may change without notice. 5. To find out how we process Personal Data, please refer to our Group Privacy Statement and other notices at <https://www.knightfrank.com/legals/privacy-statement>. Particulars dated November 2024. Photographs and videos dated October 2024.

Knight Frank is the trading name of Knight Frank LLP. Knight Frank LLP is a limited liability partnership registered in England and Wales with registered number OC305934. Our registered office is at 55 Baker Street, London W1U 8AN where you may look at a list of members' names. If we use the term 'partner' when referring to one of our representatives, that person will either be a member, employee, worker or consultant of Knight Frank LLP and not a partner in a partnership. If you do not want us to contact you further about our services then please contact us by either calling 020 3544 0692, email to [marketing.help@knightfrank.com](mailto:marketing.help@knightfrank.com) or post to our UK Residential Marketing Manager at our registered office (above) providing your name and address.