



Primrose House, Bridge Approach NW3



Primrose House, Bridge Approach, NW3

A bright two bedroom one bathroom apartment with a balcony and parking located moments from Primrose Hill and Chalk Farm.

This fantastic second floor apartment has modern interiors throughout and is located within a small and well maintained purpose built block. There is a spacious open plan reception room with a balcony and fully integrated kitchen, two good sized bedrooms and a family bathroom. Additional benefits include one parking space, Share of the Freehold and ample storage.



Guide price

Available upon request

Tenure

Share of Freehold

Local authority

London Borough of Camden

Primrose House is located moments from the amenities in Primrose Hill and Camden as well as Chalk Farm Station (Northern Line).





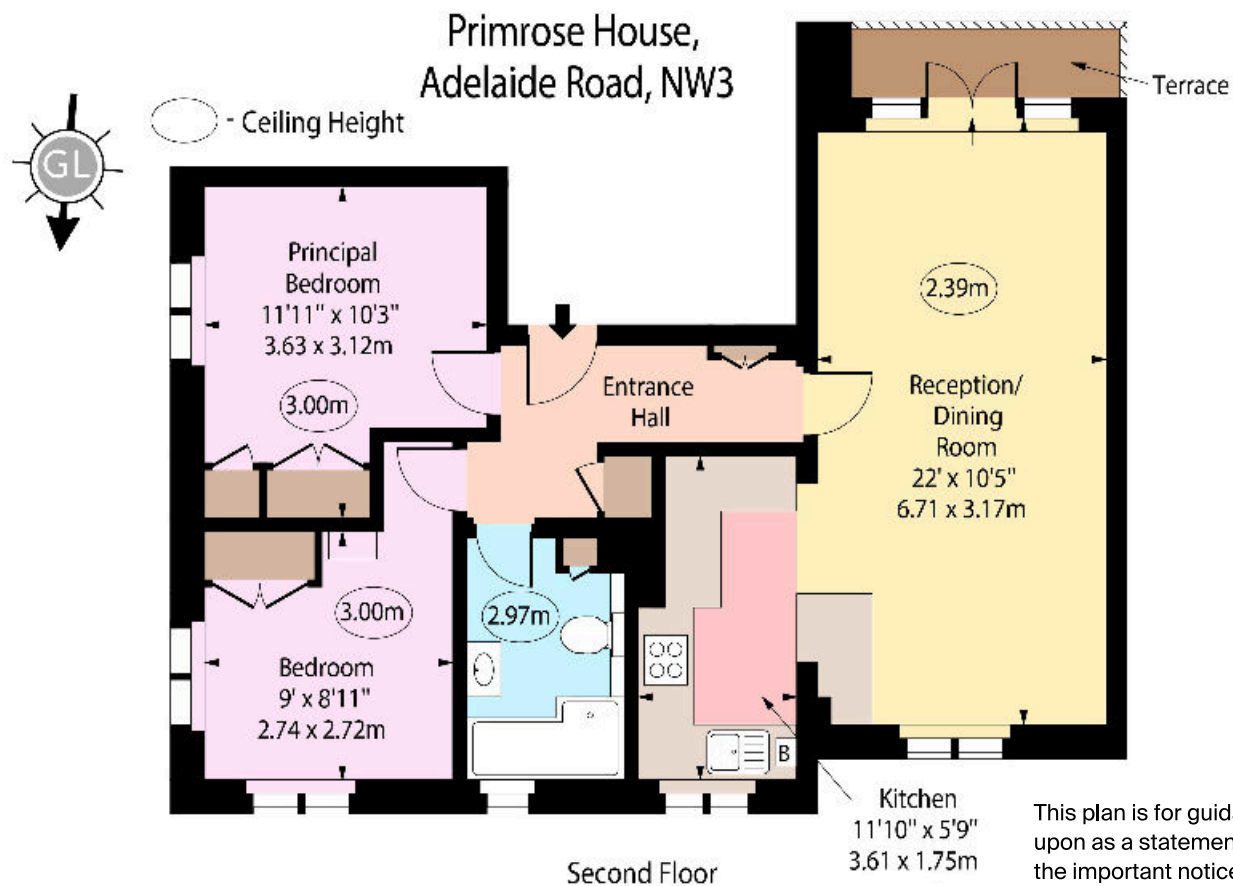

**Approximate Gross Internal Floor Area
59 sq m / 638 sq ft**

This plan is for guidance only and must not be relied upon as a statement of fact. Attention is drawn to the important notice on the last page of the text of the Particulars.

Knight Frank
Belsize Park
2C England's Ln
Belsize Park
NW3 4TG
[knightfrank.co.uk](https://www.knightfrank.co.uk)

We would be delighted to tell you more
Orly Lehmann
020 3815 3350
orly.lehmann@knightfrank.com



Fixtures and fittings: A list of the fitted carpets, curtains, light fittings and other items fixed to the property which are included in the sale (or may be available by separate negotiation) will be provided by the Seller's Solicitors.

Important Notice: 1. Particulars: These particulars are not an offer or contract, nor part of one. You should not rely on statements by Knight Frank LLP in the particulars or by word of mouth or in writing ("information") as being factually accurate about the property, its condition or its value. Neither Knight Frank LLP nor any joint agent has any authority to make any representations about the property, and accordingly any information given is entirely without responsibility on the part of the agents, seller(s) or lessor(s). 2. Photos, Videos etc: The photographs, property videos and virtual viewings etc. show only certain parts of the property as they appeared at the time they were taken. Areas, measurements and distances given are approximate only. 3. Regulations etc: Any reference to alterations to, or use of, any part of the property does not mean that any necessary planning, building regulations or other consent has been obtained. A buyer or lessee must find out by inspection or in other ways that these matters have been properly dealt with and that all information is correct. 4. VAT: The VAT position relating to the property may change without notice. 5. To find out how we process Personal Data, please refer to our Group Privacy Statement and other notices at <https://www.knightfrank.com/legals/privacy-statement>. Particulars dated May 2022. Photographs and videos dated May 2022.

Knight Frank is the trading name of Knight Frank LLP. Knight Frank LLP is a limited liability partnership registered in England and Wales with registered number OC305934. Our registered office is at 55 Baker Street, London W1U 8AN where you may look at a list of members' names. If we use the term 'partner' when referring to one of our representatives, that person will either be a member, employee, worker or consultant of Knight Frank LLP and not a partner in a partnership. If you do not want us to contact you further about our services then please contact us by either calling 020 3544 0692, email to marketing.help@knightfrank.com or post to our UK Residential Marketing Manager at our registered office (above) providing your name and address.