

Apartment 13, 13 Milsom Street Bath

BAI





Contemporary internal elegance.



Situated in the heart of the UNESCO world heritage city of Bath in one of the principle shopping areas of the city. This fashionable street benefits from being home to an array of designer retailers and popular restaurants which cater for a variety of styles and tastes. Bath Spa train station is approximately 0.4 miles from the development and provides a regular half hourly train service into central London with journey times approximately 1hr and 30 minutes. As you would expect there are also a range of amenities including supermarkets, cafes and a plethora of independent retailers.



Apartment 13, Milsom Apartments, 13 Milsom Street, Bath, BA1 1DE

Approximate Floor Area 47.1 sq m / 507 sq ft
Including Limited Use Area (3.3 sq m / 35 sq ft)

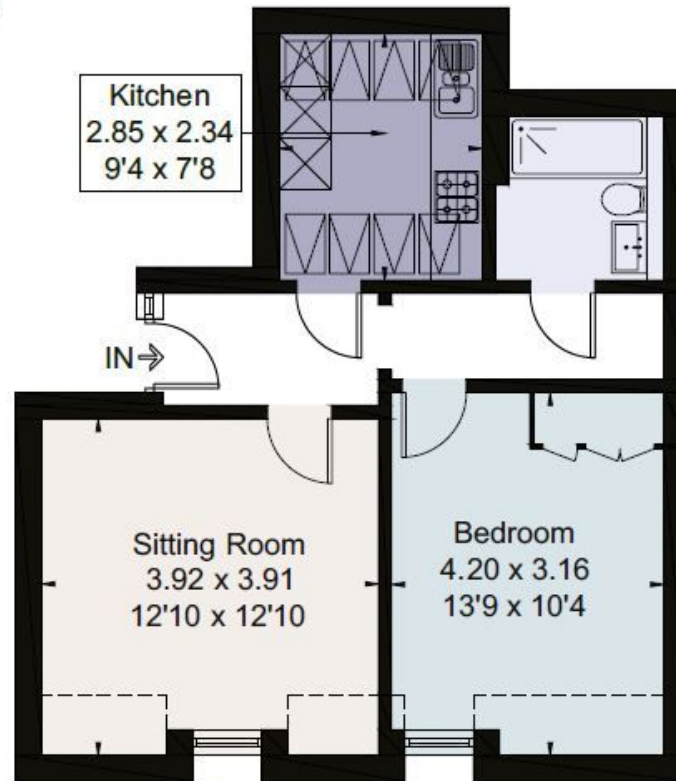

Apartment 13

This plan is for guidance only and must not be relied upon as a statement of fact, Attention is drawn to the Important Notice on the last page of the text of the Particulars

The Apartment

Milsom Apartments is a unique residential address situated within a Grade II listed building and combines a traditional georgian exterior with contemporary internal elegance. This apartment provides spacious accommodation which includes a separate kitchen, living area and large double bedroom with views over Milsom Street.

Services

All mains services are connected

Tenure

Leasehold

Local Authority

Bath and North East Somerset Council - 01225 477 0000

Viewings

Strictly by appointment with the agent

Knight Frank
Bath
4 Wood Street
Bath
BA1 2JQ

[knightfrank.co.uk](https://www.knightfrank.co.uk)

I would be delighted to tell you more.

James Dredge
01225 325 996
james.dredge@knightfrank.com



Connecting people & property, perfectly.

Fixtures and fittings: A list of the fitted carpets, curtains, light fittings and other items fixed to the property which are included in the sale (or may be available by separate negotiation) will be provided by the Seller's Solicitors.

Important Notice: 1. Particulars: These particulars are not an offer or contract, nor part of one. You should not rely on statements by Knight Frank LLP in the particulars or by word of mouth or in writing ("information") as being factually accurate about the property, its condition or its value. Neither Knight Frank LLP nor any joint agent has any authority to make any representations about the property; and accordingly any information given is entirely without responsibility on the part of the agents, seller(s) or lessor(s). 2. Photos, Videos etc: The photographs, property videos and virtual viewings etc, show only certain parts of the property as they appeared at the time they were taken. Areas, measurements and distances given are approximate only. 3. Regulations etc: Any reference to alterations to, or use of, any part of the property does not mean that any necessary planning, building regulations or other consent has been obtained. A buyer or lessee must find out by inspection or in other ways that these matters have been properly dealt with and that all information is correct. 4. VAT: The VAT position relating to the property may change without notice. 5. To find out how we process Personal Data, please refer to our Group Privacy Statement and other notices at <https://www.knightfrank.com/legals/privacy-statement>.

Particulars dated [xxxxxxxx 20xx]. Photographs and videos dated [xxxxxxxx 20xx].

Knight Frank is the trading name of Knight Frank LLP. Knight Frank LLP is a limited liability partnership registered in England and Wales with registered number OC305934. Our registered office is at 55 Baker Street, London W1U 8AN where you may look at a list of members' names. If we use the term 'partner' when referring to one of our representatives, that person will either be a member, employee, worker or consultant of Knight Frank LLP and not a partner in a partnership. If you do not want us to contact you further about our services then please contact us by either calling 020 3544 0692, email to marketing.help@knightfrank.com or post to our UK Residential Marketing Manager at our registered office (above) providing your name and address.