

**UNIT 6**  
Trident Trade Park, Ocean Way, CARDIFF, CF24 5EN

**Ground Floor  
Internal Area Plan**

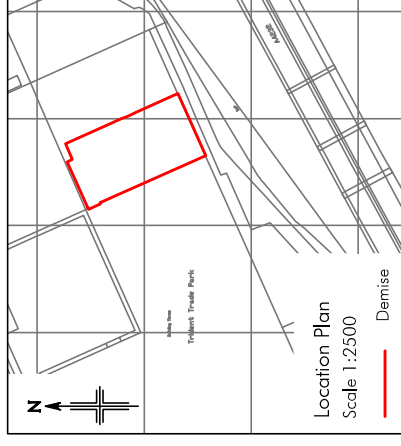

**NOTES**

This drawing complies with the 6th edition of the RICS code and is produced to an accuracy commensurate with standard presentation scales. It is held in a scaled digital CAD format.

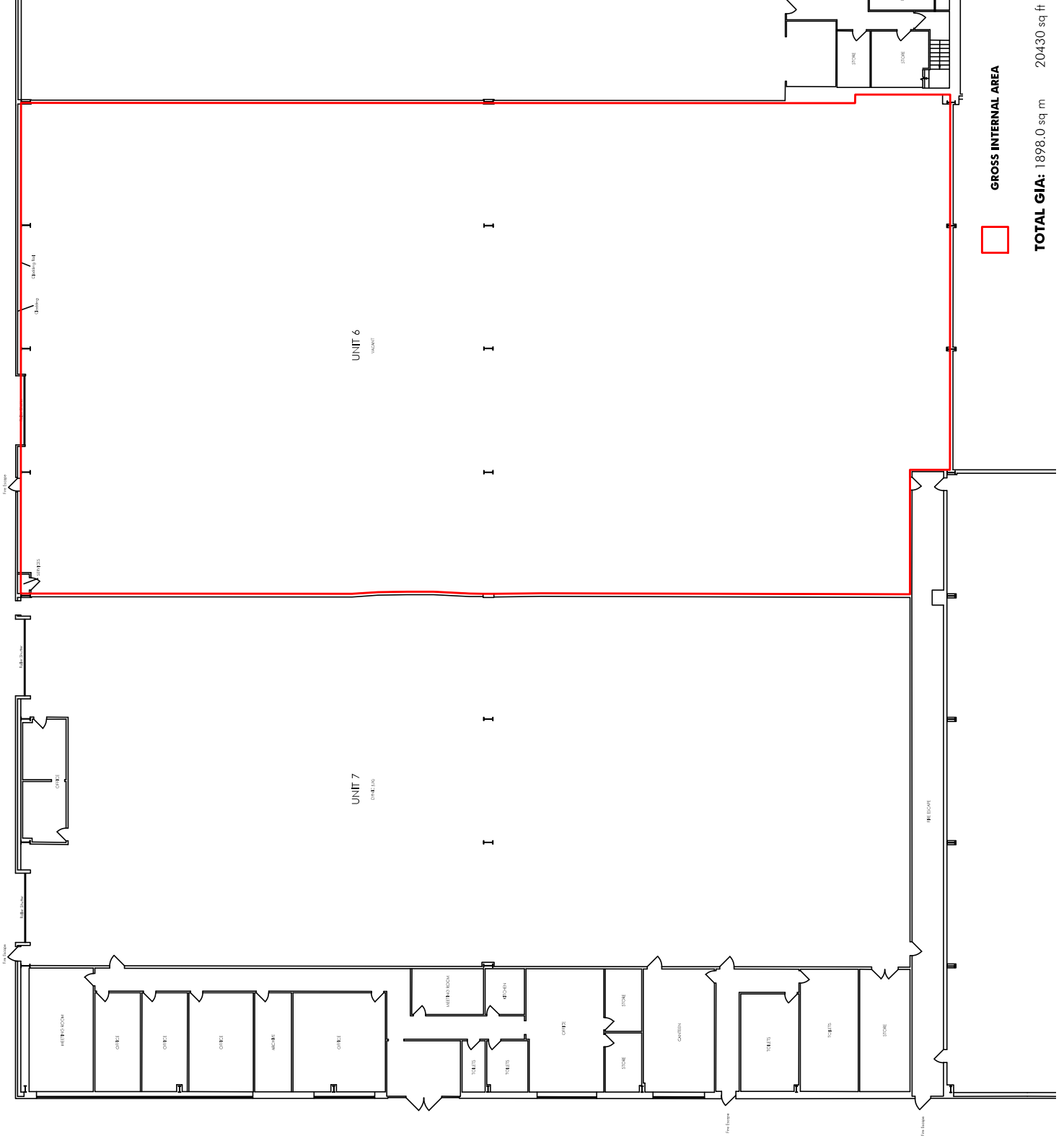

**GROSS INTERNAL AREA**

**TOTAL GIA:** 1898.0 sq m 20430 sq ft



CBRE Limited, St Martins Court, 10 Paternoster Row,  
London, EC4M 7HP  
Switchboard: 0207 182 2000 Fax: 0207 182 3007  
Web: www.cbre.com

<b>Address:</b>	Trident Trade Park	<b>Drawing:</b>	Internal Area Report
	Ocean Way Cardiff CF24 5EN		
<b>Date:</b>	23/03/2018	<b>Project No.:</b>	0257886
<b>Scale:</b>	1:250@A3	<b>Alt. Scale:</b>	N/A
<b>Drawn:</b>	AT	<b>Checked:</b>	AG
<b>Dwg. No.:</b>	257886-02-U6	<b>Rev.:</b>	A