

Connaught Street, Hyde Park W2







City of Westminster
Available furnished/unfurnished
Guide price
£445 per week



One bedroom apartment to rent in Connaught Street, Hyde Park W2.

Situated on the second floor of this Grade II listed building, this beautifully presented flat is bright with large windows filling the space with natural light.

Accommodation comprises large double bedroom, stunning contemporary bathroom, spacious reception room and a lovely eat-in kitchen with integrated appliances.

Neutrally decorated throughout, this charming apartment is available to rent, furnished, through Knight Frank Hyde Park.

Connaught Street is ideally located for the transport links at Marble Arch Underground Station (Central Line). The beautiful open spaces of Hyde Park and the wonderful shops, restaurants and caf  s of Connaught Village are within close proximity.

Connaught Street, W2

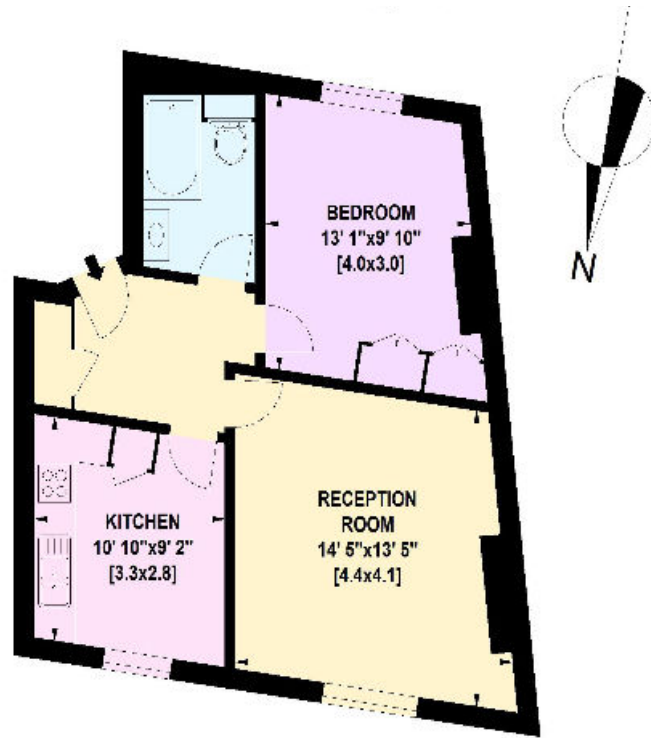

Second Floor

Approximate Gross Internal Floor Area 527 sq ft

This plan is for guidance only and must not be relied upon as a statement of fact. Attention is drawn to the Important Notice on the last page of the text of the Particulars

Tenants Fees

All potential tenants should be advised that, as well as rent and the deposit, an administration fee of £288 and referencing fees of £48 per person will apply when renting a property (if not an AST). (All fees shown are inclusive of VAT.) If the landlord agrees to you having a pet, you may be required to pay a higher deposit (if not an AST) or higher weekly rent (if an AST). Please ask us for more information about other fees that will apply or visit www.knightfrank.co.uk/tenantfees.



Knight Frank
Hyde Park
1 Craven Terrace
Hyde Park W2 3QD

Knight Frank

I would be delighted to tell you more.

Guy Spencer

guy.spencer@knightfrank.com

knightfrank.co.uk



Connecting people & property, perfectly.

Fixtures and fittings: Carpets, curtains, light fittings and other items fixed to the property (and not fixed to the property) belonging to the landlord are included in any tenancy as evidenced in the inventory, unless specifically noted otherwise. All those items regarded as tenant's fixtures and fittings, are specifically excluded from any tenancy and will not be evidenced in the inventory. Important Notice: 1. Particulars: These particulars are not an offer or contract, nor part of one. You should not rely on statements by Knight Frank LLP in the particulars or by word of mouth or in writing ("information") as being factually accurate about the property, its condition or its value. Neither Knight Frank LLP nor any joint agent has any authority to make any representations about the property, and accordingly any information given is entirely without responsibility on the part of the agents, seller(s) or lessor(s). 2. Photos, Videos etc: The photographs, property videos and virtual viewings etc. show only certain parts of the property as they appeared at the time they were taken. Areas, measurements and distances given are approximate only. 3. Regulations etc: Any reference to alterations to, or use of, any part of the property does not mean that any necessary planning, building regulations or other consent has been obtained. A buyer or lessee must find out by inspection or in other ways that these matters have been properly dealt with and that all information is correct. 4. VAT: The VAT position relating to the property may change without notice. 5. To find out how we process Personal Data, please refer to our Group Privacy Statement and other notices at <https://www.knightfrank.com/legals/privacy-statement>.

Particulars dated [March 2013]. Photographs and videos dated [March 2013].

Knight Frank is the trading name of Knight Frank LLP. Knight Frank LLP is a limited liability partnership registered in England and Wales with registered number OC305934. Our registered office is at 55 Baker Street, London W1U 8AN where you may look at a list of members' names. If we use the term 'partner' when referring to one of our representatives, that person will either be a member, employee, worker or consultant of Knight Frank LLP and not a partner in a partnership. If you do not want us to contact you further about our services then please contact us by either calling 020 3544 0692, email to marketing.help@knightfrank.com or post to our UK Residential Marketing Manager at our registered office (above) providing your name and address.