

87 Century Court, Montpellier Grove, Cheltenham



A two bedroom top floor apartment in a highly prestigious development in the heart of Montpellier.

Description

This excellent apartment occupies a particularly pleasant position within a contemporary gated development. Situated on the top floor of the southerly round tower, this is a light, bright property with lovely views from two balconies.

The accommodation, arranged around the reception hall, includes an impressive sitting room with southerly aspect over the Suffolk's and enjoys sunshine for most of the day and offers access to the 1st of the balconies.

The kitchen is smartly fitted with quality units topped with quartz work surface and integrated appliances. The master bedroom is served by a modern en-suite bathroom, there is access from the master bedroom to the second balcony overlooking the beautifully kept communal gardens. Bedroom 2, also enjoys access to this balcony and is another good double served by a modern fitted shower room.

The property is extremely practical with plenty of storage cupboards. There is allocated secure underground parking with lift access directly from the parking area to the 3rd floor. Outside, the property is approached off Montpellier Grove, via a secure gated entrance that is manned Monday to Friday by an on-site property manager responsible for taking care of the site.

The central grounds of Century Court were redesigned in 2006 by the Chelsea medal winner Peter Dowle and provide a tranquil setting within this bustling district of Cheltenham.

AGENTS NOTE - Please note, some of the marketing images have been furnished using CGI technology.





Location

Century Court is a modern gated development located between the Suffolk's and Montpellier. The area is recognised as being Cheltenham's most fashionable district and benefits from an eclectic mix of shops, restaurants, cafes, wine bars and independent boutiques and is within a comfortable stroll to two of Cheltenham's famous schools, Cheltenham College and Cheltenham Ladies' College.

Property Information

Local Authority Cheltenham Borough Council 01242 262626

Council Tax Band E

EPC C

Guide Price £575,000

Tenure Freehold



Approximate Gross Internal Floor Area

Total Area: 113.7 sq.m / 1,224 sq.ft



This plan is for guidance only and must not be relied upon as a statement of fact. Attention is drawn to the important notice on the last page of the text of the Particulars.

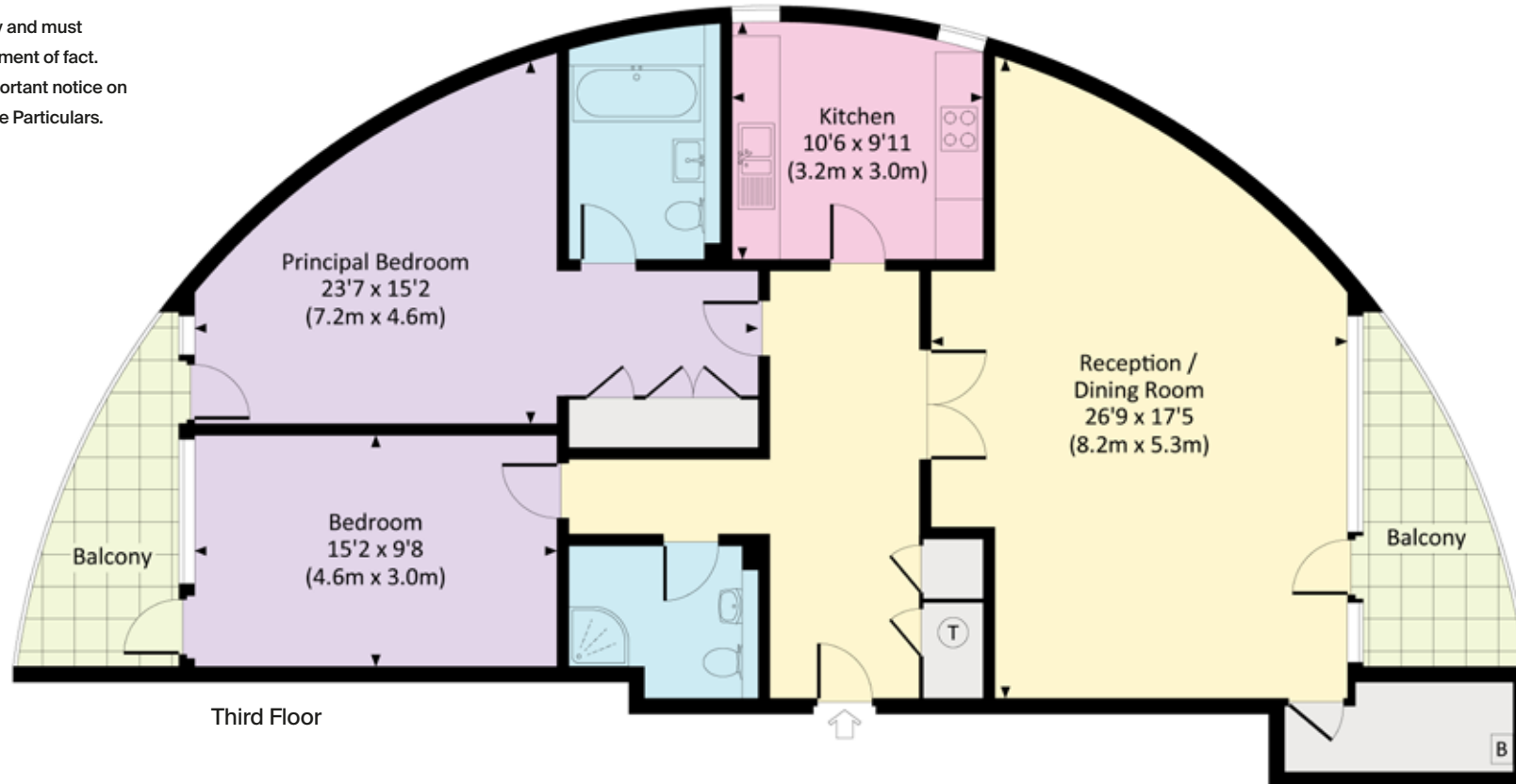

Third Floor

Knight Frank Cheltenham
123 Promenade, Cheltenham
Gloucestershire
GL50 1NW
[knightfrank.co.uk](https://www.knightfrank.co.uk)

I would be delighted to tell you more

Nick Chivers
01242 246 950
nick.chivers@knightfrank.com



Fixtures and fittings: A list of the fitted carpets, curtains, light fittings and other items fixed to the property which are included in the sale (or may be available by separate negotiation) will be provided by the Seller's Solicitors.

Important Notice: 1. Particulars: These particulars are not an offer or contract, nor part of one. You should not rely on statements by Knight Frank LLP in the particulars or by word of mouth or in writing ("information") as being factually accurate about the property, its condition or its value. Neither Knight Frank LLP nor any joint agent has any authority to make any representations about the property, and accordingly any information given is entirely without responsibility on the part of the agents, seller(s) or lessor(s). 2. Photos, Videos etc: The photographs, property videos and virtual viewings etc. show only certain parts of the property as they appeared at the time they were taken. Areas, measurements and distances given are approximate only. 3. Regulations etc: Any reference to alterations to, or use of, any part of the property does not mean that any necessary planning, building regulations or other consent has been obtained. A buyer or lessee must find out by inspection or in other ways that these matters have been properly dealt with and that all information is correct. 4. VAT: The VAT position relating to the property may change without notice. 5. To find out how we process Personal Data, please refer to our Group Privacy Statement and other notices at <https://www.knightfrank.com/legals/privacy-statement>.

Particulars dated November 2024. Photographs and videos dated November 2024.

All information is correct at the time of going to print. Knight Frank is the trading name of Knight Frank LLP. Knight Frank LLP is a limited liability partnership registered in England and Wales with registered number OC305934. Our registered office is at 55 Baker Street, London W1U 8AN. We use the term 'partner' to refer to a member of Knight Frank LLP, or an employee or consultant. A list of members names of Knight Frank LLP may be inspected at our registered office. If you do not want us to contact you further about our services then please contact us by either calling 020 3544 0692, email to marketing_help@knightfrank.com or post to our UK Residential Marketing Manager at our registered office (above) providing your name and address.