

Bourne Lane

Much Hadham

Gross Internal Area (Approx.)
Main House = 360 sq m / 3,875 sq ft
Garage = 42 sq m / 452 sq ft
Outbuildings (Excl. Log Store) = 49 sq m / 527 sq ft
Total Area = 451 sq m / 4,854 sq ft
Swimming Pool = 48 sq m / 516 sq ft

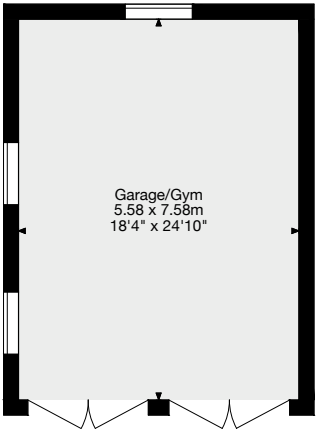
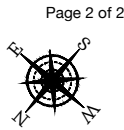

Garage

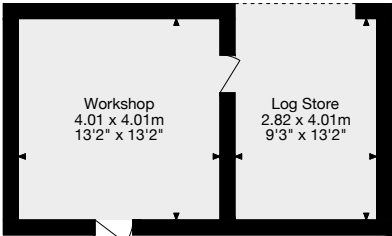

Outbuilding

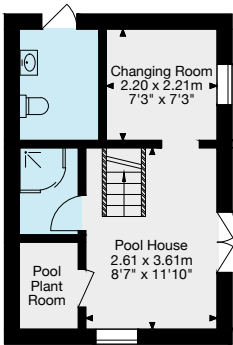

Ground Floor
Pool House

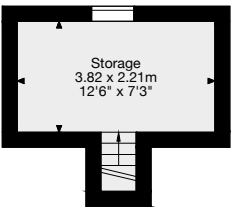

First Floor

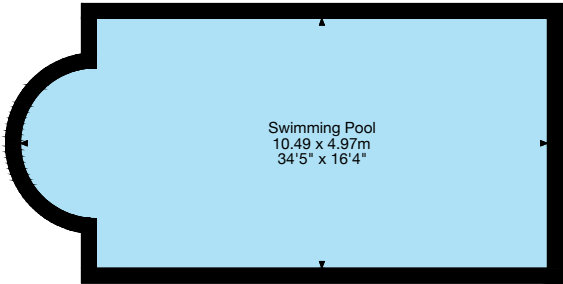

Outdoor Swimming Pool

- Living Area/Reception
- Kitchen/Utility
- Bedroom/Dressing Room
- Bathroom/WC
- Vaults/Storage
- Terrace/Outside Space

Important Notice: This plan is not to scale (unless specified), is for guidance only and must not be relied upon as a statement of fact. All measurements and areas are approximate only (and have been prepared in accordance with the current edition of the RICS Code of Measuring Practice). Please read the Important Notice on the last page of text of the particulars. © Capture Property Marketing 2025.