

Stokes Hall

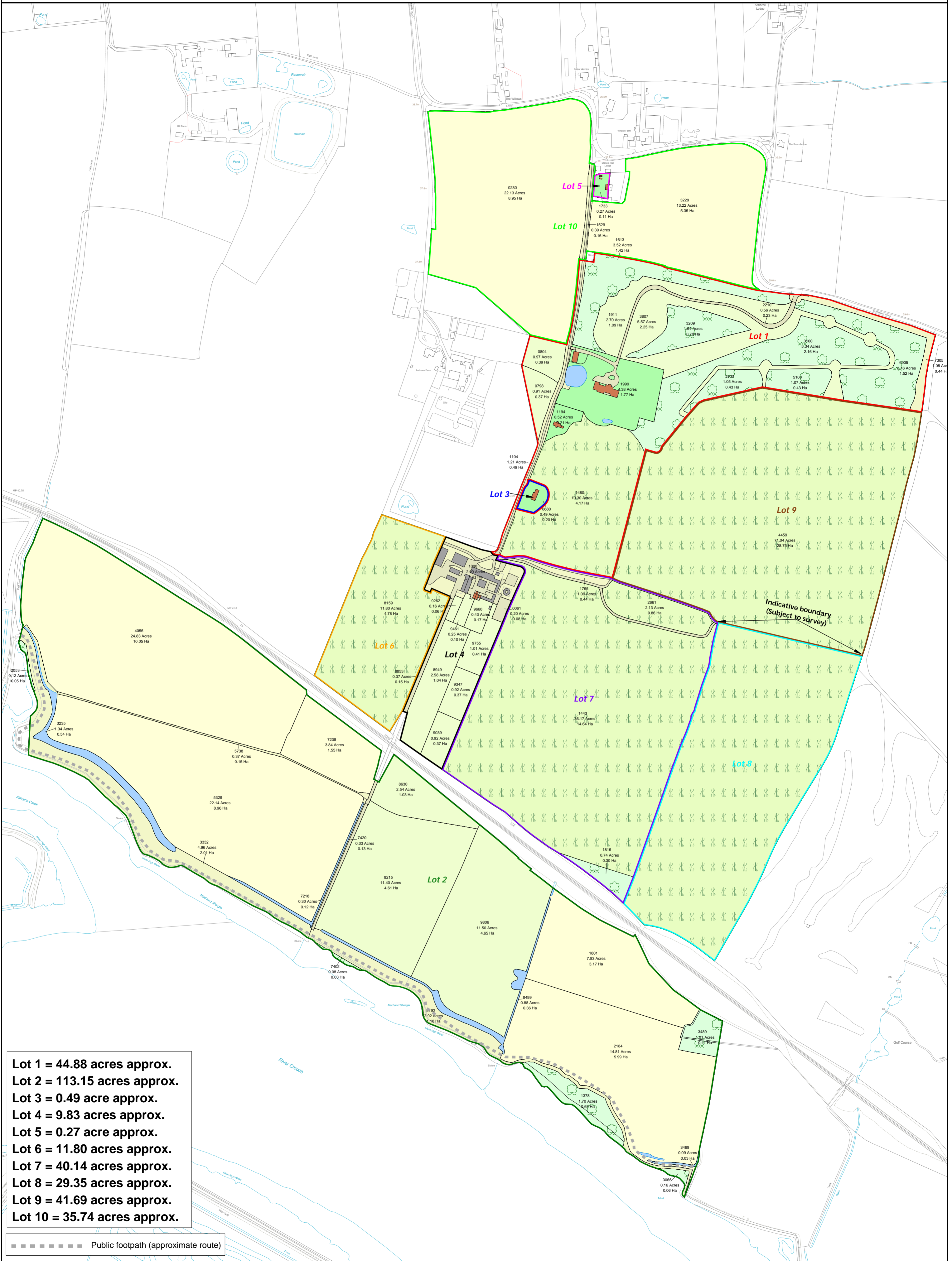

- Lot 1 = 44.88 acres approx.**
- Lot 2 = 113.15 acres approx.**
- Lot 3 = 0.49 acre approx.**
- Lot 4 = 9.83 acres approx.**
- Lot 5 = 0.27 acre approx.**
- Lot 6 = 11.80 acres approx.**
- Lot 7 = 40.14 acres approx.**
- Lot 8 = 29.35 acres approx.**
- Lot 9 = 41.69 acres approx.**
- Lot 10 = 35.74 acres approx.**

Public footpath (approximate route)

LDS Ltd
Plan Preparation
Unit 15, Glenmore Business Park
Telford Road
Salisbury SP2 7GL

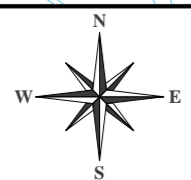

Land Use:	
	Pasture
	Arable
	Potential Vines
	Woodland
	Parkland
	Verge / Misc
	Water
	Orchard
	Heathland
	Rocks / Boulders
	Building (Residential)
	Building / Structure (Agricultural)
	Gardens
	Road / Track

NB: If field & building type are unknown - assumed pasture & residential



Date: 08/01/25
Drawn By: CW
Scale: 1:4000 @ A2
Plan Ref: 18871
Title: Stokes Hall

This Plan is published for guidance only, and although it is believed to be correct its accuracy is not guaranteed, nor is it intended to form part of any contract. ©Crown copyright and database rights 2025. Licence No. AC000818786