

Where no dimensions are given, drawings should not be scaled and enquiries should be referred to Tsunami Axis.
 Should dimensions or details on these drawings conflict, precedence shall be given to larger scale drawings. Where this drawing relates to existing buildings or completed construction the contractor shall check that there is no conflict between actual building dimensions and drawing dimensions. Such conflicts noted above shall be reported immediately to Tsunami Axis.
 This drawing may not be reproduced in part or in full without the prior consent of Tsunami Axis.
 All dimensions are in millimetres unless otherwise stated.

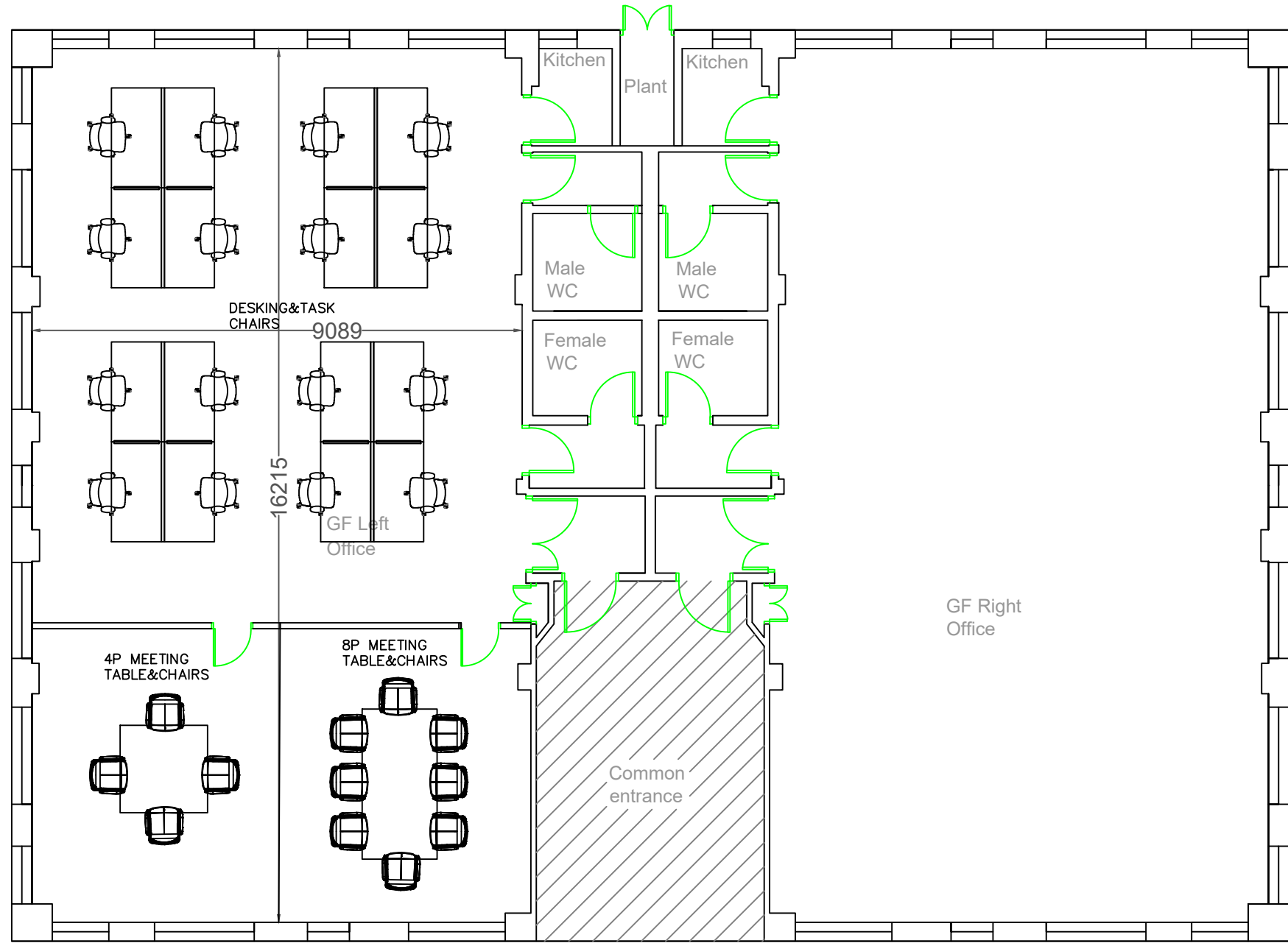

Rev	Date	Drawn	Description

Tsunami Axis
 24-32 Stephenson Way, London NW1 2HD
 T. 020 7636 8222 F. 020 7636 8777
 www.tsunami-axis.co.uk

Client:
LSPIM

Location:
Glasgow

Drawing Title:
Glasgow Floorplan

Scale: NA	Date: 03/05/2023
Drawn: LR	Checked: JM
Dep No: TAN-26798-01 - B	Rev: B