



Littleworth Road, Esher, Surrey, KT10

---





# Modern Detached Family Home

---

A modern detached family home ideally located for Esher town centre as well as Esher and Claygate train stations.

Built in 1996 by Kingsway Homes, this well proportioned detached house has a west facing backdrop of Esher Cricket Club.

A welcoming reception hall leads to five reception rooms and kitchen breakfast room. French doors lead to the formal sitting room which has a natural stone fireplace and garden views. There is also a large dining room, study, TV room and a further TV/snug which also opens onto the garden terrace.





Upstairs a galleried landing leads to five bedrooms which all benefit from air conditioning and three modern bathrooms. The principal bedroom and bedroom two both have double doors accessing the spacious balcony.

At the rear a large secluded stone terrace leads to a raised garden with benefits from a greenhouse and two sheds.

The present owners have added a triple garage and more recently solar panels and a Tesla battery.

Esher high street has an excellent range of restaurants and shops including Waitrose, Cote, Gail's Bakery, Giggling Squid, The Good Earth and Everyman Cinema along with a number of coffee shops and pubs.

Schooling in the area is superb with a large number of private and state schools in the immediate area including Claremont Fan Court, Shrewsbury House, Rowan, Esher Church School. The ACS Cobham International School, Reeds and Danes Hill are also conveniently located.











There is an excellent choice of recreational activities with Sandown Park offering horse racing, skiing, golf, go-karting, gym and squash, the historic Hampton Court Palace, the National Trust owned Claremont Landscaped Gardens all within the town. The towns of Kingston upon Thames and Guildford are a short distance away providing a wide selection of high street names and department stores.

Communication links are excellent with the station providing a fast and frequent service to London Waterloo. The A3 provides direct access to central London, the M25, Heathrow and Gatwick airports and the South.

EPC: B

Tenure: Freehold

Council Tax Band: H

Local Authority: Elmbridge Borough Council

All distances are approximate.

All schools referenced are subject to catchment areas and entry requirements.







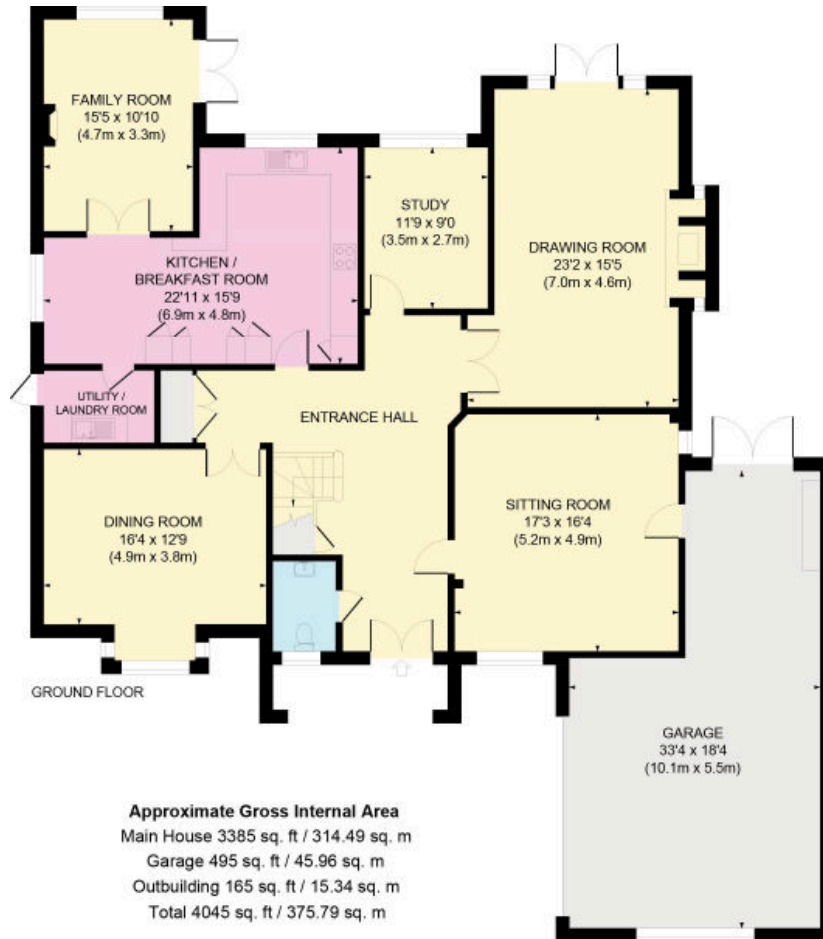

Knight Frank

47 High Street  
 Esher  
 Surrey KT10 9RL  
[knightfrank.co.uk](http://knightfrank.co.uk)

We would be delighted to tell you more

Adam Burlison  
 01372 239 984  
[adam.burlison@knightfrank.com](mailto:adam.burlison@knightfrank.com)

Maisie Bywater  
 01372 230466  
[maisie.bywater@knightfrank.com](mailto:maisie.bywater@knightfrank.com)

Amanda Lamble  
 01372 460892  
[amanda.lamble@knightfrank.com](mailto:amanda.lamble@knightfrank.com)



Fixtures and fittings: A list of the fitted carpets, curtains, light fittings and other items fixed to the property which are included in the sale (or may be available by separate negotiation) will be provided by the Seller's Solicitors.

Important Notice: 1. Particulars: These particulars are not an offer or contract, nor part of one. You should not rely on statements by Knight Frank LLP in the particulars or by word of mouth or in writing ("information") as being factually accurate about the property, its condition or its value. Neither Knight Frank LLP nor any joint agent has any authority to make any representations about the property, and accordingly any information given is entirely without responsibility on the part of the agents, seller(s) or lessor(s). 2. Photos, Videos etc: The photographs, property videos and virtual viewings etc. show only certain parts of the property as they appeared at the time they were taken. Areas, measurements and distances given are approximate only. 3. Regulations etc: Any reference to alterations to, or use of, any part of the property does not mean that any necessary planning, building regulations or other consent has been obtained. A buyer or lessee must find out by inspection or in other ways that these matters have been properly dealt with and that all that information is correct. 4. VAT: The VAT position relating to the property may change without notice. 5. To find out how we process Personal Data, please refer to our Group Privacy Statement and other notices at <https://www.knightfrank.com/legals/privacy-statement>.

Particulars dated July 2024. Photographs and videos dated July 2024.

Knight Frank is the trading name of Knight Frank LLP. Knight Frank LLP is a limited liability partnership registered in England and Wales with registered number OC305934. Our registered office is at 55 Baker Street, London W1U 8AN where you may look at a list of members' names. If we use the term 'partner' when referring to one of our representatives, that person will either be a member, employee, worker or consultant of Knight Frank LLP and not a partner in a partnership. If you do not want us to contact you further about our services then please contact us by either calling 020 3544 0692, email to [marketing.help@knightfrank.com](mailto:marketing.help@knightfrank.com) or post to our UK Residential Marketing Manager at our registered office (above) providing your name and address.