

Oxshott Road, Leatherhead, Surrey, KT22





An Impressive Family Home

An impressive family home is situated on the edge of Oxshott and Leatherhead, set within mature grounds that extend to approx. 2.5 acres, bordering Leatherhead Golf Club.

The property is approached via a long driveway which borders the garden on both sides. Accommodation includes six bedrooms, five bathrooms split across two floors with two separate front doors making one section of the property an ideal annex.

The principal ground floor rooms include a kitchen/breakfast room, drawing room and study and access to the annex. There is a detached triple garage with self contained room above with private front door.

Pachesham Park is an exclusive private residential estate surrounded by Leatherhead Golf Course.

Leatherhead has an excellent selection of local shops and leisure amenities, and is only a short distance from Cobham and Oxshott. The towns of Epsom and Guildford are also nearby providing a wider selection of high street names and department stores.

Communication links are excellent with its proximity to the A3 and the M25 (J9), Heathrow and Gatwick airports. Leatherhead, Oxshott and Epsom mainline railway stations are only a short driving distance providing regular services to London Waterloo and London Bridge.

There are a number of excellent private schools in the area including Danes Hill, St. John's, Downsend, Epsom College and City of London Freeman's.

EPC: E.

Tenure: Freehold

Local Authority: Mole Valley

Council Tax Band: G



6



6



4

EPC

E





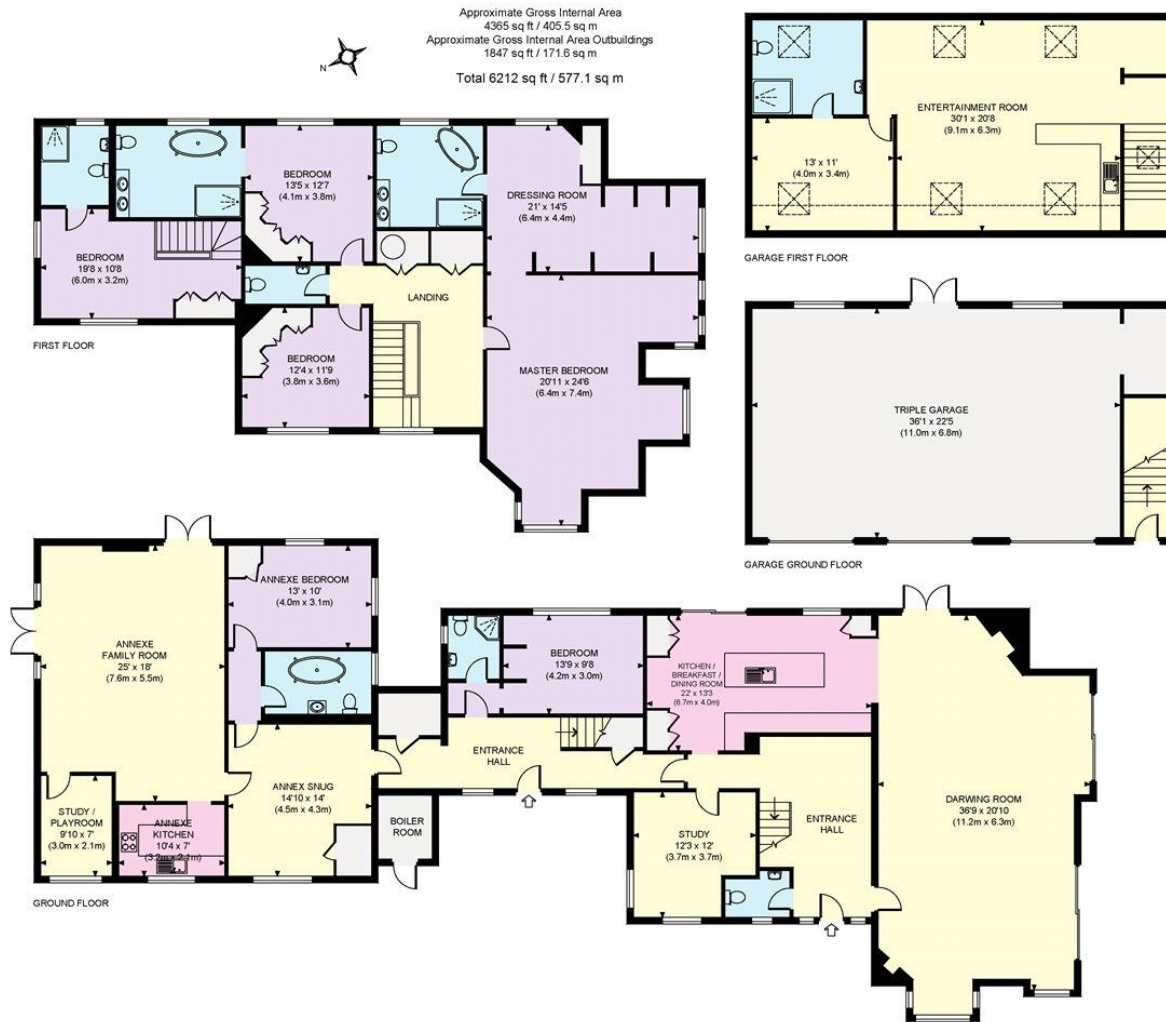

Knight Frank

47 High Street
Esher
Surrey KT10 9RL
knightfrank.co.uk

We would be delighted to tell you more

Adam Burlison
01372 239 984
adam.burlison@knightfrank.com

Maisie Bywater
01372 230466
maisie.bywater@knightfrank.com

Amanda Lamble
01372 460892
amanda.lamble@knightfrank.com



Fixtures and fittings: A list of the fitted carpets, curtains, light fittings and other items fixed to the property which are included in the sale (or may be available by separate negotiation) will be provided by the Seller's Solicitors.

Important Notice: 1. Particulars: These particulars are not an offer or contract, nor part of one. You should not rely on statements by Knight Frank LLP in the particulars or by word of mouth or in writing ("information") as being factually accurate about the property, its condition or its value. Neither Knight Frank LLP nor any joint agent has any authority to make any representations about the property, and accordingly any information given is entirely without responsibility on the part of the agents, seller(s) or lessor(s). 2. Photos, Videos etc: The photographs, property videos and virtual viewings etc. show only certain parts of the property as they appeared at the time they were taken. Areas, measurements and distances given are approximate only. 3. Regulations etc: Any reference to alterations to, or use of, any part of the property does not mean that any necessary planning, building regulations or other consent has been obtained. A buyer or lessee must find out by inspection or in other ways that these matters have been properly dealt with and that all information is correct. 4. VAT: The VAT position relating to the property may change without notice. 5. To find out how we process Personal Data, please refer to our Group Privacy Statement and other notices at <https://www.knightfrank.com/legals/privacy-statement>.

Particulars dated October 2024. Photographs and videos dated October 2024.

Knight Frank is the trading name of Knight Frank LLP. Knight Frank LLP is a limited liability partnership registered in England and Wales with registered number OC305934. Our registered office is at 55 Baker Street, London W1U 8AN where you may look at a list of members' names. If we use the term 'partner' when referring to one of our representatives, that person will either be a member, employee, worker or consultant of Knight Frank LLP and not a partner in a partnership. If you do not want us to contact you further about our services then please contact us by either calling 020 3544 0692, email to marketing.help@knightfrank.com or post to our UK Residential Marketing Manager at our registered office (above) providing your name and address.