







Notes / Legend:

-  Denotes existing structure.
-  Denotes line of coombed ceiling
-  Denotes existing roof hatches
-  Denotes fire protected zones
-  Denotes Travel Distances
-  Denotes proposed corridor and kitchen/break out area.
-  Denotes existing stud partitions to be lined with additional layer of 12.5mm plasterboard either side. Opening up works to be carried out prior to plasterboard overlay to establish existing fire rating.
-  Denotes New 1Hr fire rated 70 S 50 'C' metal stud partitioning @ 600mm centres, include for base and head plates. Include 50mm Isover Acoustic Partition Roll (APR) to cavity between studs. Lined each side with 15mm gyproc fireline board at 24kg/m2, taped and filled ready to receive decoration.

As the newly formed corridor exceeds 12m in length, it is required to be divided in the middle third by means of installation of a partition and door set in compliance with section 2.9.13 fire and smoke controls in corridors.

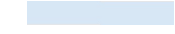
Occupant Capacity:

- Suite 1: 32 m2 / 6 (OLF) = 5.3 ~ (5 OC)
- Suite 2: 25 m2 / 6 (OLF) = 4.2 ~ (4 OC)
- Suite 3: 47 m2 / 6 (OLF) = 7.8 ~ (8 OC)
- Suite 4: 40 m2 / 6 (OLF) = 6.6 ~ (7 OC)
- Suite 5: 21 m2 / 6 (OLF) = 3.5 ~ (4 OC)
- Suite 6: 53 m2 / 6 (OLF) = 8.8 ~ (9 OC)
- Suite 7: 24 m2 / 6 (OLF) = 4 ~ (4 OC)
- Suite 8: 15 m2 / 6 (OLF) = 2.5 ~ (3 OC)

TOTAL OCCUPANT CAPACITY = 44

Note: Occupant capacity does not exceed 60 persons and therefore no requirement for outward opening doors.

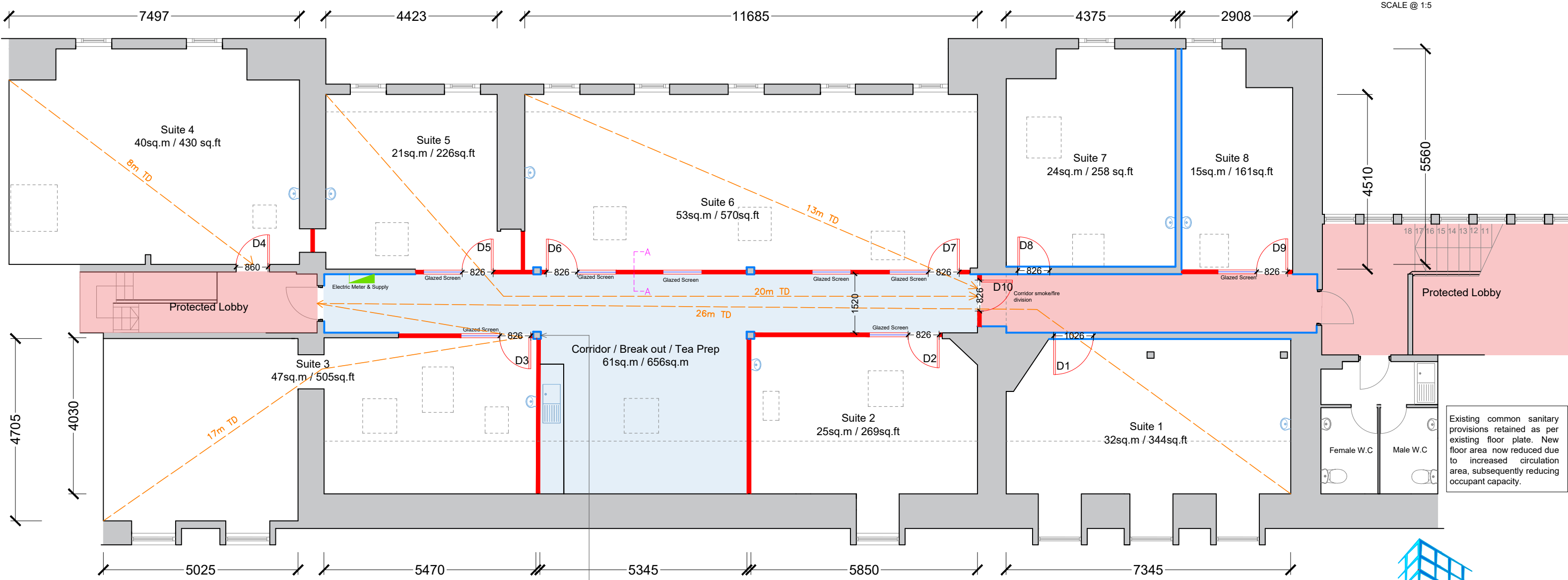
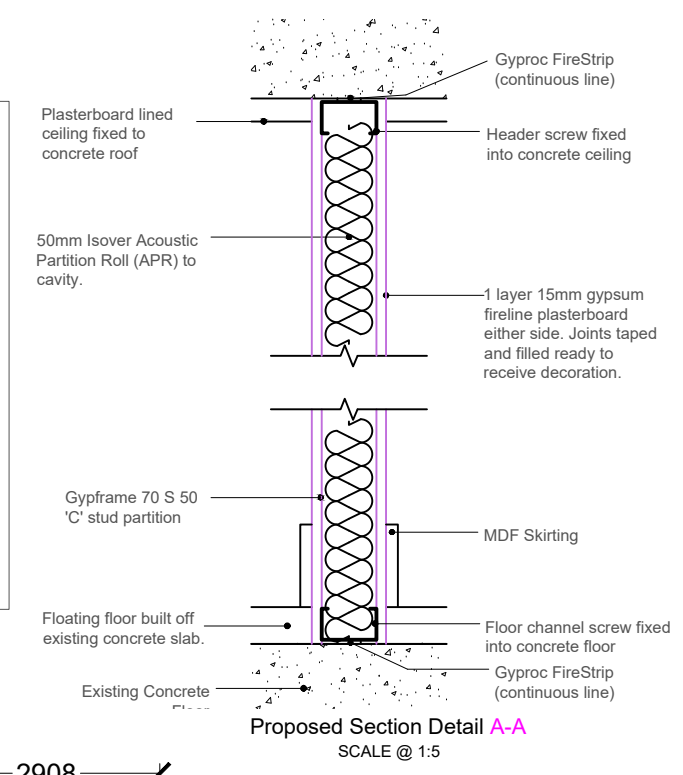

Existing common sanitary provisions retained as per existing floor plate. New floor area now reduced due to increased circulation area, subsequently reducing occupant capacity.

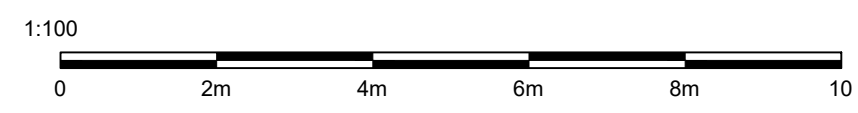

4No. Existing coloums within corridor to be 60Min Fire Rated. Opening up works to be carried out to identify the current fire rating. If insufficient, contractor to fix additional layer of 15mm fireline board.

Title: Proposed Floor Plan	Property: Central Chambers 6th Floor, Glasgow	Client: Stelmair
Scale: 1:100 @ A3	Date: 31/01/24	Job no.: 4078
Issue: Building Warrant	Drawn by: CJM	Dwg. no.: BW-05
Revision:	Description	Date



Mackinnon & Co
chartered building surveyors architectural services project managers

208 West George Street t. 0141 204 3311
Glasgow G2 2PQ e. info@mackco.co.uk

www.mackinnon-building-surveyors.co.uk

FLOOR PLAN AS PROPOSED
SCALE @ 1:100

BW5