



Runwick House, Runwick, Farnham, Surrey





A classical **Georgian country house** with extensive family accommodation and outbuildings set in mature garden and grounds.

Summary of accommodation

Ground Floor

Reception hall | Drawing room | Dining room | Sitting room | Kitchen/breakfast room | Pantry | Larder | Utility room
Cloakroom | Secondary kitchen/boot room | Extensive cellars

First & Second Floor

Principal bedroom with adjoining shower room | 7/8 further bedrooms | Bedroom 8/Study | Two further bathrooms | Two bedroom annexe with shower room and WC

Outside

Substantial barn providing workshop, storage areas and party/entertaining room above | Six car garage block
Former stables with adjacent tack room and double garage | Loggia | Attractive partially walled mature garden | Parkland and field

In all approximately 11.3 acres

Distances

Farnham 1.8 miles, (London Waterloo from 53 minutes), M3 motorway (Junction 5) 8.5 miles, Guildford 12 miles, Central London 42 miles
(All distances and times are approximate)



Knight Frank North Hampshire
Matrix House, Basing View
Basingstoke
RG21 4FF
knightfrank.co.uk

Knight Frank Country Department
55 Baker Street
London
W1U 8AN
knightfrank.co.uk

Clive Moon
0125 663 0976
clive.moonr@knightfrank.com

Edward Cunningham
020 7861 1080
edward.cunningham@knightfrank.com

Runwick House

Runwick House is a classical Grade II listed Georgian Country House that dates from the late 18th Century with alternations during the 19th Century.

The accommodation is arranged over three floors above a cellar and is light and spacious throughout. The principal receptions, being the drawing and dining room, have fine decorative cornicing with ornate fireplaces, large sash windows and double doors leading to the south-facing terrace. There is also a comfortable sitting room with fireplace and the kitchen/breakfast room has a gas fired AGA.

To the rear of the house there are excellent domestic offices including a utility room, boot room/secondary kitchen, storerooms and a large pantry. There is also access to the extensive cellars, which comprise a small wine cellar, four store rooms, a gas fired boiler and hot water cylinder.

To the first floor is a principal bedroom with its bay window overlooking the garden, adjacent is a shower room. There are three further bedrooms which are served by the family bathroom and to the second floor there are four further bedrooms, a study/bedroom and a family bathroom.

There is potential to create a self-contained annexe by combining the secondary kitchen and the 1/2 bedrooms above it, together with the shower room and WC.

Outbuildings

There is a substantial array of outbuildings which are adjacent to the rear of the house. These include a purpose-built garage for six cars, the original stable block is currently used as storage with a tack room and garaging.

To the rear of the stables is the long barn, on the ground floor there is a workshop, further storage areas, WC and stairs leading up to a large, vaulted entertainment area with storerooms either end. The barn has tremendous potential, subject to relevant planning consents.





Garden, Grounds and Pastureland

The mature gardens are a fine feature of the property and lie predominately to the south of the house. Adjacent to the house is a raised terrace with loggia, flower beds and steps leading down to a central path, flanked on either side by mature trees and lawns. This in turn leads to an area of parkland.

Beside the house there is a walled garden with fruit trees, lawn and a vegetable patch. Beyond the formal gardens are areas of grassland including a large field that has independent road access.



- Reception
- Bedroom
- Bathroom
- Kitchen/Utility
- Storage
- Outside

Approximate Gross Internal Floor Area
 House: 6975 sq ft / 648 sq m (inc. cellars)
 Barn & Stable Building: 5953 sq ft / 553 sq m
 Garage: 1270 sq ft / 118 sq m

This plan is for guidance only and must not be relied upon as a statement of fact. Attention is drawn to the Important Notice on the last page of the text of the Particulars.





Situation

The property is located in the small hamlet of Runwick on the Surrey/Hampshire border. The hamlet is surrounded by open countryside. It lies to the west of the attractive and historic market town of Farnham, renowned for its Medieval and Georgian architecture. It also provides a comprehensive selection of shops including a department store as well as numerous cafes, bars and restaurants, together with a Waitrose and Sainsburys. Slightly further afield is the Cathedral city of Guildford.

The location combines a genuine rural environment yet with excellent transport links to London.

There is an excellent choice of schools nearby, including Lord Wandsworth College, Frensham Heights, Barfield, Edgeborough, Prior's Field School, St Catherine's and Charterhouse, to name but a few.

Directions (GU10 5EG)

what3words: ///language.reporters.look

Services

Mains water, electricity, gas central heating and hot water and private drainage.

Property Information

Tenure: Freehold, with vacant possession upon completion

Local Authority: Waverley Borough Council

Council Tax: Band H

EPC: D

Guide Price: £3,750,000

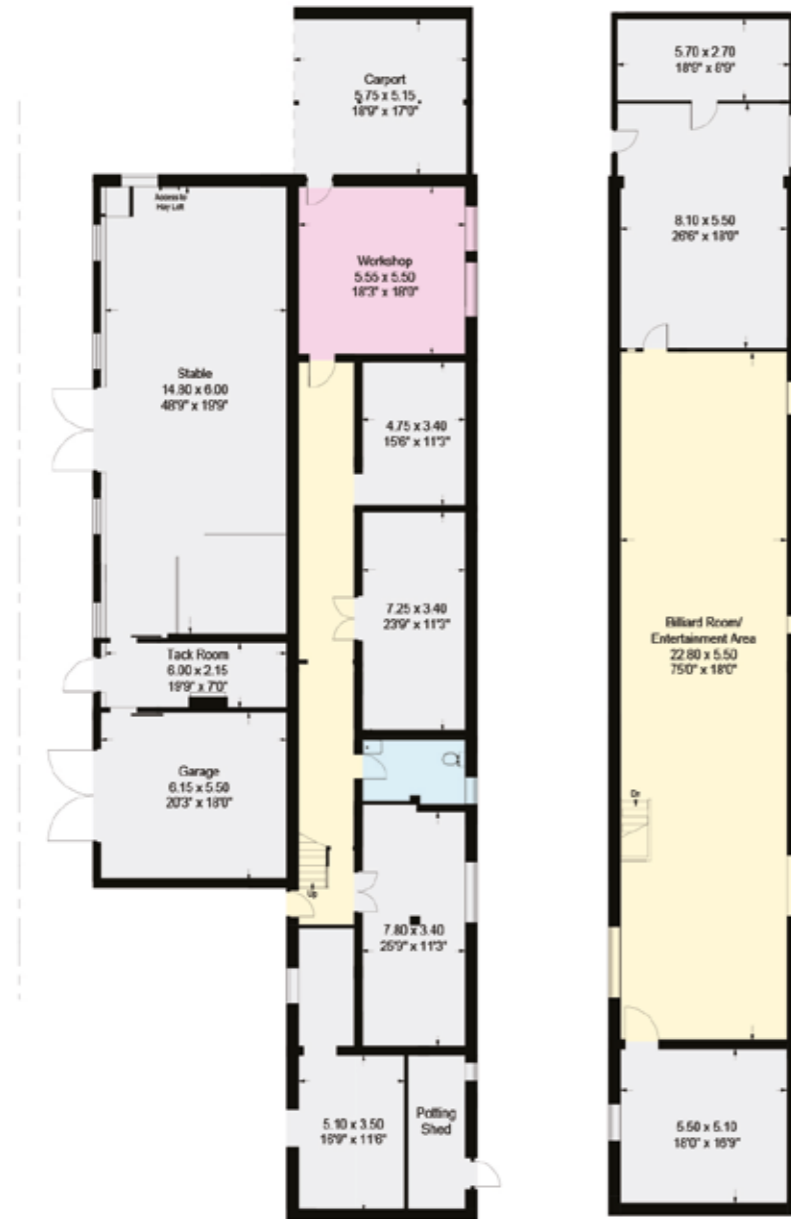

Barn - Ground Floor

Barn - First Floor

- Reception
- Bedroom
- Bathroom
- Kitchen/Utility
- Storage
- Outside

Fixtures and fittings: A list of the fitted carpets, curtains, light fittings and other items fixed to the property which are included in the sale (or may be available by separate negotiation) will be provided by the Seller's Solicitors.

Important Notice: 1. Particulars: These particulars are not an offer or contract, nor part of one. You should not rely on statements by Knight Frank LLP in the particulars or by word of mouth or in writing ("information") as being factually accurate about the property, its condition or its value. Neither Knight Frank LLP nor any joint agent has any authority to make any representations about the property, and accordingly any information given is entirely without responsibility on the part of the agents, seller(s) or lessor(s). 2. Photos, Videos etc: The photographs, property videos and virtual viewings etc. show only certain parts of the property as they appeared at the time they were taken. Areas, measurements and distances given are approximate only. 3. Regulations etc: Any reference to alterations to, or use of, any part of the property does not mean that any necessary planning, building regulations or other consent has been obtained. A buyer or lessee must find out by inspection or in other ways that these matters have been properly dealt with and that all information is correct. 4. VAT: The VAT position relating to the property may change without notice. 5. To find out how we process Personal Data, please refer to our Group Privacy Statement and other notices at <https://www.knightfrank.com/legals/privacy-statement>. Particulars dated February 2024, Photographs and videos dated 2022.

All information is correct at the time of going to print. Knight Frank is the trading name of Knight Frank LLP. Knight Frank LLP is a limited liability partnership registered in England and Wales with registered number OC305934. Our registered office is at 55 Baker Street, London W1U 8AN. We use the term 'partner' to refer to a member of Knight Frank LLP, or an employee or consultant. A list of members names of Knight Frank LLP may be inspected at our registered office. If you do not want us to contact you further about our services then please contact us by either calling 020 3544 0692, email to marketing.help@knightfrank.com or post to our UK Residential Marketing Manager at our registered office (above) providing your name and address. Brochure by wordperfectprint.com



