



Goring Heath, Oxfordshire



A delightful and unique home.

Abbot's Tower is a delightful and unique home with an interesting history. It was originally a water tower built in 1902 for the neighbouring property before being converted into a residence.

It has been extensively refurbished by the current owners, with a number of the original features still visible. The property has a beautiful garden with wonderful views across the open countryside.



Guide price: £1,250,000

Tenure: Freehold

Local authority: South Oxfordshire District Council

Council tax band: F



The property

Approaching the property via a gravel driveway, the entrance hall has wooden flooring, a wood burner and a staircase leading to the first floor. Off the hall is a cloakroom with WC and the fully fitted kitchen, with integrated appliances including a dishwasher and a range cooker with hood.

The comfortable sitting room leads into a circular dining room. French windows open into a boot room with a spiral staircase to a wonderful circular tower room with amazing views over the gardens. A large loft space has the potential to be converted into further accommodation. There is also a garden room with patio doors opening out on to the delightful garden terrace, which in turn leads to a fully insulated annexe with electricity, wifi, shower room and kitchenette.

The first floor is accessed via the hallway staircase to a landing area with built-in bookcases. The principal bedroom has fitted wardrobes and a dressing room, and the second double bedroom has eave storage and wardrobes. A family bathroom with bath and shower completes the accommodation.





Extensively refurbished with original features preserved



Garden and grounds

To the front of the property is a gravel driveway with parking for several cars. The large garden is laid to lawn with mature hedging, specimen plants and views across fields and beyond. There are also several outbuildings including a further summerhouse at the end of the garden, an ideal place to relax on a summer's evening.

Situation

The pretty market towns of Henley-on-Thames, Wallingford and Goring are close at hand with an excellent range of shops, schools and recreational facilities. The larger centres of Reading and Oxford are also easily accessible for more comprehensive amenities. There are convenient commuter rail services from nearby Goring and Streatley mainline station direct to London Paddington in approximately 1 hour and from Reading in approximately 25 minutes. Abbots Tower is surrounded by open countryside, which provides an abundance of pretty walks and horse riding. The property enjoys far-reaching views over open fields and woodland.

Goring Heath, Reading

Directions

Proceed out of Henley up Gravel Hill, passing through Greys Green. Turn left at the T-junction at Bolts Cross and follow the road over Peppard Common. Take the right turn signed to Gallowstree Common and proceed over the crossroads following the signs to Gallowstree Common. Upon reaching Cane End turn right at the T-junction onto the A4074 signed to Wallingford. After approximately 1 mile, take the left turn onto the B4526 signed to Goring. Abbots Tower is on the left shortly after the road bends right.

Services

Mains electricity, water; oil central heating; private drainage.

Knight Frank

Henley

20 Thameside

Henley-on-Thames

RG9 2LJ

knightfrank.co.uk

I would be delighted to tell you more

Nick Warner

01491 844901

nick.warner@knightfrank.com

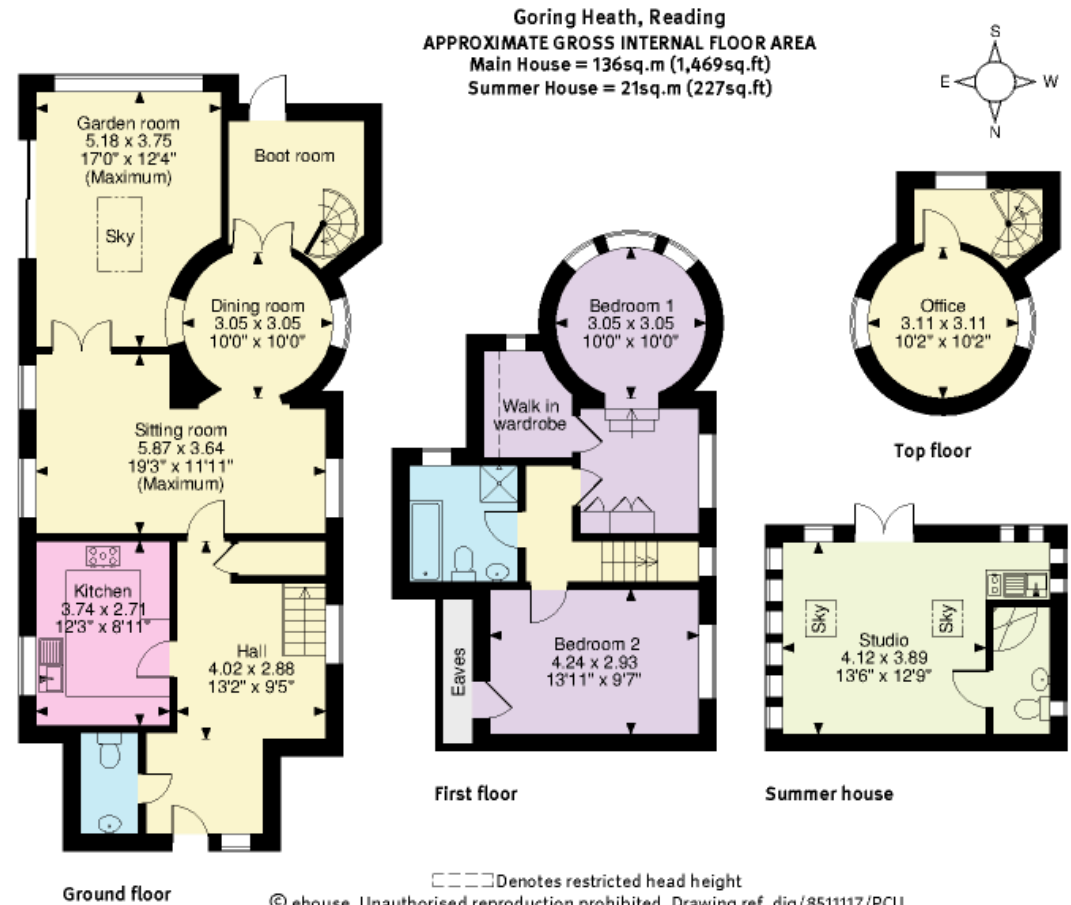

This plan is for guidance only and must not be relied upon as a statement of fact. Attention is drawn to the important notice on the last page of the text of the Particulars.



All potential tenants should be advised that, as well as rent a holding deposit will be payable which is equal to one week's rent (if an AST) and two weeks' rent (if not an AST), a tenancy deposit will also be payable which is equal to 6 weeks' rent (if not an AST and/or the annual rent is over £50,000), or 5 weeks' rent (if an AST and/or the annual rent is below £50,000). If the landlord agrees to you having a pet you may be required to pay a higher deposit (if not an AST) or higher weekly rent (if an AST). An administration fee of £288 and referencing fees of £48 per person will also apply when renting a property (if not an AST). (All fees shown are inclusive of VAT). For other fees that might apply, please ask us or visit www.knightfrank.co.uk/tenantfees.

Fixtures and fittings: Carpets, curtains, light fittings and other items fixed to the property (and not fixed to the property) belonging to the landlord are included in any tenancy as evidenced in the inventory, unless specifically noted otherwise. All those items regarded as tenant's fixtures and fittings, are specifically excluded from any tenancy and will not be evidenced in the inventory. Important Notice: 1. Particulars: These particulars are not an offer or contract, nor part of one. You should not rely on statements by Knight Frank LLP in the particulars or by word of mouth or in writing ("information") as being factually accurate about the property, its condition or its value. Neither Knight Frank LLP nor any joint agent has any authority to make any representations about the property, and accordingly any information given is entirely without responsibility on the part of the agents, seller(s) or lessor(s). 2. Photos, Videos etc: The photographs, property videos and virtual viewings etc. show only certain parts of the property as they appeared at the time they were taken. Areas, measurements and distances given are approximate only. 3. Regulations etc: Any reference to alterations to, or use of, any part of the property does not mean that any necessary planning, building regulations or other consent has been obtained. A buyer or lessee must find out by inspection or in other ways that these matters have been properly dealt with and that all information is correct. 4. VAT: The VAT position relating to the property may change without notice. 5. To find out how we process Personal Data, please refer to our Group Privacy Statement and other notices at <https://www.knightfrank.com/legals/privacy-statement>.

Particulars dated June 2022. Photographs and videos dated June 2022.

Knight Frank is the trading name of Knight Frank LLP. Knight Frank LLP is a limited liability partnership registered in England and Wales with registered number OC305934. Our registered office is at 55 Baker Street, London W1U 8AN where you may look at a list of members' names. If we use the term 'partner' when referring to one of our representatives, that person will either be a member, employee, worker or consultant of Knight Frank LLP and not a partner in a partnership. If you do not want us to contact you further about our services then please contact us by either calling 020 3544 0692, email to marketing.help@knightfrank.com or post to our UK Residential Marketing Manager at our registered office (above) providing your name and address.