



Wicks Lane, Shurlock Row, Berkshire



A charming cottage situated in the heart of Shurlock Row

Knight Frank are delighted to offer this attractive Grade II listed detached cottage enjoying a lovely, tucked-away position.

The original cottage is believed to date back to the 16th Century and is beautifully maintained, displaying a wealth of period features, including exposed beams and a wonderful inglenook fireplace in the sitting room. The original cottage connects to a striking, modern extension via a glazed hallway.

Foxcote also benefits from a lovely garden of approximately 1/3 acre.



Guide price: £1,300,000

Tenure: Freehold

Local authority: Royal Borough of Windsor and Maidenhead

Council tax band: G

Services: Mains electricity and water. Oil fired central heating.

The property

The house is entered via the attractive, modern extension leading into a lovely hallway with doors radiating to the kitchen and reception rooms. The extension houses a stunning kitchen with double-height ceilings, large glazed areas and bi-folding doors opening on to the wonderful sunken patio and beautiful west-facing gardens beyond.

The kitchen is fitted with a range of floor units and shelving with integrated appliances and granite work surfaces, as well as porcelain tiled floors with underfloor heating. There is also a utility and cloakroom.

Bedroom four lies adjacent to the kitchen and has a stylish en suite shower room.





The property (continued)

Stairs rise to the principal bedroom which enjoys lovely views over the rear garden, a large en suite bathroom and excellent fitted wardrobe space.

A second staircase takes you to a further two double bedrooms and a shower room in the original part of the cottage, all with beautiful original beams.





Garden and grounds

To the side of the property is a gravel driveway providing parking for several vehicles and leading to the garage with electric gates. The rear garden has been beautifully landscaped with box hedging, mature shrubs and trees with a large expanse of lawn bordered by close board panel fencing and an array of shrubs, plants and dwarf trees, a greenhouse, two garden sheds (one currently used as a bike storage). Recently added workshop and home office/studio. Behind a pretty picket fence is a vegetable/fruit garden and from the kitchen there is a sunken terrace with a timber decked floor, an ideal area for al fresco entertaining. Cast iron steps lead up to the remaining garden.



Situation

Located on the edge of the attractive village of Shurlock Row, between Reading and Maidenhead. There are several good schools in the area, including a nursery school, village primary school and a variety of state and private schools, including Holyport College, Reading Blue Coats, The Abbey, Queen Anne's and other very good schools in Eton/Windsor and Ascot.

The village lies to the south of Twyford and is only 5 miles from the pretty, riverside market town of Henley-on-Thames. More comprehensive facilities can be found in Windsor, Maidenhead, Twyford and Wokingham, all of which have railway stations serving London (about 25 minutes from Twyford to Paddington) and the Elizabeth Line into Central London. The property is conveniently located at junction 8/9 of the M4, providing easy access to London, Heathrow and the motorway network.



The property has a wonderful mixture of original and contemporary features.



Foxcote, Wicks Lane, Shurlock Row, Berkshire

Directions (RG10 0PJ)

From Henley, crossing the bridge, turn right on the A321 towards Wargrave. Pass through the village of Wargrave and at the junction with the A4, continue over the roundabout in the direction of Twyford. At Twyford, continue across the traffic lights following signs towards Bracknell (B3018). Pass Dolphin School, take the first turning on the left into Hungerford Lane, and continue towards the village of Shurlock Row. Take the first turning right into Wicks lane, and Foxcote will be found after a short distance on the right hand side.

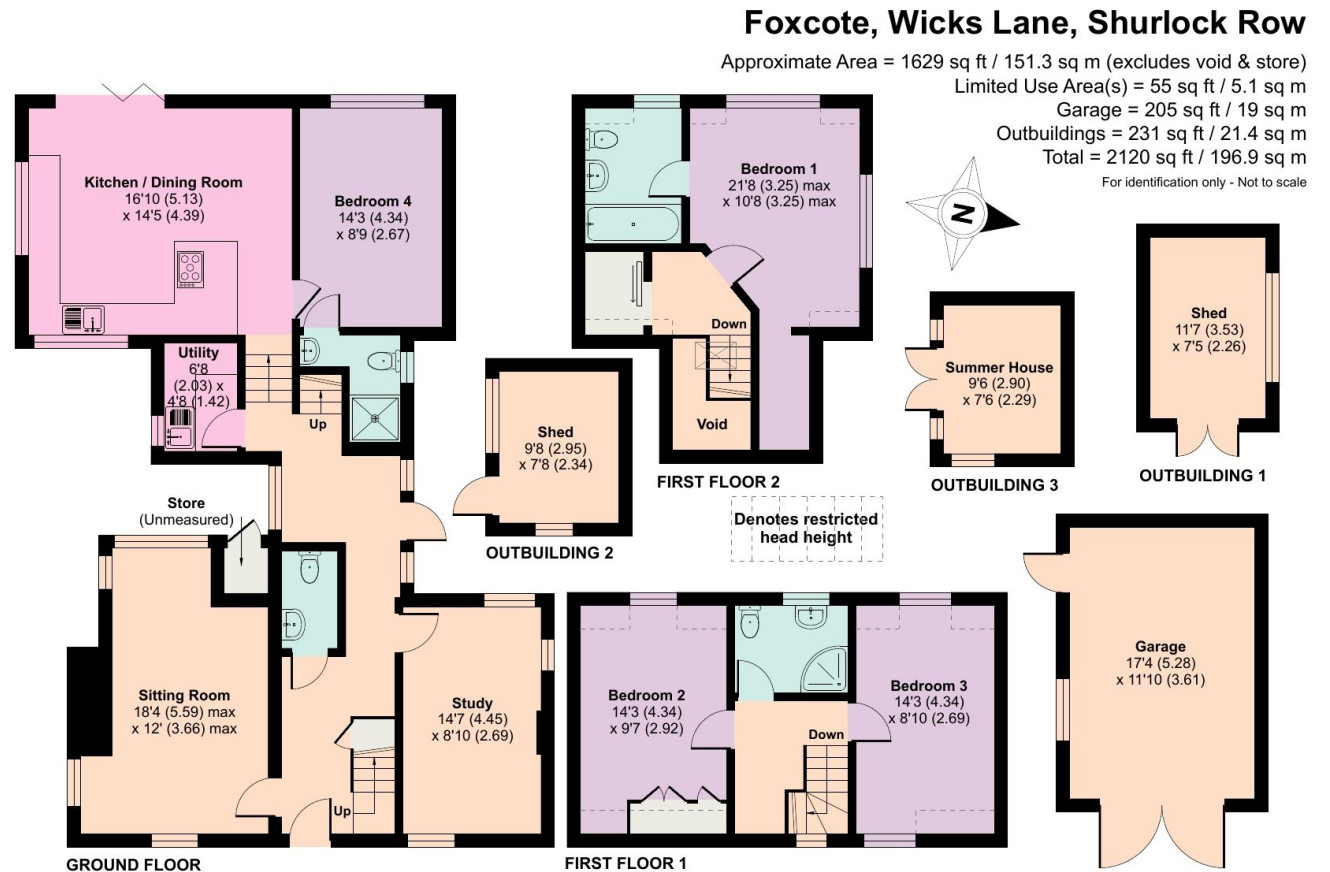

Knight Frank

Henley

20 Thameside

Henley-on-Thames

RG9 2LJ

[knightfrank.co.uk](https://www.knightfrank.co.uk)

I would be delighted to tell you more

Matt Davies

01491 844903

matt.davies@knightfrank.com



Fixtures and fittings: A list of the fitted carpets, curtains, light fittings and other items fixed to the property which are included in the sale (or may be available by separate negotiation) will be provided by the Seller's Solicitors.

Important Notice: 1. Particulars: These particulars are not an offer or contract, nor part of one. You should not rely on statements by Knight Frank LLP in the particulars or by word of mouth or in writing ("Information") as being factually accurate about the property, its condition or its value. Neither Knight Frank LLP nor any joint agent has any authority to make any representations about the property, and accordingly any information given is entirely without responsibility on the part of the agents, seller(s) or lessor(s). 2. Photos, Videos etc: The photographs, property videos and virtual viewings etc. show only certain parts of the property as they appeared at the time they were taken. Areas, measurements and distances given are approximate only. 3. Regulations etc: Any reference to alterations to, or use of, any part of the property does not mean that any necessary planning, building regulations or other consent has been obtained. A buyer or lessee must find out by inspection or in other ways that these matters have been properly dealt with and that all information is correct. 4. VAT: The VAT position relating to the property may change without notice. 5. To find out how we process Personal Data, please refer to our Group Privacy Statement and other notices at <https://www.knightfrank.com/legals/privacy-statement>. Particulars dated April 2024. Photographs and videos dated April 2024.

All information is correct at the time of going to print. Knight Frank is the trading name of Knight Frank LLP. Knight Frank LLP is a limited liability partnership registered in England and Wales with registered number OC305934. Our registered office is at 55 Baker Street, London W1U 8AN. We use the term 'partner' to refer to a member of Knight Frank LLP, or an employee or consultant. A list of members names of Knight Frank LLP may be inspected at our registered office. If you do not want us to contact you further about our services then please contact us by either calling 020 3544 0692, email to marketing.help@knightfrank.com or post to our UK Residential Marketing Manager at our registered office (above) providing your name and address.