

Carroll House, Bayswater W2





This beautiful apartment is located within a well-maintained building arranged around a communal garden near Hyde Park. The property is accessed on the fifth floor (with lift) and benefits from far reaching views towards the church on Sussex Gardens. The property itself is in very good condition and comprises a sizable reception room with big windows and a semi open plan kitchen with space for dining. The bedroom is a generous size with fitted wardrobes and there is also a bathroom.

Transport links include Paddington (Network Rail and Heathrow Express) and underground (District, Circle, Bakerloo and Hammersmith & City lines) and Lancaster Gate underground (Central line) station. The apartment is superbly positioned for the arrival of Crossrail.

The City of Westminster
Guide price
£495,000 Share of freehold





Carroll House

Approximate Gross Internal Area = 40.0 sq m / 430 sq ft

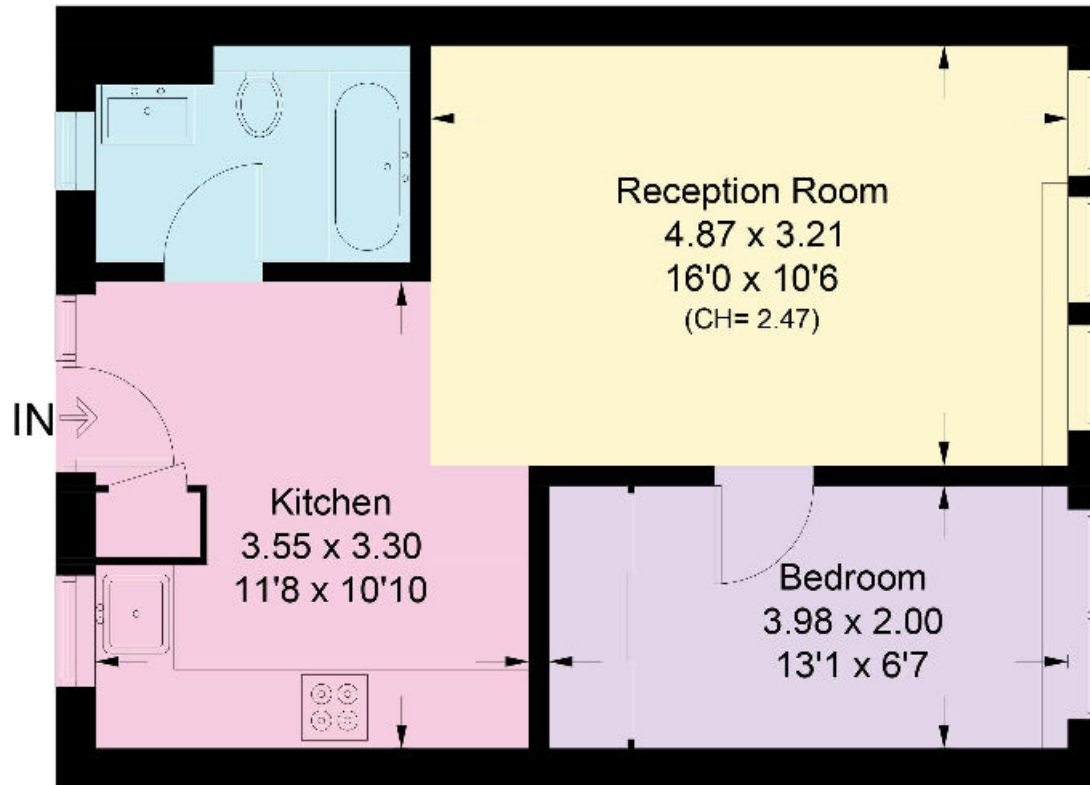

Fifth Floor

Illustration for identification purposes only, measurements are approximate, not to scale. floorplansUsketch.com © (ID700780)

Knight Frank
Hyde Park
1 Craven Terrace
London
W2 3QD

[knightfrank.co.uk](https://www.knightfrank.co.uk)

We would be delighted to tell you more.

020 7871 5060
hydepark@knightfrank.com



Connecting people & property, perfectly.

Fixtures and fittings: A list of the fitted carpets, curtains, light fittings and other items fixed to the property which are included in the sale (or may be available by separate negotiation) will be provided by the Seller's Solicitors.

Important Notice: 1. Particulars: These particulars are not an offer or contract, nor part of one. You should not rely on statements by Knight Frank LLP in the particulars or by word of mouth or in writing ("information") as being factually accurate about the property, its condition or its value. Neither Knight Frank LLP nor any joint agent has any authority to make any representations about the property, and accordingly any information given is entirely without responsibility on the part of the agents, seller(s) or lessor(s). 2. Photos, Videos etc: The photographs, property videos and virtual viewings etc. show only certain parts of the property as they appeared at the time they were taken. Areas, measurements and distances given are approximate only. 3. Regulations etc: Any reference to alterations to, or use of, any part of the property does not mean that any necessary planning, building regulations or other consent has been obtained. A buyer or lessee must find out by inspection or in other ways that these matters have been properly dealt with and that all information is correct. 4. VAT: The VAT position relating to the property may change without notice. 5. To find out how we process Personal Data, please refer to our Group Privacy Statement and other notices at <https://www.knightfrank.com/legals/privacy-statement>.

Particulars dated October 2020. Photographs and videos dated October 2020.

Knight Frank is the trading name of Knight Frank LLP. Knight Frank LLP is a limited liability partnership registered in England and Wales with registered number OC305934. Our registered office is at 55 Baker Street, London W1U 8AN where you may look at a list of members' names. If we use the term 'partner' when referring to one of our representatives, that person will either be a member, employee, worker or consultant of Knight Frank LLP and not a partner in a partnership. If you do not want us to contact you further about our services then please contact us by either calling 020 3544 0692, email to marketing.help@knightfrank.com or post to our UK Residential Marketing Manager at our registered office (above) providing your name and address.