



Bishops Court, Hyde Park W2



Bishops Court, Hyde Park W2

Set within a well maintained residential building benefitting from a porter and lift, this first floor two bedroom apartment offers good living spaces throughout.

The property comprises a spacious hallway with storage space. To the front is a large southerly facing reception room/dining room with a juliette balcony and a fitted kitchen.

To the rear is a large principal bedroom with fitted wardrobes and en-suite bathroom. The second bedroom is also a double with fitted wardrobes. Off the hallway is also a contemporary tiled shower room.

Bishops Court benefits from a central location and is close to the open spaces of Hyde Park.



Guide price: £950,000

Tenure: Leasehold: approximately 180 years remaining

Service charge: £4,007.48 per annum

Ground rent: peppercorn

Local authority: City of Westminster

Council tax band: E





Location:

Royal Oak underground (Circle and Hammersmith and City lines) is the nearest station.

Paddington mainline is also a short walk away, which offers; Network Rail and Heathrow Express, and underground lines; Elizabeth, District, Circle, Bakerloo and Hammersmith and City.

Lancaster Gate underground (Central line) station are also within close proximity.



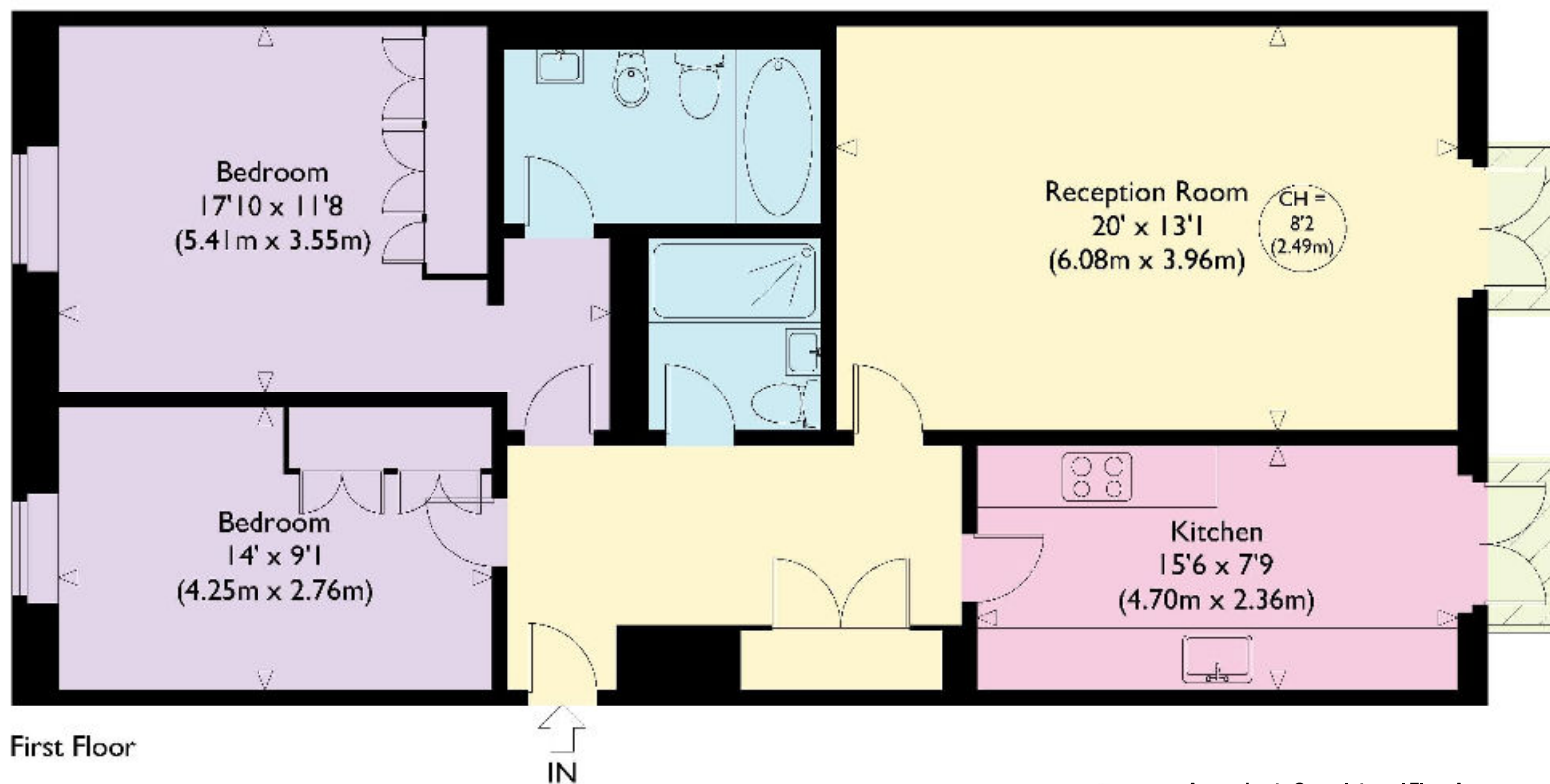

Approximate Gross Internal Floor Area
88.5 sq m / 953 sq ft

This plan is for guidance only and must not be relied upon as a statement of fact. Attention is drawn to the important notice on the last page of the text of the Particulars.

Knight Frank
Hyde Park
1 Craven Terrace
London
W2 3QD
[knightfrank.co.uk](https://www.knightfrank.co.uk)

We would be delighted to tell you more
Tim Perks
020 7871 5065
tim.perks@knightfrank.com



Fixtures and fittings: A list of the fitted carpets, curtains, light fittings and other items fixed to the property which are included in the sale (or may be available by separate negotiation) will be provided by the Seller's Solicitors.

Important Notice: 1. Particulars: These particulars are not an offer or contract, nor part of one. You should not rely on statements by Knight Frank LLP in the particulars or by word of mouth or in writing ("information") as being factually accurate about the property, its condition or its value. Neither Knight Frank LLP nor any joint agent has any authority to make any representations about the property, and accordingly any information given is entirely without responsibility on the part of the agents, seller(s) or lessor(s). 2. Photos, Videos etc: The photographs, property videos and virtual viewings etc. show only certain parts of the property as they appeared at the time they were taken. Areas, measurements and distances given are approximate only. 3. Regulations etc: Any reference to alterations to, or use of, any part of the property does not mean that any necessary planning, building regulations or other consent has been obtained. A buyer or lessee must find out by inspection or in other ways that these matters have been properly dealt with and that all information is correct. 4. VAT: The VAT position relating to the property may change without notice. 5. To find out how we process Personal Data, please refer to our Group Privacy Statement and other notices at <https://www.knightfrank.com/legals/privacy-statement>. Particulars dated October 2022. Photographs and videos dated October 2022.

Knight Frank is the trading name of Knight Frank LLP. Knight Frank LLP is a limited liability partnership registered in England and Wales with registered number OC305934. Our registered office is at 55 Baker Street, London W1U 8AN where you may look at a list of members' names. If we use the term 'partner' when referring to one of our representatives, that person will either be a member, employee, worker or consultant of Knight Frank LLP and not a partner in a partnership. If you do not want us to contact you further about our services then please contact us by either calling 020 3544 0692, email to marketing.help@knightfrank.com or post to our UK Residential Marketing Manager at our registered office (above) providing your name and address.