



Queens Gardens, London W2



Queens Gardens, Hyde Park W2

Located on the sought after garden square, Queens Gardens, this property is well arranged on the lower ground floor of a stucco period terrace and benefits from a private entrance. The property comprises a long hallway on entry with lots of fitted storage. To the front of the property is a bright reception room with good ceiling height and a galley style kitchen with integrated appliances.

The bedrooms are to the rear and both have access to the central private patio. Both are of equal size with the principal bedroom also featuring an en suite shower room. There is also a separate family bathroom.

NB: Please note the furniture in these images are CGI and for illustrative purposes only.



Asking price: £945,000

Tenure: Share of freehold plus leasehold, approximately 97 years remaining

Service charge: £2,688.64 per annum, reviewed every year, next review date 2025

Ground rent: Peppercorn

Local authority: City of Westminster

Council tax band: H





Location:

Queens Gardens is located in the heart of Bayswater with the shops and restaurants of Whitley's and Westbourne Grove nearby as well as the open spaces of Hyde Park. Queens Gardens is centrally located with excellent transport links such as Lancaster Gate underground (Central line) and Paddington mainline (Network Rail and Heathrow Express) and underground (District, Circle, Bakerloo and Hammersmith & City lines) stations.

Oxford Street and the West End are both easily accessible offering some of the best shops, restaurants and theatre London has to offer. Queens Gardens also is perfectly positioned for the arrival of the Crossrail.



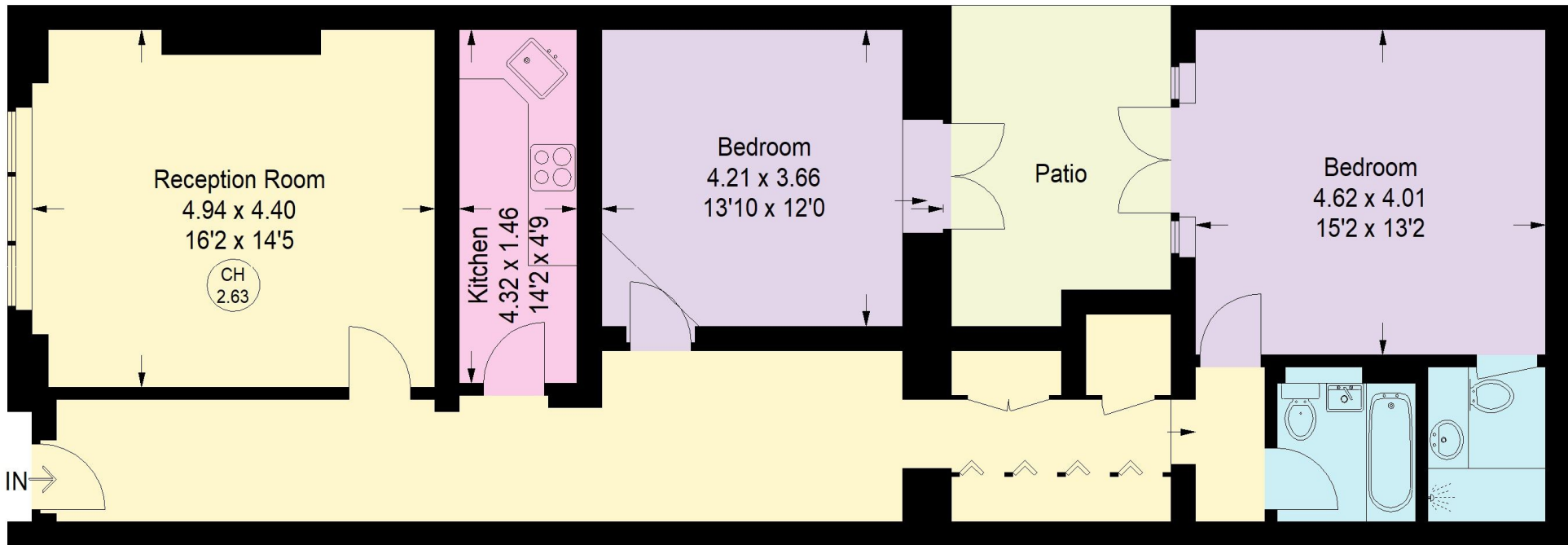

Approximate Gross Internal Floor Area
101.9 sq m / 1,097 sq ft

This plan is for guidance only and must not be relied upon as a statement of fact. Attention is drawn to the important notice on the last page of the text of the Particulars.



Knight Frank
Hyde Park
 1 Craven Terrace
 London
 W2 3QD
knightfrank.co.uk

We would be delighted to tell you more
Mark Ruffell
 020 3697 8234
mark.ruffell@knightfrank.com



Fixtures and fittings: A list of the fitted carpets, curtains, light fittings and other items fixed to the property which are included in the sale (or may be available by separate negotiation) will be provided by the Seller's Solicitors.

Important Notice: 1. Particulars: These particulars are not an offer or contract, nor part of one. You should not rely on statements by Knight Frank LLP in the particulars or by word of mouth or in writing ("information") as being factually accurate about the property, its condition or its value. Neither Knight Frank LLP nor any joint agent has any authority to make any representations about the property, and accordingly any information given is entirely without responsibility on the part of the agents, seller(s) or lessor(s). 2. Photos, Videos etc: The photographs, property videos and virtual viewings etc. show only certain parts of the property as they appeared at the time they were taken. Areas, measurements and distances given are approximate only. 3. Regulations etc: Any reference to alterations to, or use of, any part of the property does not mean that any necessary planning, building regulations or other consent has been obtained. A buyer or lessee must find out by inspection or in other ways that these matters have been properly dealt with and that all information is correct. 4. VAT: The VAT position relating to the property may change without notice. 5. To find out how we process Personal Data, please refer to our Group Privacy Statement and other notices at <https://www.knightfrank.com/legals/privacy-statement>. Particulars dated May 2022. Photographs and videos dated May 2022.

Knight Frank is the trading name of Knight Frank LLP. Knight Frank LLP is a limited liability partnership registered in England and Wales with registered number OC305934. Our registered office is at 55 Baker Street, London W1U 8AN where you may look at a list of members' names. If we use the term 'partner' when referring to one of our representatives, that person will either be a member, employee, worker or consultant of Knight Frank LLP and not a partner in a partnership. If you do not want us to contact you further about our services then please contact us by either calling 020 3544 0692, email to marketing.help@knightfrank.com or post to our UK Residential Marketing Manager at our registered office (above) providing your name and address.