





# Ralph Court, Hyde Park W2

---

Well-presented lateral apartment situated on the fifth floor of this popular portered mansion block close to Westbourne Grove and Queensway.

The apartment measures approximately 71.4 sq. m. (768 sq. ft.), and accommodation briefly comprises two double bedrooms with the principal features of a bay window and en suite shower room, a further family shower room, a separate well-equipped kitchen with a great range of cabinets and integrated appliances. Elsewhere, there is a spacious reception room with ample dining space; however, the generous entry hallway can serve as dining space.



**Asking price:** £800,000

**Tenure:** Leasehold: approximately 137 years remaining

**Service charge:** £6,500 per annum, reviewed every year, next review due 2024

**Ground rent:** Peppercorn

**Local authority:** City of Westminster

**Council tax band:** D











## Location

Ralph Court is ideally positioned at the quieter, northern end of Queensway just moments from the superb choice of fashionable boutique shops, cafes and restaurants on Westbourne Grove whilst there are excellent transport links available at the underground stations of Queensway and Bayswater which are just a stroll away. Slightly further afield is Paddington station offering Overground, underground and Elizabeth line services whilst the vast green open spaces of Hyde Park are at the end of the street.





# Ralph Court, W2

Approximate Area = 71.4 sq m / 768 sq ft  
Including Limited Use Area (0.2 sq m / 2 sq ft)

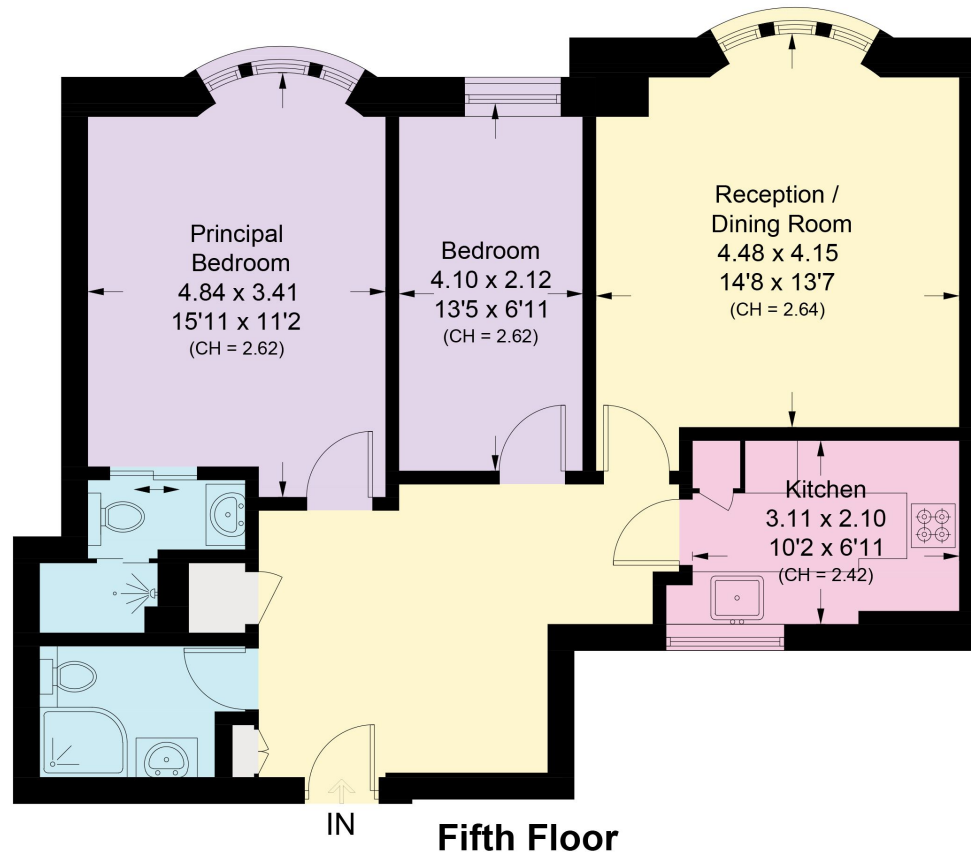

This plan is for guidance only and must not be relied upon as a statement of fact. Attention is drawn to the important notice on the last page of the text of the Particulars.

**Knight Frank**  
**Hyde Park**  
1 Craven Terrace  
London  
W2 3QD  
[knightfrank.co.uk](http://knightfrank.co.uk)

I would be delighted to tell you more  
**Mark Ruffell**  
020369 78234  
[mark.ruffell@knightfrank.com](mailto:mark.ruffell@knightfrank.com)



Fixtures and fittings: A list of the fitted carpets, curtains, light fittings and other items fixed to the property which are included in the sale (or may be available by separate negotiation) will be provided by the Seller's Solicitors.

Important Notice: 1. Particulars: These particulars are not an offer or contract, nor part of one. You should not rely on statements by Knight Frank LLP in the particulars or by word of mouth or in writing ("information") as being factually accurate about the property, its condition or its value. Neither Knight Frank LLP nor any joint agent has any authority to make any representations about the property, and accordingly any information given is entirely without responsibility on the part of the agents, seller(s) or lessor(s). 2. Photos, Videos etc: The photographs, property videos and virtual viewings etc. show only certain parts of the property as they appeared at the time they were taken. Areas, measurements and distances given are approximate only. 3. Regulations etc: Any reference to alterations to, or use of, any part of the property does not mean that any necessary planning, building regulations or other consent has been obtained. A buyer or lessee must find out by inspection or in other ways that these matters have been properly dealt with and that all information is correct. 4. VAT: The VAT position relating to the property may change without notice. 5. To find out how we process Personal Data, please refer to our Group Privacy Statement and other notices at <https://www.knightfrank.com/legals/privacy-statement>.

Particulars dated December 2023. Photographs and videos dated December 2023.

Knight Frank is the trading name of Knight Frank LLP. Knight Frank LLP is a limited liability partnership registered in England and Wales with registered number OC305934. Our registered office is at 55 Baker Street, London W1U 8AN where you may look at a list of members' names. If we use the term 'partner' when referring to one of our representatives, that person will either be a member, employee, worker or consultant of Knight Frank LLP and not a partner in a partnership. If you do not want us to contact you further about our services then please contact us by either calling 020 3544 0692, email to [marketing.help@knightfrank.com](mailto:marketing.help@knightfrank.com) or post to our UK Residential Marketing Manager at our registered office (above) providing your name and address.