



Hyde Park Gardens, Hyde Park W2

Hyde Park Gardens, Hyde Park W2

This Grade II listed, second floor apartment is located within one of the Hyde Park Estates most prestigious blocks. It is set on a private gated road, this property benefits from good sized spaces, lift and concierge. Ideally suited for a refurbishment project, it comprises a reception room with high ceilings and views out towards Hyde Park and the property communal garden.

The main hallway is a kitchen and a separate shower room, and to the rear of the flat is a principal bedroom and a second bedroom both with fitted wardrobes.

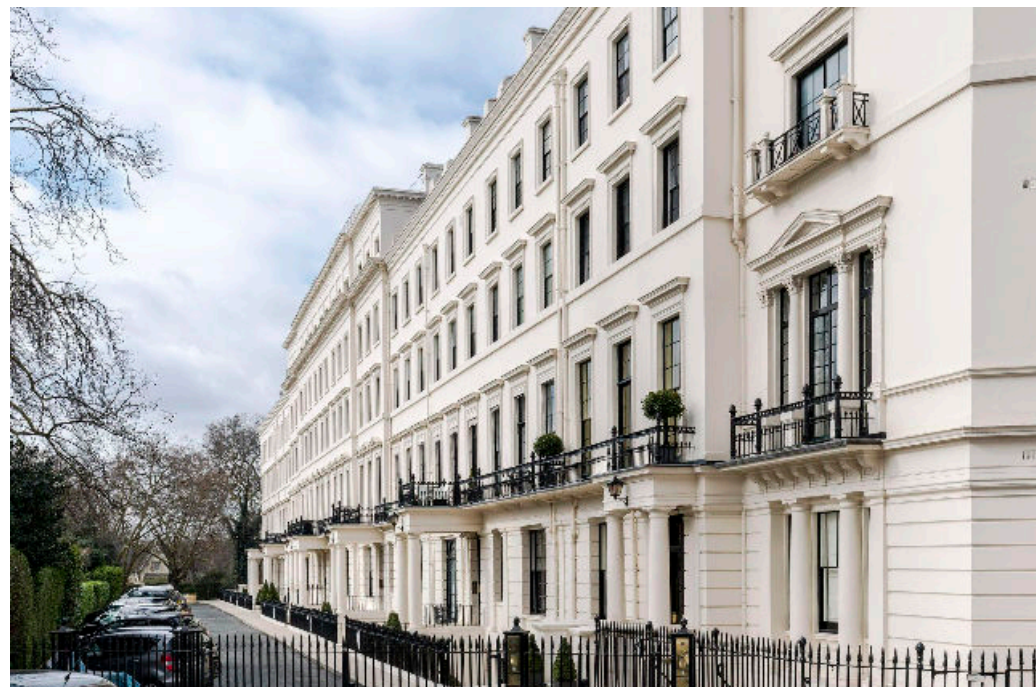

Guide price: £1,175,000

Tenure: Leasehold: approximately 24 years remaining

Service charge: £9,164 per annum, reviewed on an adhoc basis

Ground rent: £50 per annum, not reviewed

Local authority: City of Westminster

Council tax band: H



Hyde Park Gardens



This plan is for guidance only and must not be relied upon as a statement of fact. Attention is drawn to the important notice on the last page of the text of the Particulars.

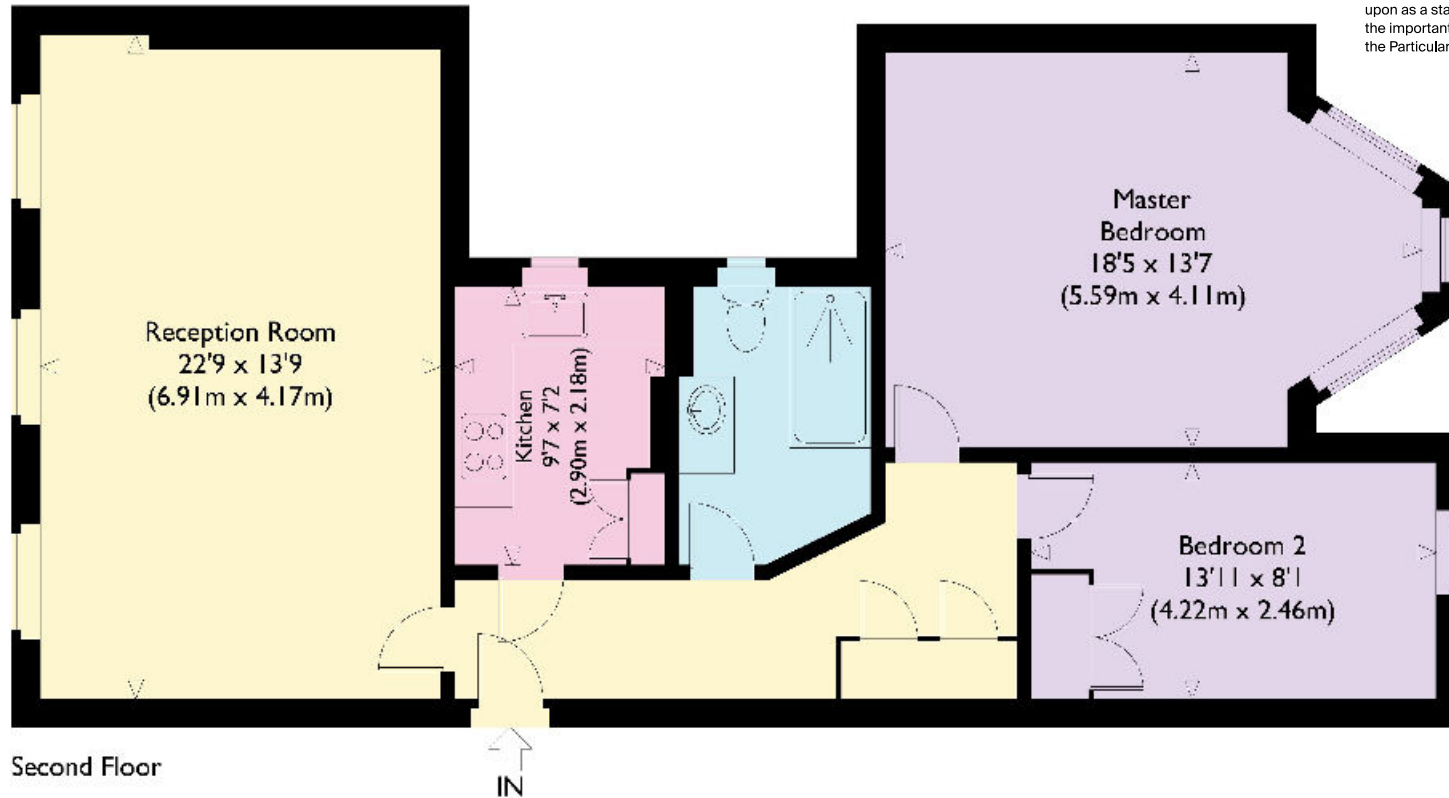

Approximate Gross Internal Floor Area
83.4 sq m / 898 sq ft

Knight Frank
Hyde Park
1 Craven Terrace
London
W2 3QD
[knightfrank.co.uk](https://www.knightfrank.co.uk)

I would be delighted to tell you more
Tim Perks
020 7871 5065
tim.perks@knightfrank.com



Fixtures and fittings: A list of the fitted carpets, curtains, light fittings and other items fixed to the property which are included in the sale (or may be available by separate negotiation) will be provided by the Seller's Solicitors.
Important Notice: 1. Particulars: These particulars are not an offer or contract, nor part of one. You should not rely on statements by Knight Frank LLP in the particulars or by word of mouth or in writing ("information") as being factually accurate about the property, its condition or its value. Neither Knight Frank LLP nor any joint agent has any authority to make any representations about the property, and accordingly any information given is entirely without responsibility on the part of the agents, seller(s) or lessor(s). 2. Photos, Videos etc: The photographs, property videos and virtual viewings etc. show only certain parts of the property as they appeared at the time they were taken. Areas, measurements and distances given are approximate only. 3. Regulations etc: Any reference to alterations to, or use of, any part of the property does not mean that any necessary planning, building regulations or other consent has been obtained. A buyer or lessee must find out by inspection or in other ways that these matters have been properly dealt with and that all information is correct. 4. VAT: The VAT position relating to the property may change without notice. 5. To find out how we process Personal Data, please refer to our Group Privacy Statement and other notices at <https://www.knightfrank.com/legals/privacy-statement>.
Particulars dated June 2023. Photographs and videos dated June 2023.

Knight Frank is the trading name of Knight Frank LLP. Knight Frank LLP is a limited liability partnership registered in England and Wales with registered number OC305934. Our registered office is at 55 Baker Street, London W1U 8AN where you may look at a list of members' names. If we use the term 'partner' when referring to one of our representatives, that person will either be a member, employee, worker or consultant of Knight Frank LLP and not a partner in a partnership. If you do not want us to contact you further about our services then please contact us by either calling 020 3544 0692, email to marketing.help@knightfrank.com or post to our UK Residential Marketing Manager at our registered office (above) providing your name and address.