

# Connaught Place, Hyde Park W2

---



# Connaught Place, Hyde Park W2

Offering spectacular views over Hyde Park this well presented fourth floor apartment provides spacious internal accommodation of approximately (82.7 sq m sq/890 sqft).

Entered on the fourth floor, via lift, there are three storage cupboards accessed from the entry hallway which leads to the open plan reception room that boasts ample space for dining, a well equipped, modern gloss kitchen and park views.

Elsewhere there is a generous bedroom with one wall set aside to built-in wardrobes and the same park views can be appreciated from this room. Finally there is a fully tiled family bathroom with bath tub and separate shower.



**Asking price:** £1,350,000

**Tenure:** Leasehold: approximately 85 years remaining

**Service charge:** £9,353 per annum, reviewed year, next review due 2025

**Ground rent:** £1,000 per annum, reviewed every 25 years, next review due 2034

**Local authority:** City of Westminster

**Council tax band:** G





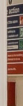
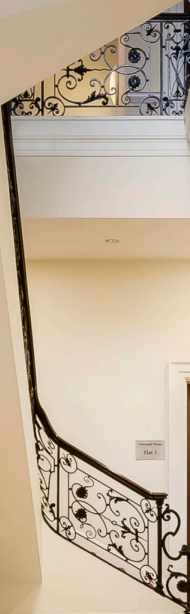



## Location

Located on the edge of Hyde Park, London's largest and most famous Royal Park, Connaught Place is situated in a highly sought-after London location, close to the extensive shopping and exclusive restaurants provided by Oxford Street and Connaught Village. Notting Hill, Mayfair and Knightsbridge are also close by.

Local transport links include Marble Arch (Central line) underground station, Paddington Mainline (Heathrow Express, Network Rail) and underground (Elizabeth, Circle, District, Hammersmith & City, Bakerloo line) stations.



# Connaught Place, W2

Approximate Gross Internal Area = 82.7 sq m / 890.2 sq ft



This plan is for guidance only and must not be relied upon as a statement of fact. Attention is drawn to the important notice on the last page of the text of the Particulars.

**Fourth Floor**

**Knight Frank**  
**Hyde Park**  
1 Craven Terrace  
London  
W2 3QD  
[knightfrank.co.uk](https://www.knightfrank.co.uk)

I would be delighted to tell you more  
**Mark Ruffell**  
020 3697 8234  
[mark.ruffell@knightfrank.com](mailto:mark.ruffell@knightfrank.com)



Fixtures and fittings: A list of the fitted carpets, curtains, light fittings and other items fixed to the property which are included in the sale (or may be available by separate negotiation) will be provided by the Seller's Solicitors.

Important Notice: 1. Particulars: These particulars are not an offer or contract, nor part of one. You should not rely on statements by Knight Frank LLP in the particulars or by word of mouth or in writing ("information") as being factually accurate about the property, its condition or its value. Neither Knight Frank LLP nor any joint agent has any authority to make any representations about the property, and accordingly any information given is entirely without responsibility on the part of the agents, seller(s) or lessor(s). 2. Photos, Videos etc: The photographs, property videos and virtual viewings etc. show only certain parts of the property as they appeared at the time they were taken. Areas, measurements and distances given are approximate only. 3. Regulations etc: Any reference to alterations to, or use of, any part of the property does not mean that any necessary planning, building regulations or other consent has been obtained. A buyer or lessee must find out by inspection or in other ways that these matters have been properly dealt with and that all information is correct. 4. VAT: The VAT position relating to the property may change without notice. 5. To find out how we process Personal Data, please refer to our Group Privacy Statement and other notices at <https://www.knightfrank.com/legals/privacy-statement>. Particulars dated February 2024. Photographs and videos dated February 2024.

Knight Frank is the trading name of Knight Frank LLP. Knight Frank LLP is a limited liability partnership registered in England and Wales with registered number OC305934. Our registered office is at 55 Baker Street, London W1U 8AN where you may look at a list of members' names. If we use the term 'partner' when referring to one of our representatives, that person will either be a member, employee, worker or consultant of Knight Frank LLP and not a partner in a partnership. If you do not want us to contact you further about our services then please contact us by either calling 020 3544 0692, email to [marketing.help@knightfrank.com](mailto:marketing.help@knightfrank.com) or post to our UK Residential Marketing Manager at our registered office (above) providing your name and address.