

TO LET.

Second Floor Office Building.



Adsetts House, 16 Europa View, Sheffield Business Park, Sheffield, S9 1XH
6,917sqft (642.6sqm).

Location.

Adsetts House forms part of the successful Sheffield Business Park with good connectivity to both J33 and J34 of the M1. Occupiers on the estate include South Yorkshire Police, Fulcrum, Lab Logic, TNS and University of Sheffield to name but a few. The University of Sheffield have significantly invested at this location with their factory 2050 and also purchased Phase 2 land of circa 50 acre.

The property is within the wider Advanced Manufacturing and Innovation District, linked with the Advanced Manufacturing Park which has seen inward investment from the likes of McLaren, Rolls Royce and Boeing. As well as affording good access to the motorway network via J33 and J34 of the M1, the development has good communication links with the South Yorkshire region including Rotherham, Barnsley and Doncaster, as well as being approximately 6 miles from Sheffield City Centre.

Description.

Adsetts House is a purpose built 3 storey modern office building. To the rear of the building is a dedicated car park with barrier entrance which can be allocated on a pro-rata basis. Note: additional car parking is available in an adjacent car park on a separate license agreement.

Internally, the building has a shared entrance reception with feature core with staircase and lift access to the upper floors. There are accessible, ladies and gents toilets are also within this area.

The second floor office comprises a modern rectangular floor plate which provides flexible office accommodation, and the suite, although predominantly open plan does have a kitchen/breakout area, two phone/teams booths and two 6 person meeting rooms. The rest of the office is open plan with seating for 127 desk stations

Subject to Contract.

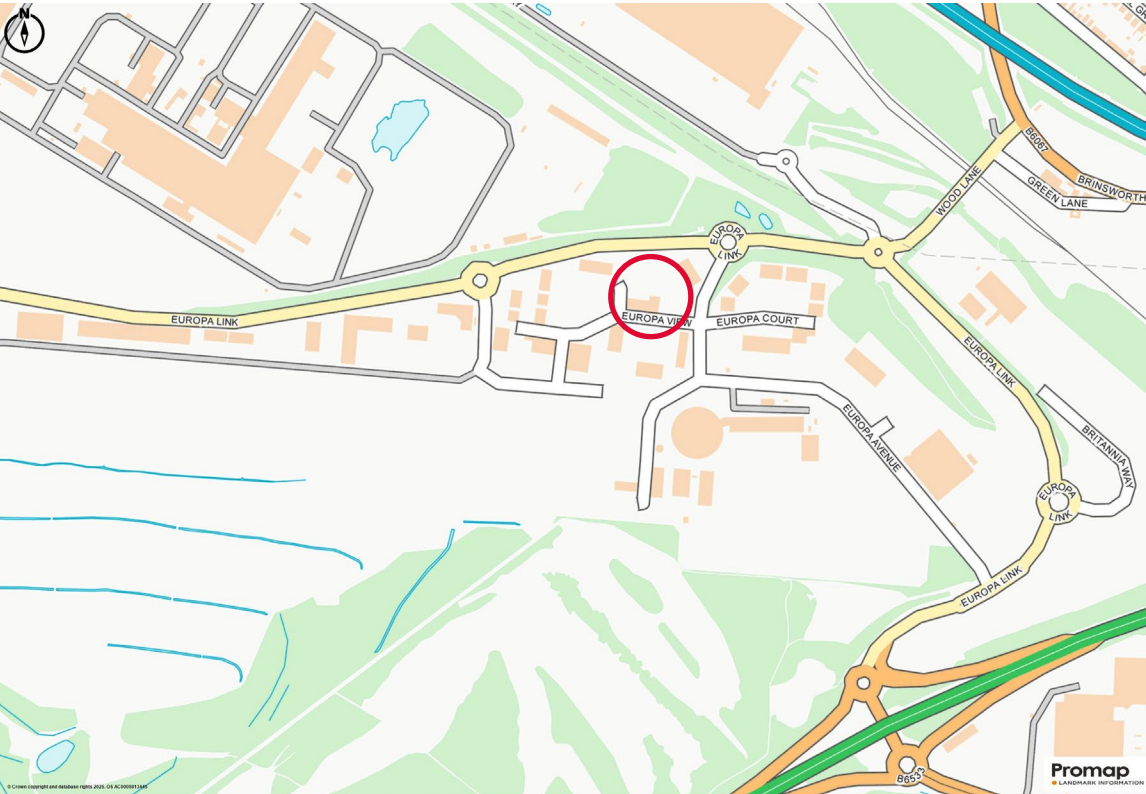
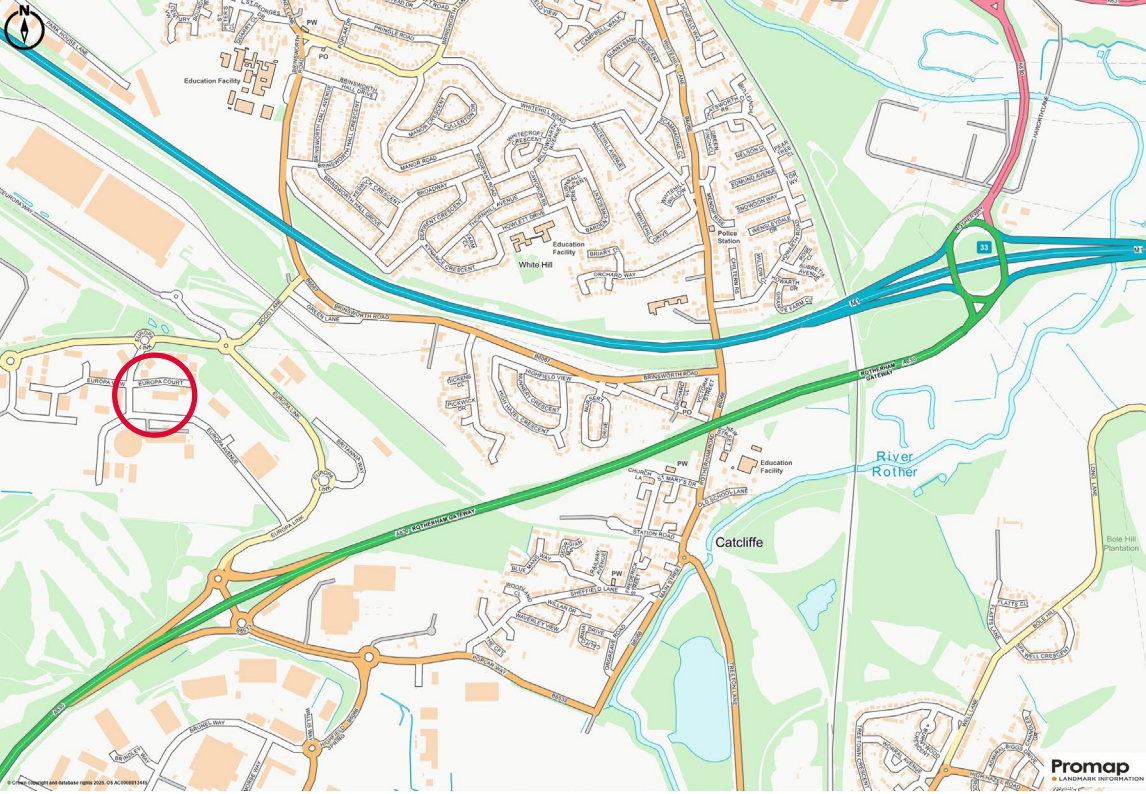

Specification

- Double glazed windows
- Raised access floor
- Suspended ceiling with LED lighting
- Comfort cooled

Accommodation.

We understand the property comprises a Net Internal Area of approximately 6,917 sq ft (642.6 sq m).

Quoting Rent.

Further information on application.

Terms.

The accommodation is available to let by way of a new Full Repairing and Insuring (FRI) Lease on terms to be agreed.

Service Charge.

A service charge is payable to cover the maintenance and upkeep of the common areas of the building and a general wider estate service charge.

Rateable Value.

The property has a Rateable Value of £260,000 for the whole building. Interested parties are advised to make their own enquiries with the Rating Department of the Local Authority.

Services.

We confirm we have not tested any of the service installations and any occupier must satisfy themselves as to the state and condition of such items.

EPC.

The property has an Energy Performance Certificate (EPC) rating of B43.

VAT.

All figures quoted are subject to VAT at the prevailing rate where applicable.

Costs.

Each party is to be responsible for their own legal costs incurred in any transaction.

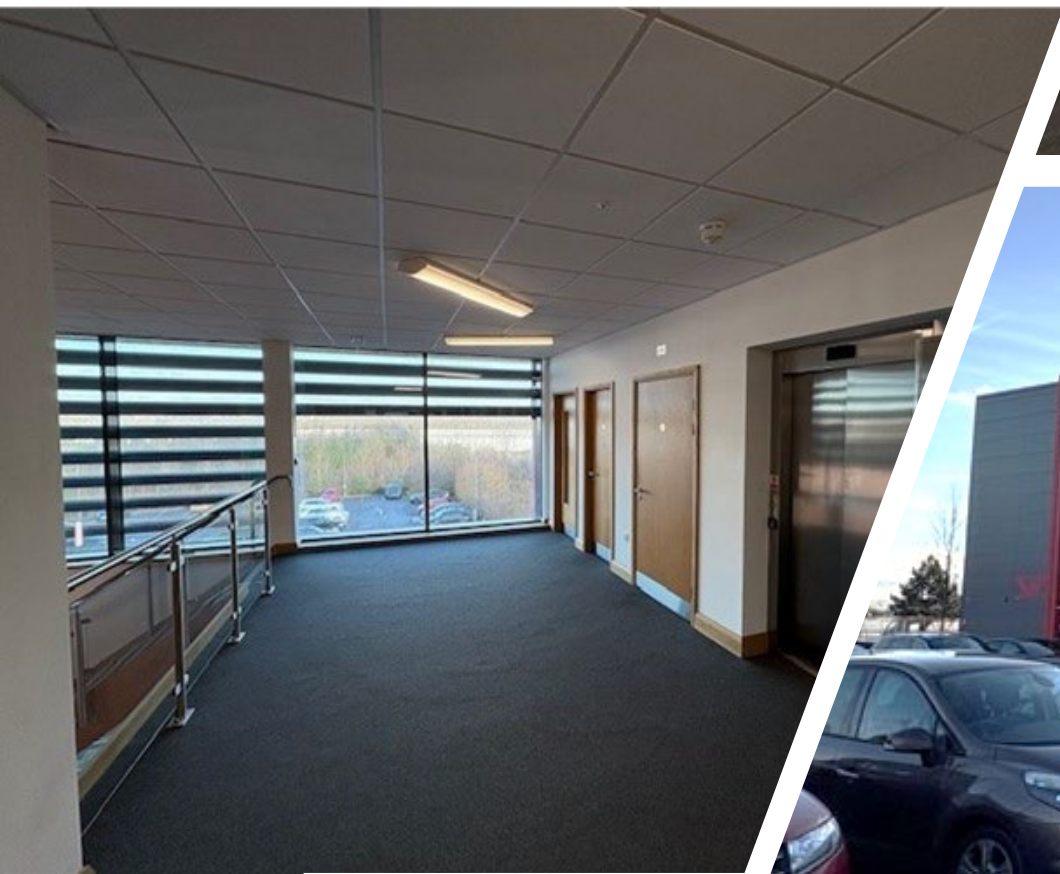

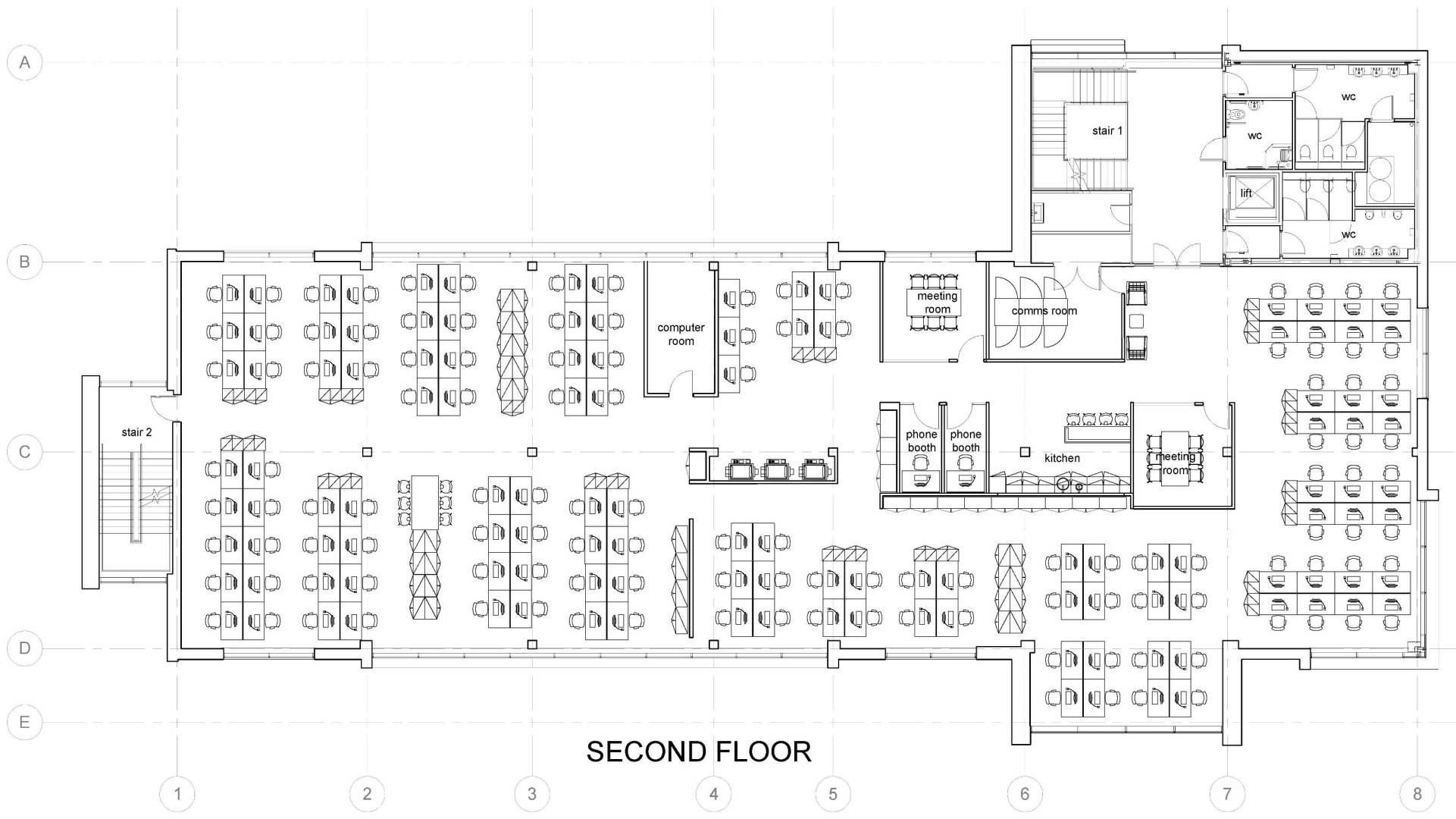

SECOND FLOOR

NOTE: Not to scale - for seating plans only.

Contact.



For further information, or to arrange a viewing, please contact joint agents:

KNIGHT FRANK

Peter Whiteley

+44 114 272 9750

+44 7979 530 416

peter.whiteley@knightfrank.com

CROSTHWAITE COMMERCIAL

Mark Holmes

+44 114 272 3888

+44 7738275226

mark@crosthwaitecommercial.com

Important Notice

1. Particulars: These particulars are not an offer or contract, nor part of one. Any information about price or value contained in the particulars is provided purely as guidance, it does not constitute a formal valuation and should not be relied upon for any purpose. You should not rely on statements by Knight Frank in the particulars or by word of mouth or in writing ("information") as being factually accurate about the property, its condition or its value. Neither Knight Frank LLP nor any joint agent has any authority to make any representations about the property. No responsibility or liability is or will be accepted by Knight Frank LLP, seller(s) or lessor(s) in relation to the adequacy, accuracy, completeness or reasonableness of the information, notice or documents made available to any interested party or its advisers in connection with the proposed transaction. All and any such responsibility and liability is expressly disclaimed.
2. (Photos, Videos etc: The photographs, images, property videos and virtual viewings etc. show only certain parts of the property as they appeared at the time they were taken. Areas, measurements and distances given are approximate only.
3. Regulations: Any reference to alterations to, or use of, any part of the property does not mean that any necessary planning, building regulations or other consent has been obtained. A buyer or lessee must find out by inspection or in other ways that these matters have been properly dealt with and that all information is correct.
4. VAT: The VAT position relating to the property may change without notice.
5. Financial Crime: In accordance with the Money Laundering, Terrorist Financing and Transfer of Funds (Information on the Payer) Regulations 2017 and Proceeds of Crime Act 2002 Knight Frank LLP may be required to establish the identity and source of funds of all parties to property transactions.
6. To find out how we process Personal Data, please refer to our Group Privacy Statement and other notices at <https://www.knightfrank.com/legals/privacy-statement>.

Particulars dated 7 March 2025.. Photographs dated January 2025.

Knight Frank is the trading name of Knight Frank LLP. Knight Frank LLP is a limited liability partnership registered in England and Wales with registered number OC305934. Our registered office is at 55 Baker Street, London W1U 8AN where you may look at a list of members' names. If we use the term 'partner' when referring to one of our representatives, that person will either be a member, employee, worker or consultant of Knight Frank LLP and not a partner in a partnership.

[knightfrank.co.uk](https://www.knightfrank.co.uk)

Connecting people
& property, perfectly.

