



Highbury Grove, Highbury, London N5

---



# Highbury Grove, Highbury, London N5

This exceptional, light-filled apartment spans approximately 1,100 sqft of thoughtfully designed lateral space within a striking Georgian conversion. Ideally situated just moments from Highbury Barn, it directly overlooks the picturesque Highbury Fields.

The property is generously proportioned, featuring a large entrance hallway that sets the tone for the rest of the property. A vast reception room with dual opening doors seamlessly connects to outdoor space. The separate kitchen, equally with its own access to outdoor, patio dining space.

Completing the property are two sizeable bedrooms with ample storage space and a well-appointed family bathroom.

The property also comes with a private parking space.



**Guide price:** £1,000,000

**Tenure:** Leasehold: approximately 99 years remaining

**Service charge:** £1,200 per annum, reviewed annually, next review due 2025

**Ground rent:** £350 per annum, reviewed every 25 years, next review due 2049

**Local authority:** London Borough of Islington

**Council tax band:** E





## Location

Highbury Grove is enviably located across from Highbury Fields, offering greenery and sporting amenities. Highbury Barn offers a selection of restaurants, wine bars, coffee shops and delicatessens. Highbury and Islington station (Victoria Line/Overground services/ Great Northern) is located 0.5 miles from the property.



# Highbury Grove, N5

○ - Ceiling Height

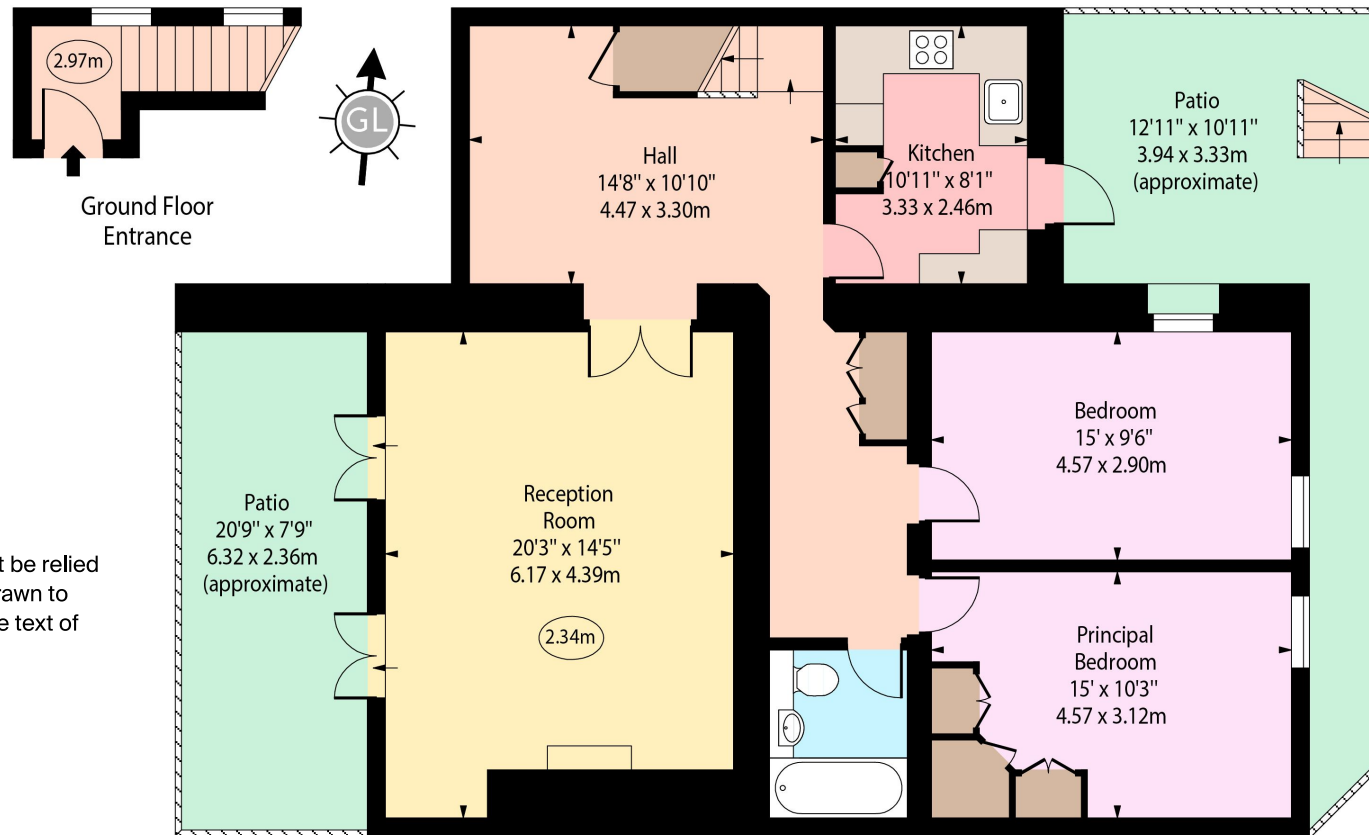

Lower Ground Floor

Approx Gross Internal Area 1100 Sq Ft - 102.19 Sq M

This plan is for guidance only and must not be relied upon as a statement of fact. Attention is drawn to the important notice on the last page of the text of the Particulars.

**Knight Frank**  
 Islington & King's Cross  
 Sales  
 321-322 Upper Street  
 London N1 2XQ  
[knightfrank.co.uk](http://knightfrank.co.uk)

I would be delighted to tell you more  
**Megan Squire**  
 +44 20 3657 7352  
[megan.squire@knightfrank.com](mailto:megan.squire@knightfrank.com)



Fixtures and fittings: A list of the fitted carpets, curtains, light fittings and other items fixed to the property which are included in the sale (or may be available by separate negotiation) will be provided by the Seller's Solicitors.  
 Important Notice: 1. Particulars: These particulars are not an offer or contract, nor part of one. You should not rely on statements by Knight Frank LLP in the particulars or by word of mouth or in writing ("information") as being factually accurate about the property, its condition or its value. Neither Knight Frank LLP nor any joint agent has any authority to make any representations about the property, and accordingly any information given is entirely without responsibility on the part of the agents, seller(s) or lessor(s). 2. Photos, Videos etc: The photographs, property videos and virtual viewings etc. show only certain parts of the property as they appeared at the time they were taken. Areas, measurements and distances given are approximate only. 3. Regulations etc: Any reference to alterations to, or use of, any part of the property does not mean that any necessary planning, building regulations or other consent has been obtained. A buyer or lessee must find out by inspection or in other ways that these matters have been properly dealt with and that all information is correct. 4. VAT: The VAT position relating to the property may change without notice. 5. To find out how we process Personal Data, please refer to our Group Privacy Statement and other notices at <https://www.knightfrank.com/legals/privacy-statement>.  
 Particulars dated December 2024. Photographs and videos dated December 2024.  
 Knight Frank is the trading name of Knight Frank LLP. Knight Frank LLP is a limited liability partnership registered in England and Wales with registered number OC305934. Our registered office is at 55 Baker Street, London W1U 8AN where you may look at a list of members' names. If we use the term 'partner' when referring to one of our representatives, that person will either be a member, employee, worker or consultant of Knight Frank LLP and not a partner in a partnership. If you do not want us to contact you further about our services then please contact us by either calling 020 3544 0692, email to [marketing.help@knightfrank.com](mailto:marketing.help@knightfrank.com) or post to our UK Residential Marketing Manager at our registered office (above) providing your name and address.