

Grosvenor Avenue, N5

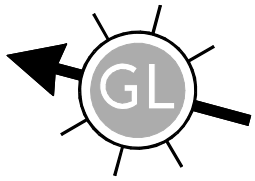

○ - Ceiling Height

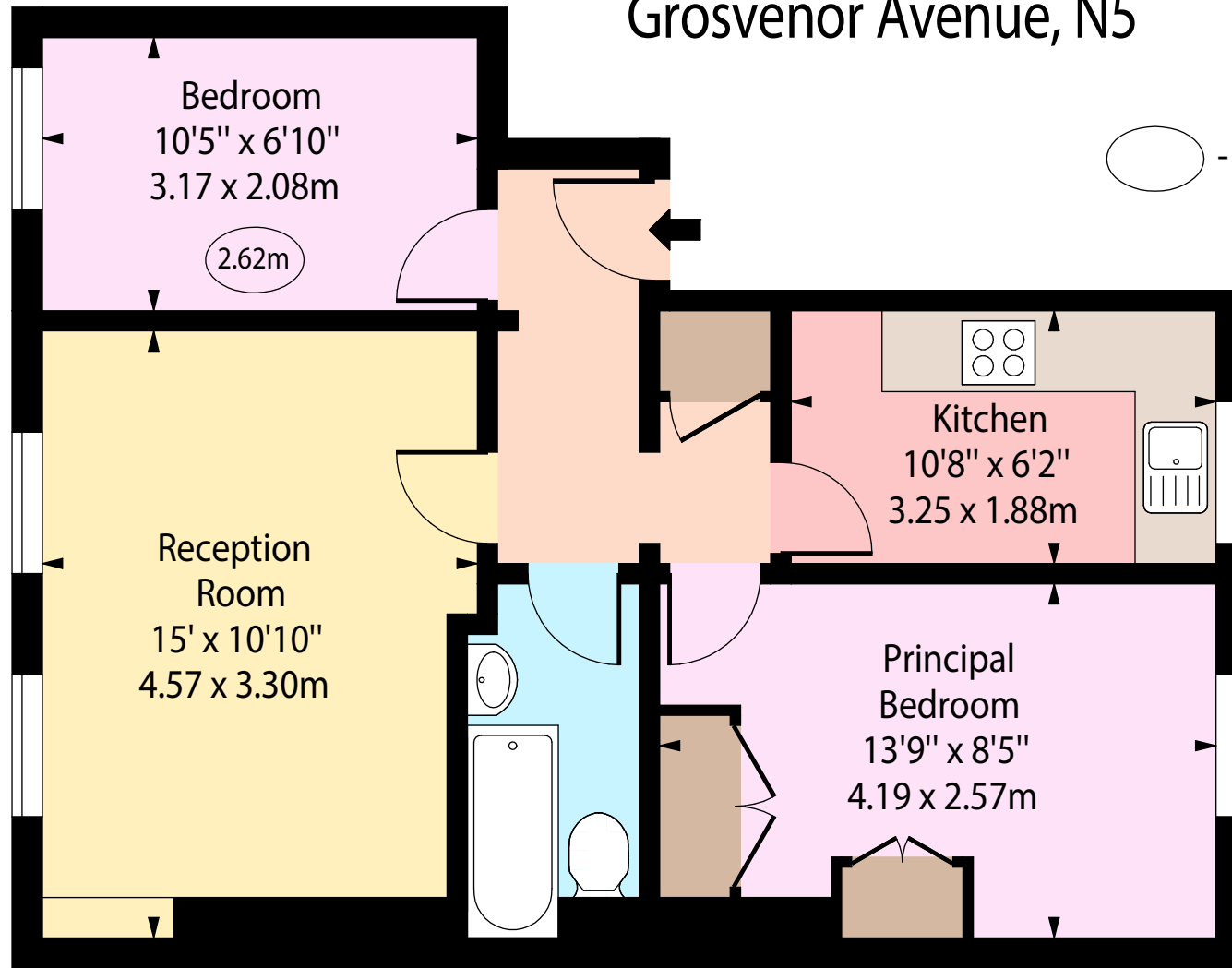

Second Floor

Approx Gross Internal Area

536 Sq Ft - 49.79 Sq M

Every attempt has been made to ensure the accuracy of the floor plan shown.
However, all measurements, fixtures, fittings, and data shown are approximate interpretations and
for illustrative purposes only.

Measured according to the RICS IPMS 2. Not To Scale.

www.goldlens.co.uk

Ref. No. 027775E