



Leonard Court, Edwardes Square, Kensington W8

---



# Leonard Court, Kensington, W8

---

A newly refurbished two bedroom apartment in this popular portered Kensington block.

This first floor apartment has been renovated to a high standard and offers good light throughout. The flat features a large living room, separate kitchen, two bedrooms, and one bathroom. The flat also benefits from a long leasehold tenure, and there is a lift in the building.

Leonard Court is situated at the north-east corner of Edwardes Square which is considered to be one of Kensington's finest squares. The apartment benefits from the shopping and transport facilities of High Street Kensington. The open spaces of Holland Park are also nearby.



EPC  
D

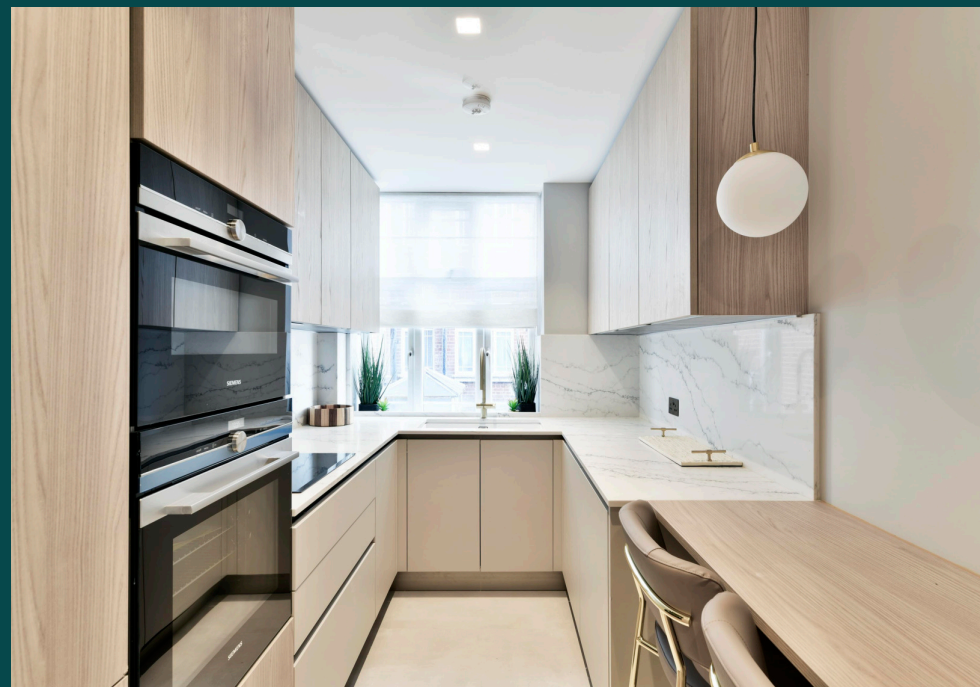









**Leonard Court  
London W8**

**Gross Internal Area = 70 sq. metres  
754 sq. feet**

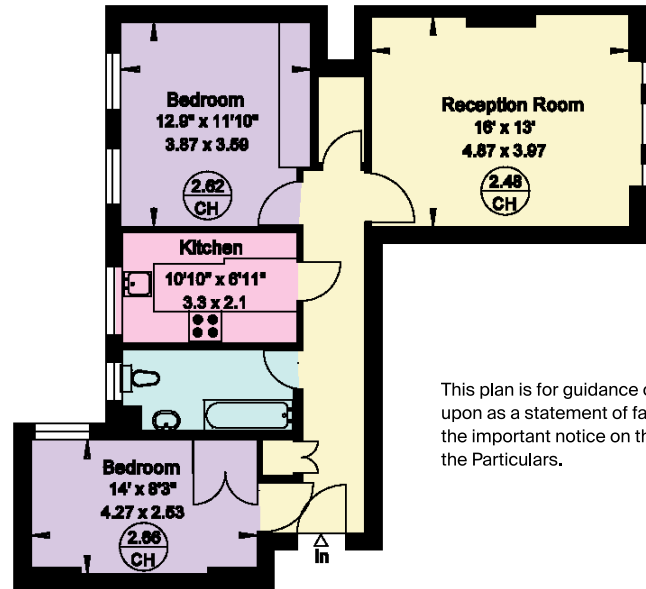

This plan is for guidance only and must not be relied upon as a statement of fact. Attention is drawn to the important notice on the last page of the text of the Particulars.

**First Floor**

**Knight Frank  
Kensington**

United House  
9 Pembridge Road W11 3JY

We would be delighted to te

**Robert French**

020 3892 3576

[knightfrank.co.uk](http://knightfrank.co.uk)

[robert.french@knightfrank.com](mailto:robert.french@knightfrank.com)



As well as rent and the tenancy deposit, tenants who do not have the protection of the Tenant Fees Act 2019 will be asked to pay an administration fee of £288 and referencing fees of £48 per person. All fees shown are inclusive of VAT. Tenants may also be asked to pay a higher deposit if they wish to have a pet if the landlord agrees. Please ask us for more information about other fees that will apply or visit [www.knightfrank.co.uk/tenantfees](http://www.knightfrank.co.uk/tenantfees)

Fixtures and fittings: Carpets, curtains, light fittings and other items fixed to the property (and not fixed to the property) belonging to the landlord are included in any tenancy as evidenced in the inventory, unless specifically noted otherwise. All those items regarded as tenant's fixtures and fittings, are specifically excluded from any tenancy and will not be evidenced in the inventory. Important Notice: 1. Particulars: These particulars are not an offer or contract, nor part of one. You should not rely on statements by Knight Frank LLP in the particulars or by word of mouth or in writing ("information") as being factually accurate about the property, its condition or its value. Neither Knight Frank LLP nor any joint agent has any authority to make any representations about the property, and accordingly any information given is entirely without responsibility on the part of the agents, seller(s) or lessor(s). 2. Photos, Videos etc: The photographs, property videos and virtual viewings etc. show only certain parts of the property as they appeared at the time they were taken. Areas, measurements and distances given are approximate only. 3. Regulations etc: Any reference to alterations to, or use of, any part of the property does not mean that any necessary planning, building regulations or other consent has been obtained. A buyer or lessee must find out by inspection or in other ways that these matters have been properly dealt with and that all information is correct. 4. VAT: The VAT position relating to the property may change without notice. 5. To find out how we process Personal Data, please refer to our Group Privacy Statement and other notices at <https://www.knightfrank.com/legals/privacy-statement>.

Particulars dated October 2021. Photographs and videos dated October 2021.

Knight Frank is the trading name of Knight Frank LLP. Knight Frank LLP is a limited liability partnership registered in England and Wales with registered number OC305934. Our registered office is at 55 Baker Street, London W1U 8AN where you may look at a list of members' names. If we use the term 'partner' when referring to one of our representatives, that person will either be a member, employee, worker or consultant of Knight Frank LLP and not a partner in a partnership. If you do not want us to contact you further about our services then please contact us by either calling 020 3544 0692, email to [marketing.help@knightfrank.com](mailto:marketing.help@knightfrank.com) or post to our UK Residential Marketing Manager at our registered office (above) providing your name and address.