

Palace Gardens Terrace, London W8



One bedroom apartment on Palace Gardens Terrace

Set in a white Stucco fronted villa on one of Kensington's finest roads, this third floor apartment is presented in good order throughout. Offered for sale on a long lease and with no onward chain.

Palace Gardens Terrace is a wide cherry tree lined street of stucco fronted Victorian terrace houses. It runs parallel to Kensington Church Street and Kensington Palace Gardens and is close to the excellent shopping and transport facilities of both Notting Hill Gate and Kensington Gardens are close by.



Guide price: £850,000

Tenure: Leasehold: approximately 981 years remaining

Service charge: £3,278.28 per annum, reviewed yearly, next review due June 2024

Local authority: Royal Borough of Kensington and Chelsea

Council tax band: F







Palace Gardens, London, W8

Approximate Gross Internal Area = 464 sq ft / 43.1 sq m

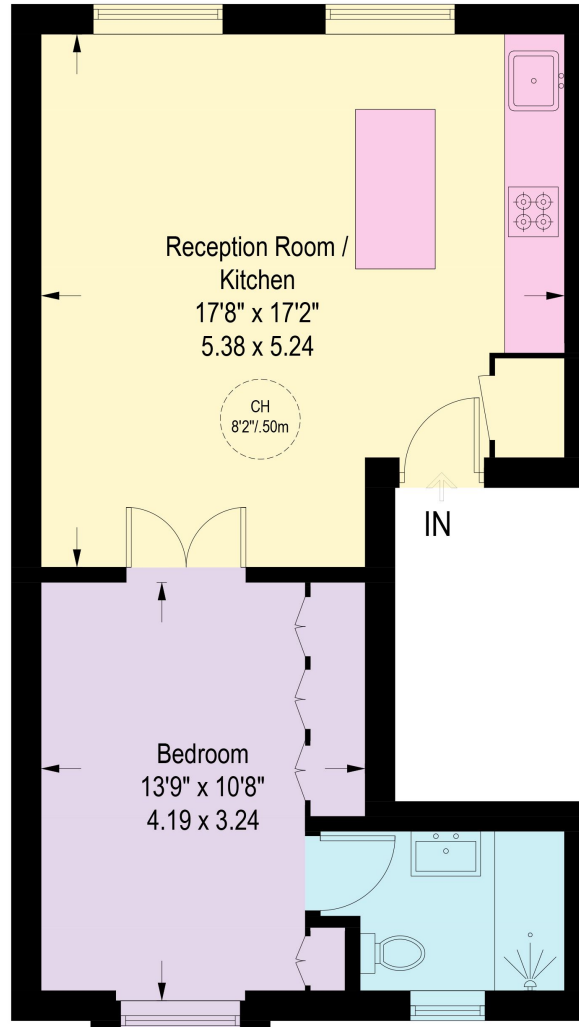

This plan is for guidance only and must not be relied upon as a statement of fact. Attention is drawn to the important notice on the last page of the text of the Particulars.

Third Floor

Knight Frank
Kensington
52-56 Kensington Church Street
W8 4DB
knightfrank.co.uk

I would be delighted to tell you more
Robert French
020 3892 3576
robert.french@knightfrank.com



Fixtures and fittings: A list of the fitted carpets, curtains, light fittings and other items fixed to the property which are included in the sale (or may be available by separate negotiation) will be provided by the Seller's Solicitors.
Important Notice: 1. Particulars: These particulars are not an offer or contract, nor part of one. You should not rely on statements by Knight Frank LLP in the particulars or by word of mouth or in writing ("information") as being factually accurate about the property, its condition or its value. Neither Knight Frank LLP nor any joint agent has any authority to make any representations about the property, and accordingly any information given is entirely without responsibility on the part of the agents, seller(s) or lessor(s). 2. Photos, Videos etc: The photographs, property videos and virtual viewings etc. show only certain parts of the property as they appeared at the time they were taken. Areas, measurements and distances given are approximate only. 3. Regulations etc: Any reference to alterations to, or use of, any part of the property does not mean that any necessary planning, building regulations or other consent has been obtained. A buyer or lessee must find out by inspection or in other ways that these matters have been properly dealt with and that all information is correct. 4. VAT: The VAT position relating to the property may change without notice. 5. To find out how we process Personal Data, please refer to our Group Privacy Statement and other notices at <https://www.knightfrank.com/legals/privacy-statement>.
Particulars dated May 2024. Photographs and videos dated May 2024.
All information is correct at the time of going to print. Knight Frank is the trading name of Knight Frank LLP. Knight Frank LLP is a limited liability partnership registered in England and Wales with registered number OC305934. Our registered office is at 55 Baker Street, London W1U 8AN. We use the term 'partner' to refer to a member of Knight Frank LLP, or an employee or consultant. A list of members names of Knight Frank LLP may be inspected at our registered office. If you do not want us to contact you further about our services then please contact us by either calling 020 3544 0692, email to marketing.help@knightfrank.com or post to our UK Residential Marketing Manager at our registered office (above) providing your name and address.