

Holland Park, London, W8



# A beautiful first floor apartment in Holland Park

---

Set on the first floor of an imposing stucco fronted villa, this apartment spans the depth of the building giving you a unique and bright double aspect. The property benefits from fantastic ceiling heights and extends to 725 sq ft. Accommodation comprises of; grand reception room with large bay window, one double bedroom, bathroom and modern fitted kitchen.



**Guide price:** £1,350,000

**Tenure:** Share of freehold plus leasehold, approximately 974 years remaining

**Service charge:** £3,517 per annum. Reviewed yearly, next review due in March 2024

**Local authority:** Royal Borough of Kensington and Chelsea

**Council tax band:** G







## Location

Holland Park is one of London's famous addresses with access to the park itself located just across the road from the apartment.

Holland Park Avenue offers a wide selection of shops, restaurants and transport connections as Holland Park underground station (Central Line) is close by, giving direct access to the City and West End.

High Street Kensington and Notting Hill Gate are also just a short walk away.





# Holland Park, W11

Approximate Floor Area = 67.4 sq m / 725 sq ft  
Including Limited Use Area (0.4 sq m / 4 sq ft)

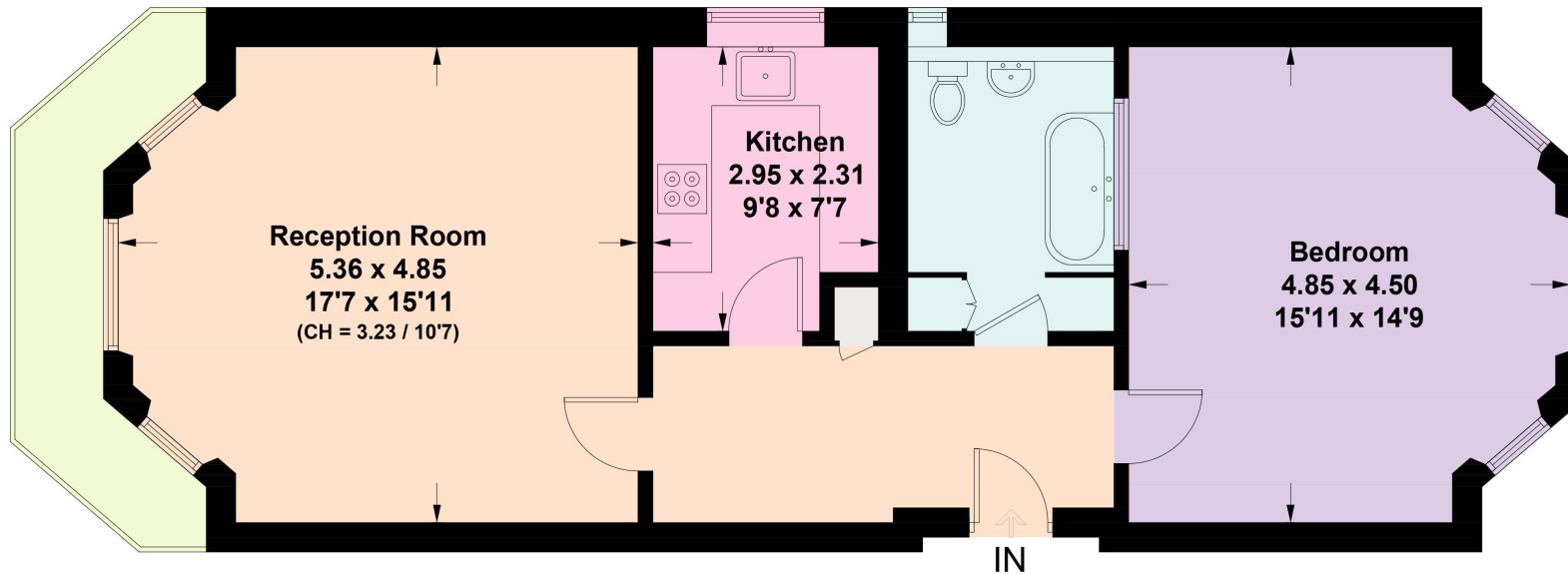

## First Floor

This plan is for guidance only and must not be relied upon as a statement of fact. Attention is drawn to the important notice on the last page of the text of the Particulars.

**Knight Frank**

**Kensington**

52-56 Kensington Church Street

W8 4DB

[knightfrank.co.uk](https://www.knightfrank.co.uk)

I would be delighted to tell you more

**Robert French**

020 3892 3576

[robert.french@knightfrank.com](mailto:robert.french@knightfrank.com)



Fixtures and fittings: A list of the fitted carpets, curtains, light fittings and other items fixed to the property which are included in the sale (or may be available by separate negotiation) will be provided by the Seller's Solicitors.

Important Notice: 1. Particulars: These particulars are not an offer or contract, nor part of one. You should not rely on statements by Knight Frank LLP in the particulars or by word of mouth or in writing ("information") as being factually accurate about the property, its condition or its value. Neither Knight Frank LLP nor any joint agent has any authority to make any representations about the property, and accordingly any information given is entirely without responsibility on the part of the agents, seller(s) or lessor(s). 2. Photos, Videos etc: The photographs, property videos and virtual viewings etc. show only certain parts of the property as they appeared at the time they were taken. Areas, measurements and distances given are approximate only. 3. Regulations etc: Any reference to alterations to, or use of, any part of the property does not mean that any necessary planning, building regulations or other consent has been obtained. A buyer or lessee must find out by inspection or in other ways that these matters have been properly dealt with and that all information is correct. 4. VAT: The VAT position relating to the property may change without notice. 5. To find out how we process Personal Data, please refer to our Group Privacy Statement and other notices at <https://www.knightfrank.com/legals/privacy-statement>. Particulars dated February 2024. Photographs and videos dated February 2024.

All information is correct at the time of going to print. Knight Frank is the trading name of Knight Frank LLP. Knight Frank LLP is a limited liability partnership registered in England and Wales with registered number OC305934. Our registered office is at 55 Baker Street, London W1U 8AN. We use the term 'partner' to refer to a member of Knight Frank LLP, or an employee or consultant. A list of members names of Knight Frank LLP may be inspected at our registered office. If you do not want us to contact you further about our services then please contact us by either calling 020 3544 0692, email to [marketing.help@knightfrank.com](mailto:marketing.help@knightfrank.com) or post to our UK Residential Marketing Manager at our registered office (above) providing your name and address.