



Copenhagen Gardens, Chiswick W4



# Copenhagen Gardens, Chswick W4

Three bedroom freehold house with garage, and off street parking in this secure gated development

Copenhagen Gardens is conveniently located in the sought after Bedford Park Borders, Chiswick. Southfield Primary School (Ofsted Outstanding in May 2023,) is close by, as is the transport links of Turnham Green Station and Chiswick Park Station. The leafy parks of Southfield Rec Ground, Acton Green Common are short walk away as is the amenities of Chiswick High St.



**Offers in excess of:** £1,000,000

**Local authority:** London Borough of Ealing

**Council tax band:** E



This three-bedroom, mid terrace freehold house measures close to 1300sqft and has been contemporarily refurbished throughout. At the front of the property, you enter a wide hallway space, providing a welcoming space to enter.

A separate kitchen to the right has been recently refurbished and has all the integrated appliances one would expect including dishwasher and plenty of storage space. Facing out to the rear of the property the owners have extended the reception space by constructing a light and bright orangery providing the perfect entertaining space via its south facing aspect. Exiting directly from the orangery is private sun drenched south facing paved garden which connects the main house to the rear studio, which is an ideal working from home space. The whole of the ground floor has wooden flooring (with underfloor heating) and a neutral decor palate making it ideal to move straight in.

On the first floor the property has the principal bedroom complete with fitted wardrobes, the family bathroom and a second double bedroom. The loft has also been converted to provide a third double bedroom.







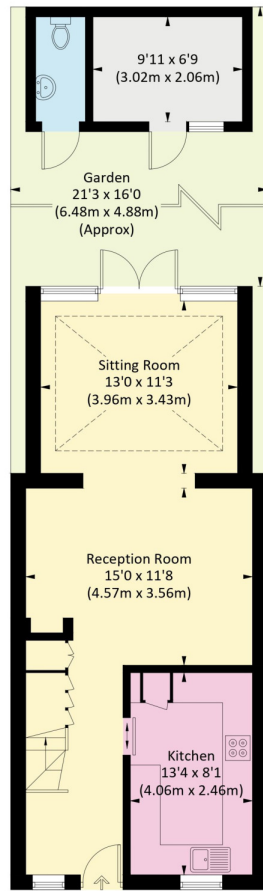

**Ground Floor**  
(542 Sq Ft.)

## COPENHAGEN GARDENS

Approx. gross internal area 1269 Sq Ft. / 117.9 Sq M  
(Including Eaves)  
Outbuildings Approx. gross internal area 226 Sq Ft. / 21.0 Sq M  
Total 1495 Sq Ft. / 138.9 Sq M



This plan is for guidance only and must not be relied upon as a statement of fact. Attention is drawn to the important notice on the last page of the text of the Particulars.

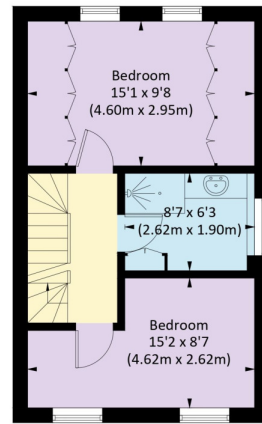

**First Floor**  
(380 Sq Ft.)

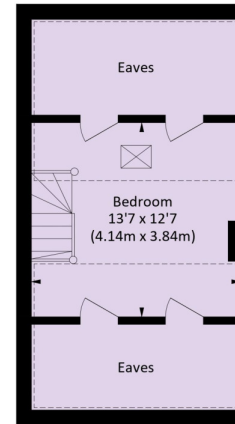

**Second Floor (Including Eaves)**  
(347 Sq Ft.)

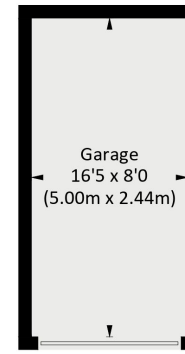

**Garage**  
(16'5 x 8'0)  
(5.00m x 2.44m)  
(Not Shown In Actual Location / Orientation)

**Knight Frank**

Chiswick

64 Turnham Green Terrace

W4 1QN

[knightfrank.co.uk](http://knightfrank.co.uk)

I would be delighted to tell you more

**Lewin Craig-Corbett**

020 3927 6315

[lewin.craig-corbett@knightfrank.com](mailto:lewin.craig-corbett@knightfrank.com)



Fixtures and fittings: A list of the fitted carpets, curtains, light fittings and other items fixed to the property which are included in the sale (or may be available by separate negotiation) will be provided by the Seller's Solicitors.

Important Notice: 1. Particulars: These particulars are not an offer or contract, nor part of one. You should not rely on statements by Knight Frank LLP in the particulars or by word of mouth or in writing ("information") as being factually accurate about the property, its condition or its value. Neither Knight Frank LLP nor any joint agent has any authority to make any representations about the property, and accordingly any information given is entirely without responsibility on the part of the agents, seller(s) or lessor(s). 2. Photos, Videos etc: The photographs, property videos and virtual viewings etc. show only certain parts of the property as they appeared at the time they were taken. Areas, measurements and distances given are approximate only. 3. Regulations etc: Any reference to alterations to, or use of, any part of the property does not mean that any necessary planning, building regulations or other consent has been obtained. A buyer or lessee must find out by inspection or in other ways that these matters have been properly dealt with and that all information is correct. 4. VAT: The VAT position relating to the property may change without notice. 5. To find out how we process Personal Data, please refer to our Group Privacy Statement and other notices at <https://www.knightfrank.com/legals/privacy-statement>.

Particulars dated September 2024. Photographs and videos dated July 2024.

All information is correct at the time of going to print. Knight Frank is the trading name of Knight Frank LLP. Knight Frank LLP is a limited liability partnership registered in England and Wales with registered number OC305934. Our registered office is at 55 Baker Street, London W1U 8AN. We use the term 'partner' to refer to a member of Knight Frank LLP, or an employee or consultant. A list of members names of Knight Frank LLP may be inspected at our registered office. If you do not want us to contact you further about our services then please contact us by either calling 020 3544 0692, email to [marketing.help@knightfrank.com](mailto:marketing.help@knightfrank.com) or post to our UK Residential Marketing Manager at our registered office (above) providing your name and address.