

# Wendover Court Marylebone W1





Tenure: Leasehold, approximately  
125 years remaining  
Local Authority: City of  
Westminster



A delightful two bedroom flat situated on the first floor of a charming red brick building in the heart of Marylebone Village.

The flat offers well-balanced accommodation and comprises a reception/dining area, perfect for entertaining, contemporary kitchen, two good-sized bedrooms with built-in storage and a bathroom. The apartment also benefits from large windows, providing excellent natural light.

Wendover Court is perfectly positioned on Chiltern Street, in the heart of Marylebone. Located moments from the fashionable and desirable boutiques and restaurants of Marylebone High Street, and also only a short distance from the hustle and bustle of Oxford Street.





# Wendover Court, W1U

Approximate Gross Internal Area = 817 sq ft / 75.9 sq m

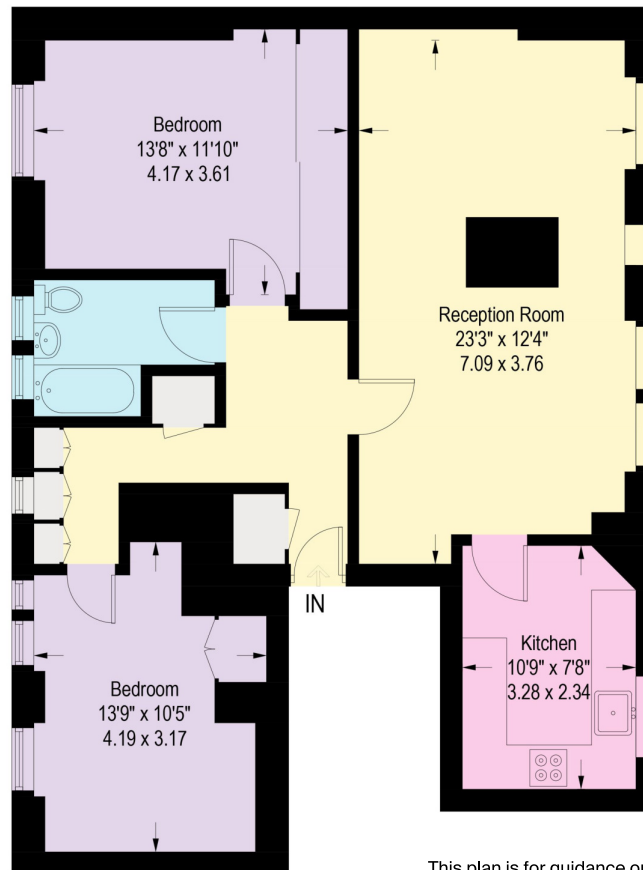

First Floor

This plan is for guidance only and must not be relied upon as a statement of fact. Attention is drawn to the Important Notice on the last page of the text of the Particulars

Knight Frank  
Marylebone  
55 Baker Street  
London W1U 8EW

**I would be delighted to tell you more.**

**Ali Mathews**  
020 3435 6443  
ali.mathews@knightfrank.com

[knightfrank.co.uk](https://www.knightfrank.co.uk)



**Connecting people & property, perfectly.**

Fixtures and fittings: A list of the fitted carpets, curtains, light fittings and other items fixed to the property which are included in the sale (or may be available by separate negotiation) will be provided by the Seller's Solicitors.

Important Notice: 1. Particulars: These particulars are not an offer or contract, nor part of one. You should not rely on statements by Knight Frank LLP in the particulars or by word of mouth or in writing ("information") as being factually accurate about the property, its condition or its value. Neither Knight Frank LLP nor any joint agent has any authority to make any representations about the property, and accordingly any information given is entirely without responsibility on the part of the agents, seller(s) or lessor(s). 2. Photos, Videos etc: The photographs, property videos and virtual viewings etc. show only certain parts of the property as they appeared at the time they were taken. Areas, measurements and distances given are approximate only. 3. Regulations etc: Any reference to alterations to, or use of, any part of the property does not mean that any necessary planning, building regulations or other consent has been obtained. A buyer or lessee must find out by inspection or in other ways that these matters have been properly dealt with and that all information is correct. 4. VAT: The VAT position relating to the property may change without notice. 5. To find out how we process Personal Data, please refer to our Group Privacy Statement and other notices at <https://www.knightfrank.com/legals/privacy-statement>.

Particulars dated Feb 2021. Photographs and videos dated Feb 2021.

Knight Frank is the trading name of Knight Frank LLP. Knight Frank LLP is a limited liability partnership registered in England and Wales with registered number OC305934. Our registered office is at 55 Baker Street, London W1U 8AN where you may look at a list of members' names. If we use the term 'partner' when referring to one of our representatives, that person will either be a member, employee, worker or consultant of Knight Frank LLP and not a partner in a partnership. If you do not want us to contact you further about our services then please contact us by either calling 020 3544 0692, email to [marketing.help@knightfrank.com](mailto:marketing.help@knightfrank.com) or post to our UK Residential Marketing Manager at our registered office (above) providing your name and address.