

2 bedroom flat to rent

Fitzclarence House, Holland Park Avenue, London, W11

Let Agreed
£575 pw
tenancy info

Print







Property Description

Letting information:

Furnishing:

Furnished

Reduced on Rightmove:

02 October 2020 (577 days ago)

Key features

■ Newly Redecorated

■ Bright and Spacious

■ Balcony

■ Lift

■ Great Location

Full description

A spacious, bright and beautifully refurbished two double bedroom apartment with plenty of lateral space. Located on the third floor (with lift) of this purpose built building and situated within the leafy green area of Holland Park. This property is a short walk from Holland Park tube station, and all of the amenities of Notting Hill Gate and High Street Kensington.

Energy Performance Certificate (EPC) graphs

See full size version online



Floorplans

Master Floorplan Image



Fitzclarence House, W11

Approximate Gross Internal Area 75.2 sq m (809 sq ft)

Approximate Area of Balcony 3.1 sq m (33 sq ft)

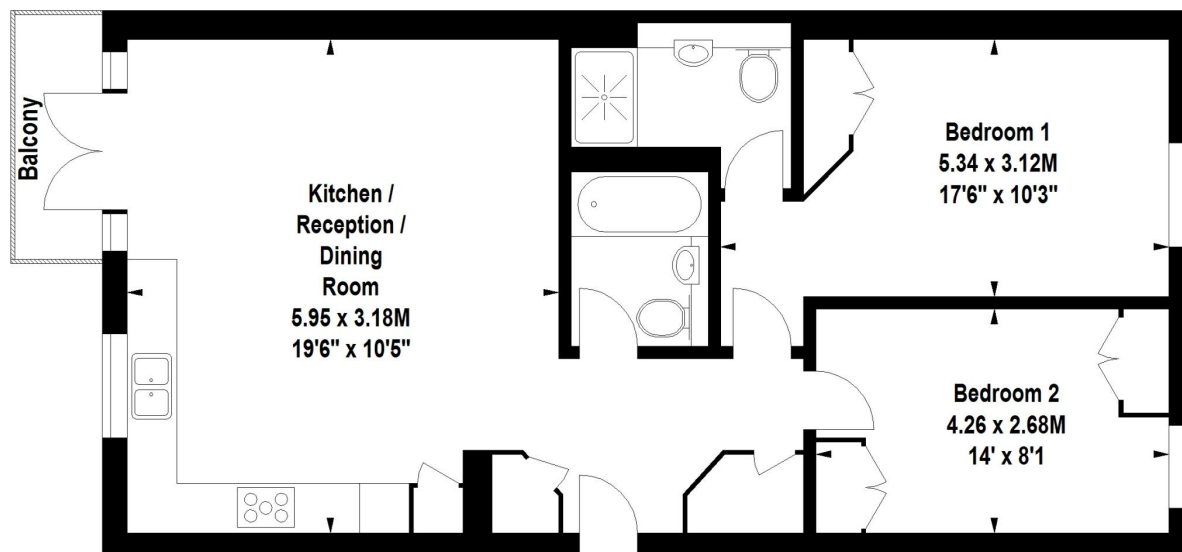

Third Floor

hydepark@cluttons.com

020 7262 2226

[cluttons.com](https://www.cluttons.com)

Floor Plan produced for Cluttons by Mays Floorplans © . Tel 020 3397 4594

Illustration for identification purposes only, not to scale

All measurements are maximum, and include wardrobes and window bays where applicable

map view

street view

Note: The pin shows the centre of the property's postcode, and does not pinpoint the exact address The pin shows the exact address of the property Street View is unavailable in this location You're in the centre of the property's postcode. Start exploring the local area from here. Take me back to the start

Disclaimer - Permitted payments may apply when renting a property in England or Wales. For more details please go to the Tenancy Info link (alongside the advertised rental price) or contact the agent.

Property reference P207245. The information displayed about this property comprises a property advertisement. Rightmove.co.uk makes no warranty as to the accuracy or completeness of the advertisement or any linked or associated information, and Rightmove has no control over the content. This property advertisement does not constitute property particulars. The information is provided and maintained by **Cluttons, Hyde Park - Lettings**.

Please refer to our Renting Guides for further information on how to safely rent a property.

* Average speeds are based on the download speeds of at least 50% of customers at peak time (8pm to 10pm) from packages available on comparethemarket.com. Speed can be affected by a range of technical and environmental factors. The speed you receive where you live may be lower than that listed above. You can check the estimated speed to your property prior to purchasing. Fibre/cable services at your postcode are subject to availability. You can confirm availability on the provider's website. Providers may increase charges. You should have the right to exit your contract without penalty if this happens. The information is provided and maintained by **Decision Technologies Limited**.

Map data ©OpenStreetMap contributors.