



Oakwood, Charlbury, Chipping Norton

Oakwood

Oakwood comes to the market in excellent condition throughout, having been built 5 years ago.

It sits on the outskirts of the popular Cotswold town of Charlbury. The town can be reached by a footpath to the rear of the property.

Charlbury offers a good selection of pubs and basic amenities and direct trains to London Paddington. Soho Farmhouse, Daylesford Organic Farm Shop and Estelle Manor are all within easy reach.



 4/5  3  2  EPC
B

Tenure: Available freehold

Local authority: West Oxfordshire District Council

Council tax band: G



Oakwood is in a small development of just three houses, is south-facing and enjoys wonderful views across the Evenlode Valley. The large kitchen dining area continues into the family snug, measuring 36ft in total, with two sets of French doors opening into the garden.

All four upstairs bedrooms are generous doubles, with one currently being used as a home office. There is an option for a single 5th bedroom downstairs. The principal bedroom is spacious with a dressing room and generous en suite bathroom.

There is underfloor heating downstairs powered by an air source heat pump, which also powers the radiators upstairs.







Location

Town centre and Charlbury Station 0.5 miles

Chipping Norton 6 miles

Woodstock 6 miles

Witney 6 miles

Soho Farmhouse 9 miles

Daylesford Organic Farm Shop 12 miles

Oxford 16 miles

(All distances and times are approximate)

Services

Mains water, electricity and drainage. Air source heat pump. Fibre-optic broadband to the development.



Approximate Gross Internal Area 2963 sq ft – 275 sq m
 Ground Floor Area 1489 sq ft – 138 sq m
 First Floor Area 1474 sq ft – 137 sq m

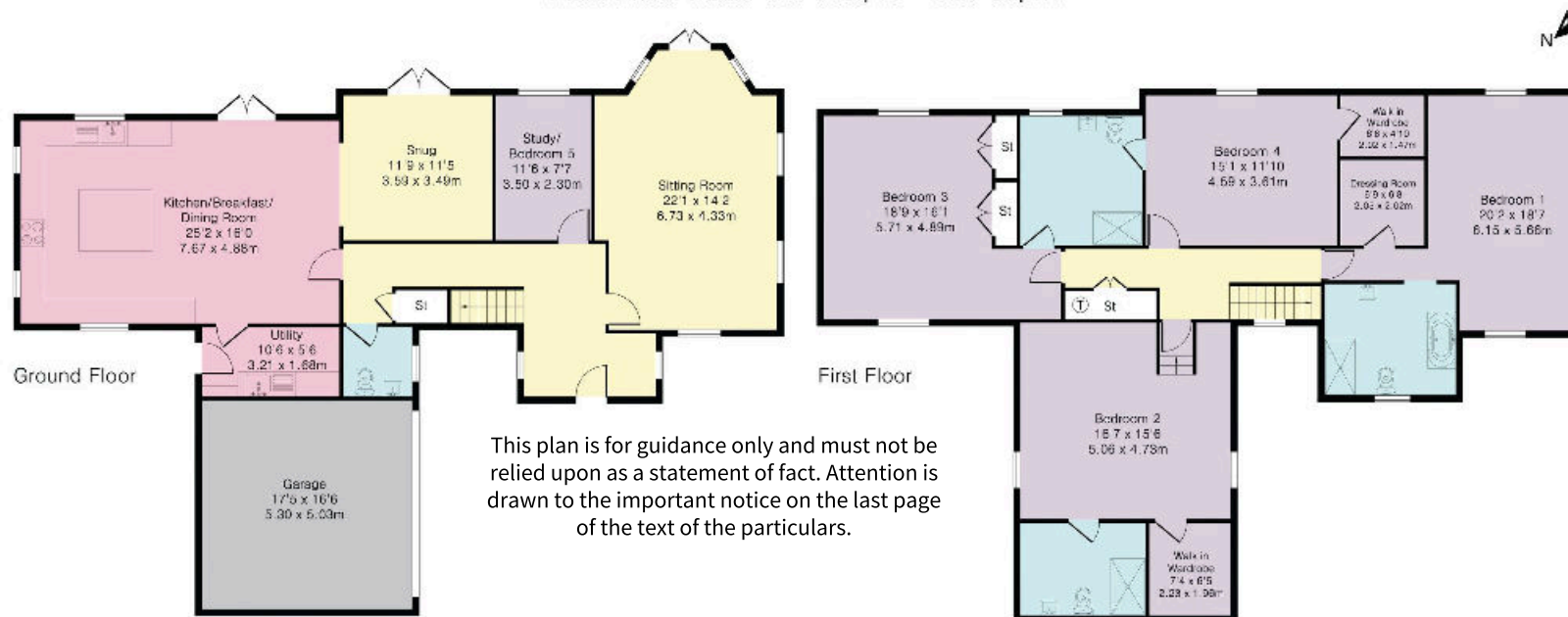

This plan is for guidance only and must not be relied upon as a statement of fact. Attention is drawn to the important notice on the last page of the text of the particulars.

Knight Frank
 274 Banbury Road
 Summertown
 Oxford OX2 7DY

I would be delighted to tell you more
Harry Sheppard
 01865 790077
 harry.sheppard@knightfrank.com

knightfrank.co.uk



Fixtures and fittings: A list of the fitted carpets, curtains, light fittings and other items fixed to the property which are included in the sale (or may be available by separate negotiation) will be provided by the Seller's Solicitors.
 Important Notice: 1. Particulars: These particulars are not an offer or contract, nor part of one. You should not rely on statements by Knight Frank LLP in the particulars or by word of mouth or in writing ("information") as being factually accurate about the property, its condition or its value. Neither Knight Frank LLP nor any joint agent has any authority to make any representations about the property, and accordingly any information given is entirely without responsibility on the part of the agents, seller(s) or lessor(s). 2. Photos, Videos etc: The photographs, property videos and virtual viewings etc. show only certain parts of the property as they appeared at the time they were taken. Areas, measurements and distances given are approximate only. 3. Regulations etc: Any reference to alterations to, or use of, any part of the property does not mean that any necessary planning, building regulations or other consent has been obtained. A buyer or lessee must find out by inspection or in other ways that these matters have been properly dealt with and that all information is correct. 4. VAT: The VAT position relating to the property may change without notice. 5. To find out how we process Personal Data, please refer to our Group Privacy Statement and other notices at <https://www.knightfrank.com/legals/privacy-statement>.
 Particulars dated 17/01/2024. Photographs and videos dated 17/01/2024.

Knight Frank is the trading name of Knight Frank LLP. Knight Frank LLP is a limited liability partnership registered in England and Wales with registered number OC305934. Our registered office is at 55 Baker Street, London W1U 8AN where you may look at a list of members' names. If we use the term 'partner' when referring to one of our representatives, that person will either be a member, employee, worker or consultant of Knight Frank LLP and not a partner in a partnership. If you do not want us to contact you further about our services then please contact us by either calling 020 3544 0692, email to marketing.help@knightfrank.com or post to our UK Residential Marketing Manager at our registered office (above) providing your name and address.

