



The Grange, Middle Green, Slough

---

A lovely family home, with delightful period features, in a wonderfully convenient location.

### Summary of accommodation

**Ground Floor** - Entrance hall | Sitting room | Snug | Kitchen/dining room

**First Floor** - Three bedrooms | Family bathroom

**Second Floor** - Bedroom

**Garden and grounds** - Garage | Car port | Utility room | Store | Gardeners w/c  
Driveway for several vehicles | Private level lawns

In all approximately 0.47 acres

### Distances

Langley 1.6 miles (Paddington 30 mins), Gerrards Cross 6.4 miles, Windsor 5.5 miles, Datchet 3.5 miles (Waterloo 54 mins), Denham 6.8 miles (Marylebone from 35 mins), Central London 20.6 miles, M25 (J15) 4.6 miles, M40 (J1) 4.6 miles, M4 (J5) 2.1 miles, London Heathrow 6.9 miles.  
(All distances and times are approximate).



### Location

Conveniently located just 20 miles from Hyde Park, access into London is well catered for with fast train services into Marylebone from Gerrards Cross in around 20 minutes. The area also benefits from the recent opening of the Elizabeth line, approximately 2 miles away, to give access into central London in 30 minutes and The City in less than 40 minutes.

The area lies within proximity to a number of highly regarded schools for all ages, including the popular grammar school system.



## The Grange

Approached through electric gates leading to the gravelled driveway, with parking for several vehicles, The Grange is entered via a covered portico leading into the welcoming hall. From here, doors lead into each of the reception rooms—both with open fires and attractive bay windows, providing an abundance of light. There is also access into the generous kitchen/dining room which has been fully fitted with integrated appliances, with the doors leading to the private and delightful rear garden.

The four generous bedrooms are arranged over the first and second floors, with a large double bathroom, which could be separated into two separate bathrooms if desired.



## Garden and Grounds

Beyond the house is a further area of parking leading to the garage and car port. The gardeners wc, store and utility room are also located here. Beyond, the gardens are delightful with many mature trees, shrubs and bushes and areas of level lawn.

The whole extends to around 0.47 acres.

## Property Information

**Guide Price:** £1,350,000

**Tenure:** Freehold.

**Services:** Mains water, electricity, gas & drainage

**Local Authority & Council Tax Band:** Buckinghamshire Council. Band G

**EPC:** D (rating 57)

**Postcode:** SL3 6BS

## Approximate Gross Internal Floor Area

Ground Floor: 109.8 sq m / 1,182 sq ft

First Floor: 88.5 sq m / 953 sq ft

Second Floor: 29.2 sq m / 314 sq ft

Garage: 30.6 sq m / 329 sq ft

Outbuildings: 8.7 sq m / 94 sq ft (Excluding Carport)

Total: 266.8 sq m / 2,872 sq ft

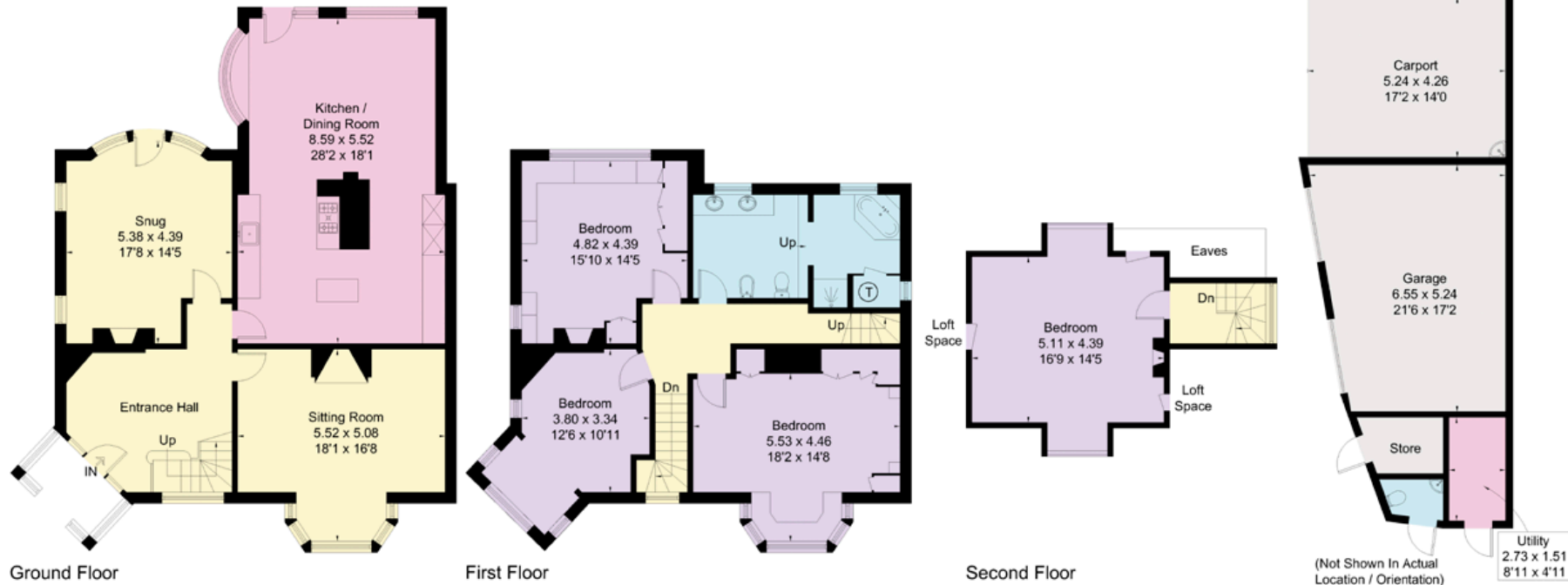

This plan is for guidance only and must not be relied upon as a statement of fact. Attention is drawn to the important notice on the last page of the text of the Particulars.

Bucks & Herts

[knightfrank.co.uk](https://www.knightfrank.co.uk)

I would be delighted to tell you more

William Furniss

01494 675368

07831 296845

[william.furniss@knightfrank.com](mailto:william.furniss@knightfrank.com)



Fixtures and fittings: A list of the fitted carpets, curtains, light fittings and other items fixed to the property which are included in the sale (or may be available by separate negotiation) will be provided by the Seller's Solicitors.

Important Notice: 1. Particulars: These particulars are not an offer or contract, nor part of one. You should not rely on statements by Knight Frank LLP in the particulars or by word of mouth or in writing ("information") as being factually accurate about the property, its condition or its value.

Neither Knight Frank LLP nor any joint agent has any authority to make any representations about the property, and accordingly any information given is entirely without responsibility on the part of the agents, seller(s) or lessor(s). 2. Photos, Videos etc: The photographs, property videos and virtual viewings etc. show only certain parts of the property as they appeared at the time they were taken. Areas, measurements and distances given are approximate only. 3. Regulations etc: Any reference to alterations to, or use of, any part of the property does not mean that any necessary planning, building regulations or other consent has been obtained. A buyer or lessee must find out by inspection or in other ways that these matters have been properly dealt with and that all information is correct. 4. VAT: The VAT position relating to the property may change without notice. 5.

To find out how we process Personal Data, please refer to our Group Privacy Statement and other notices at <https://www.knightfrank.com/legals/privacy-statement>.

Particulars dated April 2024. Photographs and videos dated April 2024.

All information is correct at the time of going to print. Knight Frank is the trading name of Knight Frank LLP. Knight Frank LLP is a limited liability partnership registered in England and Wales with registered number OC305934. Our registered office is at 55 Baker Street, London W1U 8AN. We use the term 'partner' to refer to a member of Knight Frank LLP, or an employee or consultant. A list of members names of Knight Frank LLP may be inspected at our registered office. If you do not want us to contact you further about our services then please contact us by either calling 020 3544 0692, email to [marketing.help@knightfrank.com](mailto:marketing.help@knightfrank.com) or post to our UK Residential Marketing Manager at our registered office (above) providing your name and address.