

Approximate Area = 836.7 sq m / 9006 sq ft

Outbuildings = 243.5 sq m / 2621 sq ft

(Excluding Wood Store / Eaves)

Total = 1080.2 sq m / 11627 sq ft

Including Limited Use Area (21.7 sq m / 233 sq ft)

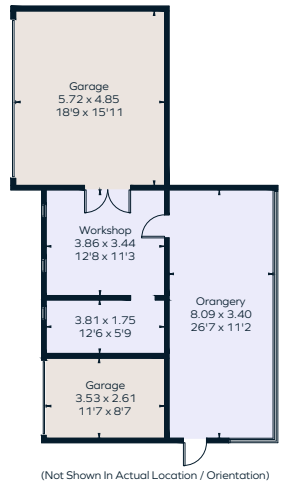

Reduced head height below 1.5m

