

Lyntonia House, Hyde Park W2



Lyntonia House, Hyde Park W2

Presented to the market in great condition, this spacious two bedroom, two bathroom apartment is positioned on the third floor and measures approximately 63.7 sq. m. (686 sq. ft.).

Internally the accommodation on offer briefly comprises; reception room, separate kitchen equipped with a generous range of fitted white gloss cabinets and integrated appliances, two double bedrooms with the principal boasting en suite shower room and finally a family bathroom.

Lyntonia House is located in a striking location in the heart of Central London with the West End's world-class shopping, theatres and restaurants on its doorstep.



Guide price: £680,000

Tenure: Leasehold: approximately 141 years remaining

Service charge: £3,145 per annum, reviewed every year, next review due 2025

Local authority: City of Westminster

Council tax band: E





The development benefits from excellent transport links via Paddington mainline (Network Rail and Heathrow Express) and underground (Circle, District, Bakerloo and Hammersmith & City) station as well as being perfectly positioned for the Paddington branch of the Elizabeth line station which provides fast journey times into the City, Canary Wharf and out to Heathrow and Reading in the other direction.



Lyntonia House, W2

Approximate Area = 63.7 sq m / 686 sq ft
Including Limited Use Area (1.4 sq m / 15 sq ft)



We have been informed that the building has been constructed using some combustible materials. However, we have received documents confirming that the building has been assessed by a competent person, who has concluded that the fire risk is sufficiently low, and that no remedial works are required to the external wall of the building. If necessary, further information can be provided upon request.

This plan is for guidance only and must not be relied upon as a statement of fact. Attention is drawn to the important notice on the last page of the text of the Particulars.

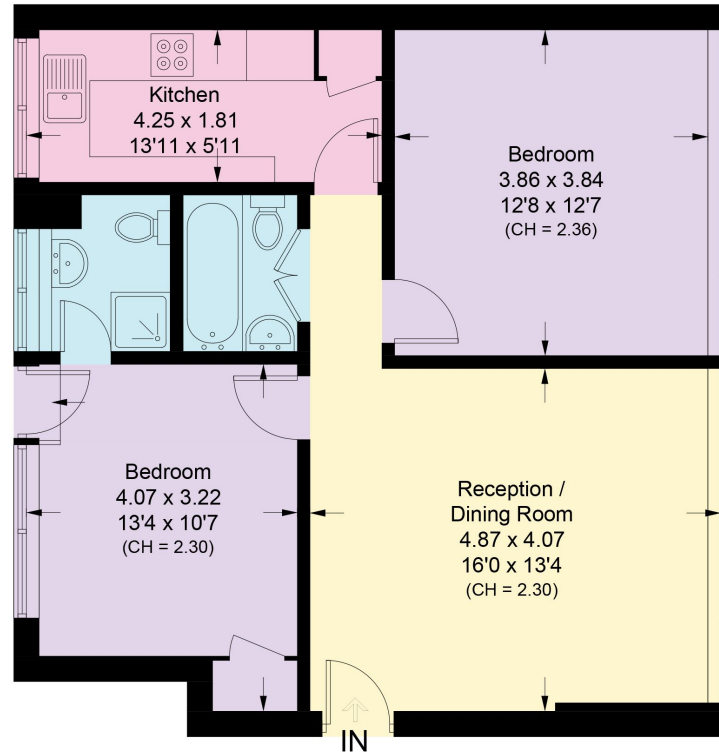

Third Floor

Knight Frank

Hyde Park

1 Craven Terrace

London

W2 3QD

knightfrank.co.uk

I would be delighted to tell you more

Mark Ruffell

020 3697 8234

mark.ruffell@knightfrank.com



Fixtures and fittings: A list of the fitted carpets, curtains, light fittings and other items fixed to the property which are included in the sale (or may be available by separate negotiation) will be provided by the Seller's Solicitors.

Important Notice: 1. Particulars: These particulars are not an offer or contract, nor part of one. You should not rely on statements by Knight Frank LLP in the particulars or by word of mouth or in writing ("information") as being factually accurate about the property, its condition or its value. Neither Knight Frank LLP nor any joint agent has any authority to make any representations about the property, and accordingly any information given is entirely without responsibility on the part of the agents, seller(s) or lessor(s). 2. Photos, Videos etc: The photographs, property videos and virtual viewings etc. show only certain parts of the property as they appeared at the time they were taken. Areas, measurements and distances given are approximate only. 3. Regulations etc: Any reference to alterations to, or use of, any part of the property does not mean that any necessary planning, building regulations or other consent has been obtained. A buyer or lessee must find out by inspection or in other ways that these matters have been properly dealt with and that all information is correct. 4. VAT: The VAT position relating to the property may change without notice. 5. To find out how we process Personal Data, please refer to our Group Privacy Statement and other notices at <https://www.knightfrank.com/legals/privacy-statement>.

Particulars dated April 2024. Photographs and videos dated April 2024.

Knight Frank is the trading name of Knight Frank LLP. Knight Frank LLP is a limited liability partnership registered in England and Wales with registered number OC305934. Our registered office is at 55 Baker Street, London W1U 8AN where you may look at a list of members' names. If we use the term 'partner' when referring to one of our representatives, that person will either be a member, employee, worker or consultant of Knight Frank LLP and not a partner in a partnership. If you do not want us to contact you further about our services then please contact us by either calling 020 3544 0692, email to marketing.help@knightfrank.com or post to our UK Residential Marketing Manager at our registered office (above) providing your name and address.