



Chepstow Road, Notting Hill W2



Chepstow Road

Notting Hill W2

This flat is well presented with a contemporary finish throughout and is calming, clean and bright. The open plan reception room includes a high spec fully integrated kitchen. The primary bedroom has a large dressing area with a large sky light and an en suite bathroom. Both bedrooms have access and views to the tranquil private garden through French doors. Both bathrooms are equipped with spacious walk-in showers, demisting mirrors and heated towel rails. The flat is a 'smart home' complete with a sophisticated alarm system, smart underfloor heating throughout and smart lighting. All the above can be configured and controlled at home or remotely using a smart phone. Renovated to a high quality finish.



Guide price: £923 per week

Furniture: Available part furnished

Minimum length of tenancy: 12 months

Deposit: £4,615

Local authority: City of Westminster

Council tax band: C





Specifications

- o Renovated to a high quality finish
- o Stylish Entry Way/Boot room with built in bench and coat hangers
- o Nearest Stations are Westbourne Park, Royal Oak and Notting Hill Gate
- o Walking Distance to Hyde Park and Kensington Gardens

Kitchen Appliances:

- o Full Size Smart Oven with microwave option built in. Wifi controlled.
- o Quooker Tap with built in Kettle and Cold Filtered Water
- o Tall Fridge Freezer
- o Dishwasher and Washer Dryer

Heating System:

- o Smart Underfloor Heating System (Water). Can be remotely controlled from phone.
- o Individual Thermostats control each room individually

Security:

- o Smart alarm system with remote access from phone
- o Full house arming and perimeter settings for when inside
- o Window and Door Contacts
- o Sky Light and Garden Door Vibration Sensors
- o Alarm PIR Sensors in each room
- o Panic button by master bed
- o Ring Video Doorbell with two-way intercom

Lighting:

- o Smart LED lighting that can be controlled remotely from phone
- o Temperature/Colour can be adjusted from warm to cool using smart controls
- o Dimmable also using smart controls





Approximate Gross Internal Floor Area 65.8 sq m / 708 sq ft

This plan is for guidance only and must not be relied upon as a statement of fact. Attention is drawn to the important notice on the last page of the text of the Particulars.

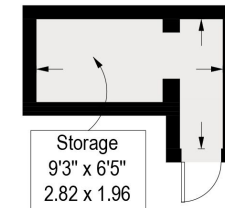
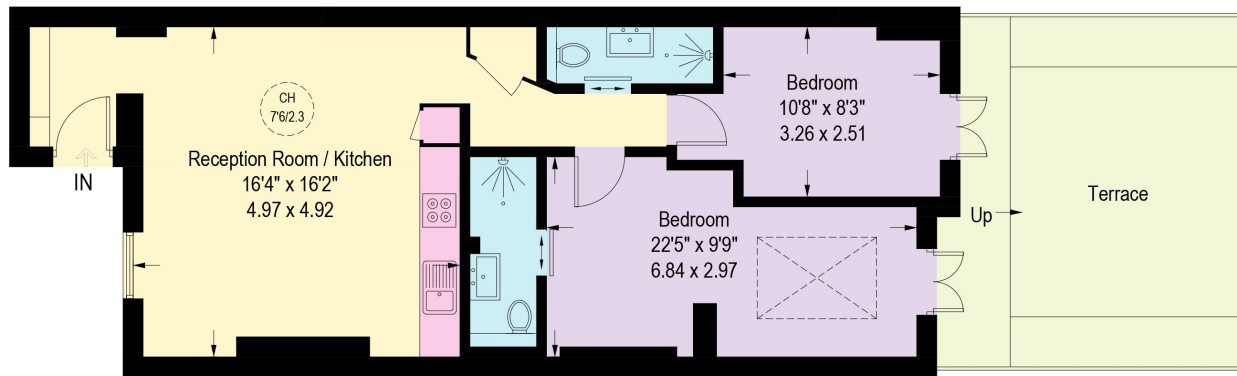

(Not Shown In Actual Location / Orientation)

Lower Ground Floor

Knight Frank

Notting Hill Lettings

298 Westbourne Grove

London

W11 2PS

[knightfrank.co.uk](https://www.knightfrank.co.uk)

I would be delighted to tell you more

Elizabeth Holder

+44 20 7985 9995

elizabeth.holder@knightfrank.com



All potential tenants should be advised that, as well as rent a holding deposit will be payable which is equal to one week's rent (if an AST) and two weeks' rent (if not an AST), a tenancy deposit will also be payable which is equal to 6 weeks' rent (if not an AST and/or the annual rent is over £50,000), or 5 weeks' rent (if an AST and/or the annual rent is below £50,000). If the landlord agrees to you having a pet you may be required to pay a higher deposit (if not an AST) or higher weekly rent (if an AST). An administration fee of £288 and referencing fees of £60 per person will also apply when renting a property (if not an AST). (All fees shown are inclusive of VAT). For other fees that might apply, please ask us or visit www.knightfrank.co.uk/tenantfees. Please note that the material information above is provided to Knight Frank by third parties and is provided here as a guide only. Some of the information provided (such as the rent, deposit or length of tenancy) is subject to change, depending on offers received by the landlord. While Knight Frank has taken steps to verify this information, we advise you to confirm the details of any such material information prior to any offer for the tenancy being submitted. If we are informed of changes to this information by the landlord, we will use all reasonable endeavours to update this as soon as practical.

Fixtures and fittings: Carpets, curtains, light fittings and other items fixed to the property (and not fixed to the property) belonging to the landlord are included in any tenancy as evidenced in the inventory, unless specifically noted otherwise. All those items regarded as tenant's fixtures and fittings, are specifically excluded from any tenancy and will not be evidenced in the inventory. Important Notice: 1. Particulars: These particulars are not an offer or contract, nor part of one. You should not rely on statements by Knight Frank LLP in the particulars or by word of mouth or in writing ("information") as being factually accurate about the property, its condition or its value. Neither Knight Frank LLP nor any joint agent has any authority to make any representations about the property, and accordingly any information given is entirely without responsibility on the part of the agents, seller(s) or lessor(s). 2. Photos, Videos etc: The photographs, property videos and virtual viewings etc. show only certain parts of the property as they appeared at the time they were taken. Areas, measurements and distances given are approximate only. 3. Regulations etc: Any reference to alterations to, or use of, any part of the property does not mean that any necessary planning, building regulations or other consent has been obtained. A buyer or lessee must find out by inspection or in other ways that these matters have been properly dealt with and that all information is correct. 4. VAT: The VAT position relating to the property may change without notice. 5. To find out how we process Personal Data, please refer to our Group Privacy Statement and other notices at <https://www.knightfrank.com/legals/privacy-statement>. Particulars dated April 2024. Photographs and videos dated April 2024.

Knight Frank is the trading name of Knight Frank LLP. Knight Frank LLP is a limited liability partnership registered in England and Wales with registered number OC305934. Our registered office is at 55 Baker Street, London W1U 8AN where you may look at a list of members' names. If we use the term 'partner' when referring to one of our representatives, that person will either be a member, employee, worker or consultant of Knight Frank LLP and not a partner in a partnership. If you do not want us to contact you further about our services then please contact us by either calling 020 3544 0692, email to marketing.help@knightfrank.com or post to our UK Residential Marketing Manager at our registered office (above) providing your name and address.