

Lancaster Gate, Hyde Park W2



Lancaster Gate, Hyde Park W2

An expansive, triple aspect, lateral apartment with views across the green open expanse of Hyde Park with accommodation in excess of 3000 square feet.

Positioned on the fourth floor (with lift access) of this well presented, Grade II listed stucco building, the property boasts a stunning south-facing reception room overlooking the park. Elsewhere, accessed from the inviting entrance hall, there are four generous bedrooms, two bathrooms, two cloakrooms, a well-equipped separate kitchen and a utility room. Further benefits include daytime porter and permit parking.



Guide price: £5,950,000

Tenure: Share of freehold plus leasehold, approximately 955 years remaining

Service charge: £14,106 per annum, reviewed every year, next review due 2025

Ground rent: £240 per annum fixed for the remainder of the lease.

Local authority: City of Westminster

Council tax band: H







Lancaster Gate is located off the Bayswater Road, within close proximity of Lancaster Gate (Central line) station and Paddington mainline, Elizabeth line and underground stations. The wonderful open spaces of Hyde Park and Kensington Gardens are located close by.



Lancaster Gate, W2

Approximate Area = 297.9 sq m / 3206 sq ft
Including Limited Use Area (6.9 sq m / 74 sq ft)



This plan is for guidance only and must not be relied upon as a statement of fact. Attention is drawn to the important notice on the last page of the text of the Particulars.

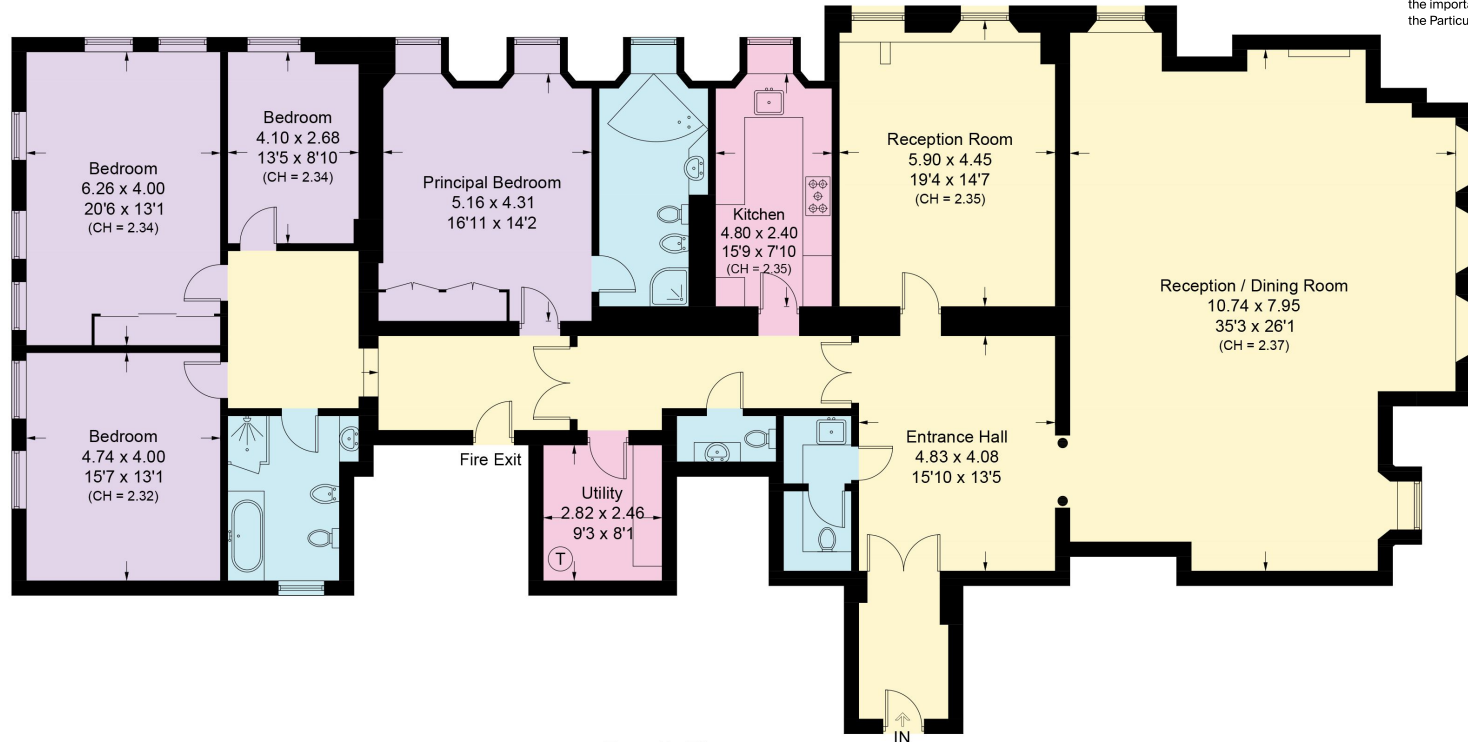

Fourth Floor

Approximate Area = 297.9 sq m / 3206 sq ft
Including Limited Use Area (6.9 sq m / 74 sq ft)

Knight Frank

Hyde Park

1 Craven Terrace

London

W2 3QD

knightfrank.co.uk

I would be delighted to tell you more

Mark Ruffell

020 3697 8234

mark.ruffell@knightfrank.com



Fixtures and fittings: A list of the fitted carpets, curtains, light fittings and other items fixed to the property which are included in the sale (or may be available by separate negotiation) will be provided by the Seller's Solicitors.

Important Notice: 1. Particulars: These particulars are not an offer or contract, nor part of one. You should not rely on statements by Knight Frank LLP in the particulars or by word of mouth or in writing ("information") as being factually accurate about the property, its condition or its value. Neither Knight Frank LLP nor any joint agent has any authority to make any representations about the property, and accordingly any information given is entirely without responsibility on the part of the agents, seller(s) or lessor(s). 2. Photos, Videos etc: The photographs, property videos and virtual viewings etc. show only certain parts of the property as they appeared at the time they were taken. Areas, measurements and distances given are approximate only. 3. Regulations etc: Any reference to alterations to, or use of, any part of the property does not mean that any necessary planning, building regulations or other consent has been obtained. A buyer or lessee must find out by inspection or in other ways that these matters have been properly dealt with and that all information is correct. 4. VAT: The VAT position relating to the property may change without notice. 5. To find out how we process Personal Data, please refer to our Group Privacy Statement and other notices at <https://www.knightfrank.com/legals/privacy-statement>.

Particulars dated November 2024. Photographs and videos dated November 2024.

Knight Frank is the trading name of Knight Frank LLP. Knight Frank LLP is a limited liability partnership registered in England and Wales with registered number OC305934. Our registered office is at 55 Baker Street, London W1U 8AN where you may look at a list of members' names. If we use the term 'partner' when referring to one of our representatives, that person will either be a member, employee, worker or consultant of Knight Frank LLP and not a partner in a partnership. If you do not want us to contact you further about our services then please contact us by either calling 020 3544 0692, email to marketing.help@knightfrank.com or post to our UK Residential Marketing Manager at our registered office (above) providing your name and address.