



OLD FORGE FARM

SOUTH GREEN, NR HUCKING, SITTINGBOURNE



WELL PRESENTED FARMHOUSE WITH EQUESTRIAN FACILITIES

Three bedroom Grade II listed farmhouse of over 2500 sq ft with superb equestrian facilities, located in grounds of 18+ acres, within an idyllic rural, yet convenient location.



Local Authority: Maidstone Borough Council

Council Tax band: D

Tenure: Freehold



GROUND FLOOR

This charming Grade II Listed farmhouse has been cleverly extended and restored, with superbly presented accommodation throughout that has been well maintained by the vendors.

The front door opens to a full height entrance hall with impressive oak staircase to the first floor. Stairs behind this lead down to a cellar that could be used as study, gym or a variety of purposes. Both reception rooms are of a good size and enjoy dual aspects, a wealth of original timbers and wood burning stoves with an impressive inglenook fireplace in the sitting room. The generous farmhouse style kitchen/dining room has a comprehensive range of cabinetry, wooden worktops, range cooker and a large dresser. Adjacent, the utility room has direct access outside.











FIRST FLOOR & GROUNDS

On the first floor are three bedroom suites, all with well appointed bathrooms. The principal bedroom has a stunning vaulted ceiling and generous ensuite bathroom with separate shower. The guest bedroom is accessed via a staircase in the dining room and also enjoys a vaulted ceiling.

The house has a long gravel driveway with formal gardens to one side. These continue around the house with terraces and a kitchen garden. There is a substantial American barn with superb stabling consisting of 8 stables, tack room and grooms area. A barn has lapsed planning for ancillary accommodation alongside a further large open barn. Planning permission was also obtained in June 2021 for the construction of a horse riding arena (21/502235/FULL).

The land is divided into paddocks with water and there is picturesque area of woodland.





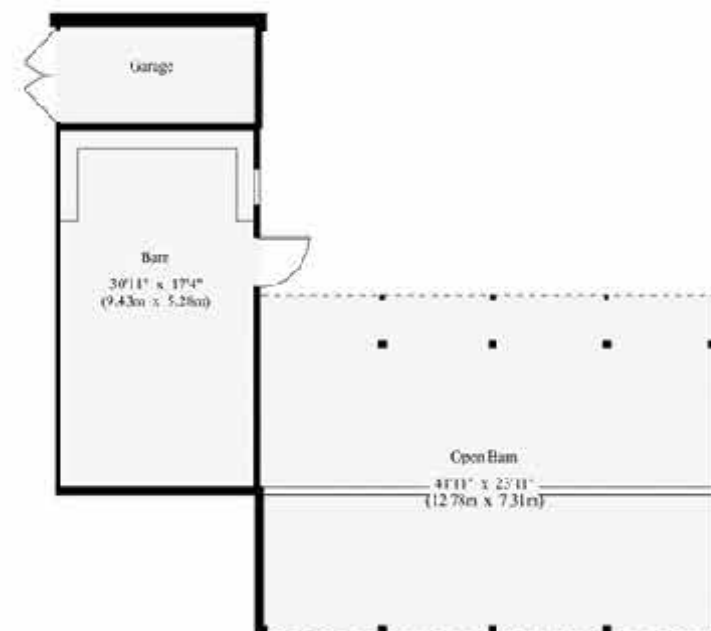

Old Forge Farm Outbuildings

Barn and Garage - Gross Internal Area : 64.4 sq.m (693 sq.ft.)

Open Barn - Gross Internal Area : 91.6 sq.m (985 sq.ft.)

Stables - Gross Internal Area : 179.6 sq.m (1933 sq.ft.)

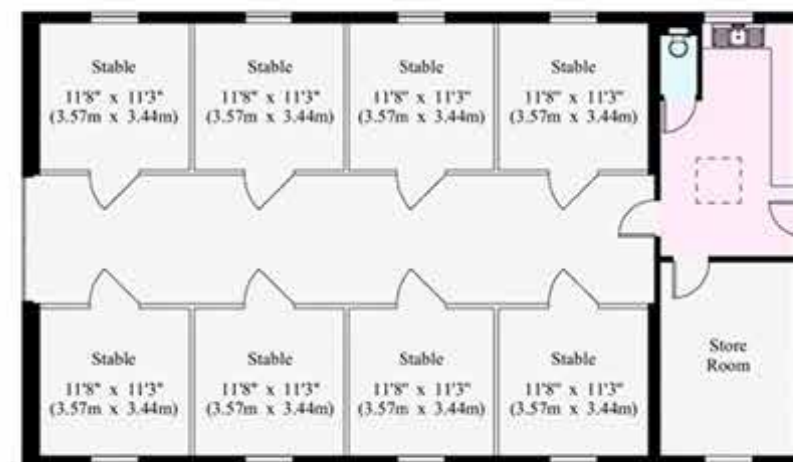

Approximate Gross Internal Area = 240.8 sq m / 2591 sq ft

This plan is for layout guidance only. Not drawn to scale unless stated. Windows and door openings are approximate. Whilst every care is taken in the preparation of this plan, please check all dimensions, shapes and compass bearings before making any decisions reliant upon them. (ID767266)



Edward Torry

01732 744478

edward.torry@knightfrank.com

Knight Frank Sevenoaks

113-117 High Street, Sevenoaks, Kent

TN13 1UP

knightfrank.co.uk

Your partners in property

1. Particulars: These particulars are not an offer or contract, nor part of one. You should not rely on statements given by Knight Frank in the particulars, by word of mouth or in writing ("information") as being factually accurate about the property, its condition or its value. Neither Knight Frank nor any joint agent has any authority to make any representations about the property, and accordingly any information given is entirely without responsibility on the part of Knight Frank. 2. Material Information: Please note that the material information is provided to Knight Frank by third parties and is provided here as a guide only. While Knight Frank has taken steps to verify this information, we advise you to confirm the details of any such material information prior to any offer being submitted. If we are informed of changes to this information by the seller or another third party, we will use reasonable endeavours to update this as soon as practical. 3. Photos, Videos etc: The photographs, property videos and virtual viewings etc. show only certain parts of the property as they appeared at the time they were taken. Areas, measurements and distances given are approximate only. 4. Regulations etc: Any reference to alterations to, or use of, any part of the property does not mean that any necessary planning, building regulations or other consent has been obtained. A buyer must find out by inspection or in other ways that these matters have been properly dealt with and that all information is correct. 5. Fixtures and fittings: A list of the fitted carpets, curtains, light fittings and other items fixed to the property which are included in the sale (or may be available by separate negotiation) will be provided by the Seller's Solicitors. 6. VAT: The VAT position relating to the property may change without notice. 7. To find out how we process Personal Data, please refer to our Group Privacy Statement and other notices at <https://www.knightfrank.com/legals/privacy-statement>.

Particulars dated December 2025. Photographs and videos dated December 2023. All information is correct at the time of going to print. Knight Frank is the trading name of Knight Frank LLP. Knight Frank LLP is a limited liability partnership registered in England and Wales with registered number OC305934. Our registered office is at 55 Baker Street, London W1U 8AN. We use the term 'partner' to refer to a member of Knight Frank LLP, or an employee or consultant. A list of members names of Knight Frank LLP may be inspected at our registered office. If you do not want us to contact you further about our services then please contact us by either calling 020 3544 0692, email to marketing.help@knightfrank.com or post to our UK Residential Marketing Manager at our registered office (above) providing your name and address.

