



Hamilton Terrace, St John's Wood, London NW8

---



# Hamilton Terrace, St John's Wood London NW8

---

This immaculately presented two bedroom apartment is situated on the second floor of a period conversion on Hamilton Terrace in St John's Wood.

Accommodation comprises of a spacious reception/dining room, a separate kitchen, a principal bedroom with en-suite bathroom, a second bedroom with walk in closet and a family bathroom.



**Guide price:** £1,325,000

**Tenure:** Leasehold: approximately 150 years remaining

**Service charge:** £2,200

**Local authority:** City of Westminster

**Council tax band:** H

## Location

Hamilton Terrace is located on the west side of St. John's Wood, Abbey Road Studios (0.4 miles) and the home of cricket, Lord's Cricket Ground (0.8 miles). St John's Wood High Street is 0.8 miles away and offers an array of boutique shops, restaurants and cafes. St John's Wood Underground station (Jubilee Line) is 0.6 miles walk and is a fast transport link to Bond Street (5 minutes), London Bridge (14 minutes) and Canary Wharf (20 minutes). All distances are approximate.





Hamilton Terrace  
Gross Internal Area(Approx)  
Total = 93.18 Sq m / 1003 Sq ft

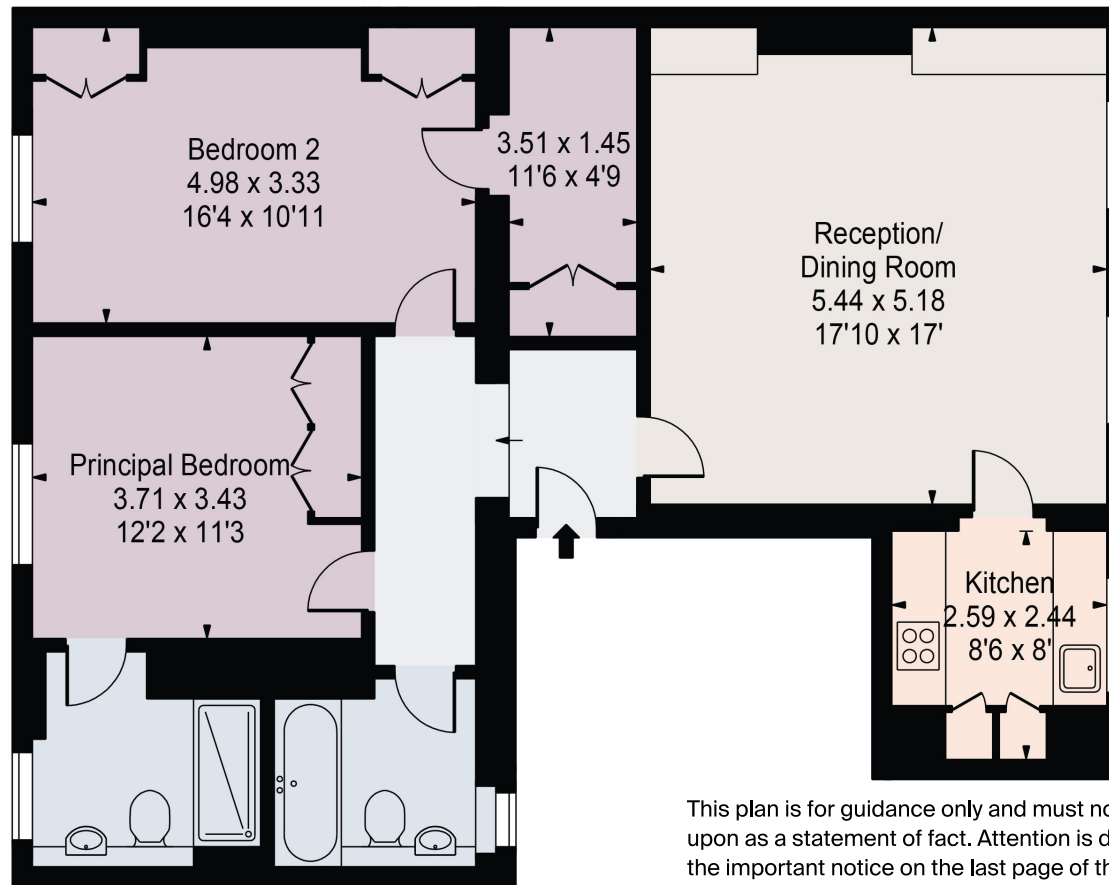

This plan is for guidance only and must not be relied upon as a statement of fact. Attention is drawn to the important notice on the last page of the text of the Particulars.

## Second Floor

Knight Frank  
St John's Wood  
5-7 Wellington Place  
London  
NW8 7PB  
[knightfrank.co.uk](https://www.knightfrank.co.uk)

I would be delighted to tell you more  
**Ilana Ormonde**  
020 3815 3357  
[ilana.ormonde@knightfrank.com](mailto:ilana.ormonde@knightfrank.com)



Fixtures and fittings: A list of the fitted carpets, curtains, light fittings and other items fixed to the property which are included in the sale (or may be available by separate negotiation) will be provided by the Seller's Solicitors.

Important Notice: 1. Particulars: These particulars are not an offer or contract, nor part of one. You should not rely on statements by Knight Frank LLP in the particulars or by word of mouth or in writing ("information") as being factually accurate about the property, its condition or its value. Neither Knight Frank LLP nor any joint agent has any authority to make any representations about the property, and accordingly any information given is entirely without responsibility on the part of the agents, seller(s) or lessor(s). 2. Photos, Videos etc: The photographs, property videos and virtual viewings etc. show only certain parts of the property as they appeared at the time they were taken. Areas, measurements and distances given are approximate only. 3. Regulations etc: Any reference to alterations to, or use of, any part of the property does not mean that any necessary planning, building regulations or other consent has been obtained. A buyer or lessee must find out by inspection or in other ways that these matters have been properly dealt with and that all information is correct. 4. VAT: The VAT position relating to the property may change without notice. 5. To find out how we process Personal Data, please refer to our Group Privacy Statement and other notices at <https://www.knightfrank.com/legals/privacy-statement>.

Particulars dated September 2022. Photographs and videos dated September 2022.

Knight Frank is the trading name of Knight Frank LLP. Knight Frank LLP is a limited liability partnership registered in England and Wales with registered number OC305934. Our registered office is at 55 Baker Street, London W1U 8AN where you may look at a list of members' names. If we use the term 'partner' when referring to one of our representatives, that person will either be a member, employee, worker or consultant of Knight Frank LLP and not a partner in a partnership. If you do not want us to contact you further about our services then please contact us by either calling 020 3544 0692, email to [marketing.help@knightfrank.com](mailto:marketing.help@knightfrank.com) or post to our UK Residential Marketing Manager at our registered office (above) providing your name and address.