

Circus Road, St John's Wood NW8



Circus Road, St John's Wood NW8

A rare opportunity to acquire a Grade II listed, semi-detached period house providing spacious family accommodation including five bedrooms, five bathrooms, a dressing room and excellent entertaining space. The property also has a good-sized front and rear garden and is well-presented.

Circus Road is situated in the heart of St John's Wood, close to the amenities on St John's Wood High Street, St John's Wood Underground Station (Jubilee Line) and the green spaces of Regent's Park.



5 5 3  EPC
E

Guide price: £3,600,000

Tenure: Freehold

Local authority: City of Westminster

Council tax band: G







Circus Road, NW8

Approximate Area = 202.9 sq m / 2184 sq ft

Basement = 56.0 sq m / 603 sq ft

Total = 258.9 sq m / 2787 sq ft

Including Limited Use Area (14.2 sq m / 153 sq ft) and Boiler Room / Eaves

This plan is for guidance only and must not be relied upon as a statement of fact. Attention is drawn to the important notice on the last page of the text of the Particulars.

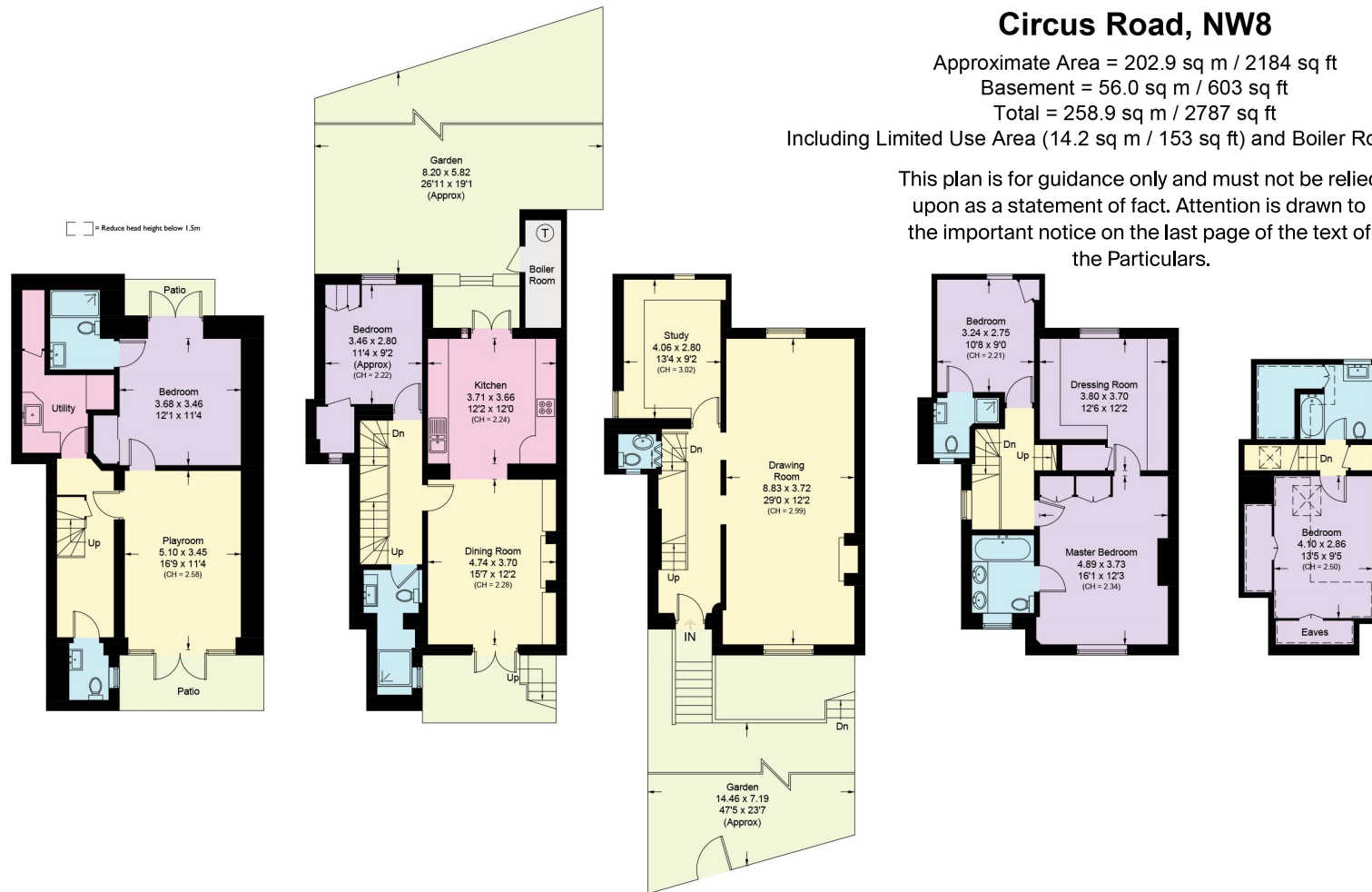

Knight Frank
St John's Wood
 5-7 Wellington Pl
 London
 NW8 7PB
knightfrank.co.uk

Basement
 Approximate Area = 56.0 sq m / 603 sq ft

Lower Ground Floor
 Approximate Area = 62.1 sq m / 668 sq ft
 (Including Boiler Room)

Raised Ground Floor
 Approximate Area = 57.1 sq m / 615 sq ft

First Floor
 Approximate Area = 56.5 sq m / 608 sq ft

Second Floor
 Approximate Area = 27.2 sq m / 293 sq ft
 Including Limited Use Area
 (14.2 sq m / 153 sq ft) and Eaves

I would be delighted to tell you more
Tim Perks
 +44 20 7871 5065
tim.perks@knightfrank.com



Fixtures and fittings: A list of the fitted carpets, curtains, light fittings and other items fixed to the property which are included in the sale (or may be available by separate negotiation) will be provided by the Seller's Solicitors.

Important Notice: 1. Particulars: These particulars are not an offer or contract, nor part of one. You should not rely on statements by Knight Frank LLP in the particulars or by word of mouth or in writing ("information") as being factually accurate about the property, its condition or its value. Neither Knight Frank LLP nor any joint agent has any authority to make any representations about the property, and accordingly any information given is entirely without responsibility on the part of the agents, seller(s) or lessor(s). 2. Photos, Videos etc: The photographs, property videos and virtual viewings etc. show only certain parts of the property as they appeared at the time they were taken. Areas, measurements and distances given are approximate only. 3. Regulations etc: Any reference to alterations to, or use of, any part of the property does not mean that any necessary planning, building regulations or other consent has been obtained. A buyer or lessee must find out by inspection or in other ways that these matters have been properly dealt with and that all that information is correct. 4. VAT: The VAT position relating to the property may change without notice. 5. To find out how we process Personal Data, please refer to our Group Privacy Statement and other notices at <https://www.knightfrank.com/legals/privacy-statement>. Particulars dated June 2022. Photographs and videos dated June 2022.

All information is correct at the time of going to print. Knight Frank is the trading name of Knight Frank LLP. Knight Frank LLP is a limited liability partnership registered in England and Wales with registered number OC305934. Our registered office is at 55 Baker Street, London W1U 8AN. We use the term 'partner' to refer to a member of Knight Frank LLP, or an employee or consultant. A list of members names of Knight Frank LLP may be inspected at our registered office. If you do not want us to contact you further about our services then please contact us by either calling 020 3544 0692, email to marketing.help@knightfrank.com or post to our UK Residential Marketing Manager at our registered office (above) providing your name and address.