



Empire House, South Kensington **SW7**

Empire House, South Kensington SW7

A spacious third floor apartment in a prestigious block with 24 hour porter.

Comprising four bedrooms and occupying a corner position on the third floor of Empire House with leafy views down Alexander Square. This flat is filled with natural light, with high ceilings and would benefit from refurbishment.

The apartment measures approximately 1,774 square feet (164 sq m) and offers versatile space that would lend itself to reconfiguration subject to the usual consents. Additionally the building benefits from a 24 hour porter and the common parts have recently undergone a refurbishment.



Guide price: £2,950,000

Tenure: Leasehold: approximately 117 years remaining

Service charge: Approximately £19,965 per annum, reviewed every year, next review due 2025

Ground rent: £500 per annum, reviewed every 50 years, next review due 2042

Local authority: Royal Borough of Kensington and Chelsea

Council tax band: H





Empire House boasts a highly desirable and sought after location on the Brompton Road moments from the world famous Natural History and V & A Museum and only moments from Harrods.



Empire House, SW7

Approximate Gross Internal Floor Area
164.8 sq m / 1774 sq ft

This plan is for guidance only and must not be relied upon as a statement of fact. Attention is drawn to the important notice on the last page of the text of the Particulars.

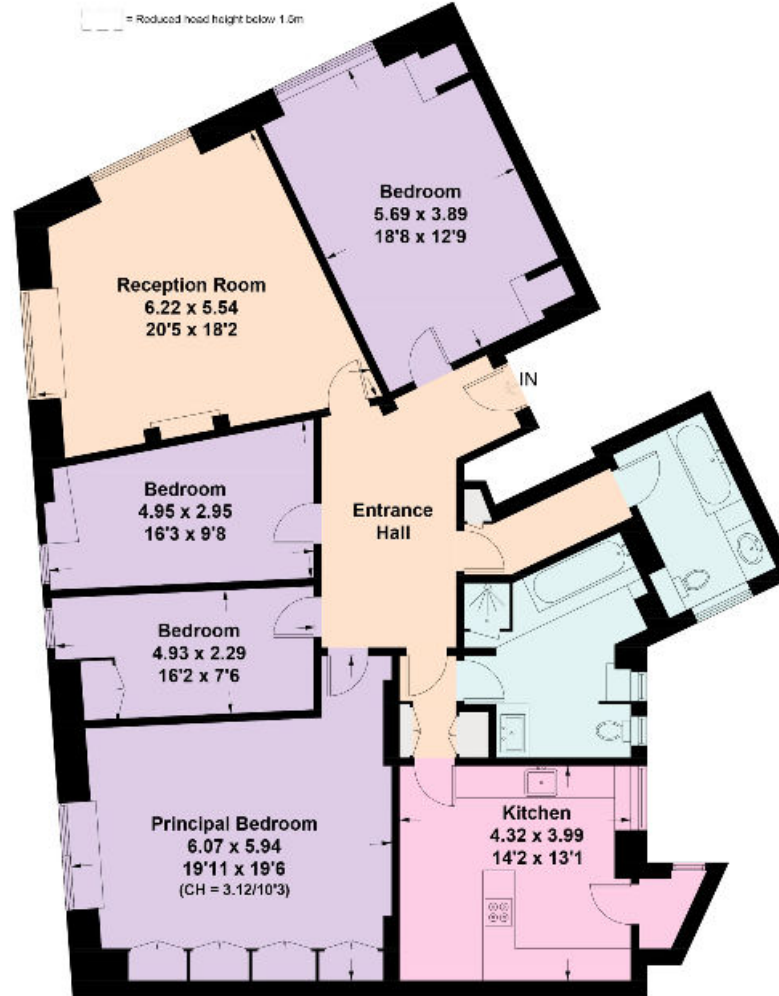

Third Floor

Knight Frank
Knightsbridge

52 - 54 Sloane Avenue
London
SW3 3DD

[knightfrank.co.uk](https://www.knightfrank.co.uk)

I would be delighted to tell you more

James Robinson

+44 207 861 1771

james.robinson@knightfrank.com



Fixtures and fittings: A list of the fitted carpets, curtains, light fittings and other items fixed to the property which are included in the sale (or may be available by separate negotiation) will be provided by the Seller's Solicitors.

Important Notice: 1. Particulars: These particulars are not an offer or contract, nor part of one. You should not rely on statements by Knight Frank LLP in the particulars or by word of mouth or in writing ("information") as being factually accurate about the property, its condition or its value. Neither Knight Frank LLP nor any joint agent has any authority to make any representations about the property, and accordingly any information given is entirely without responsibility on the part of the agents, seller(s) or lessor(s). 2. Photos, Videos etc: The photographs, property videos and virtual viewings etc. show only certain parts of the property as they appeared at the time they were taken. Areas, measurements and distances given are approximate only. 3. Regulations etc: Any reference to alterations to, or use of, any part of the property does not mean that any necessary planning, building regulations or other consent has been obtained. A buyer or lessee must find out by inspection or in other ways that these matters have been properly dealt with and that all information is correct. 4. VAT: The VAT position relating to the property may change without notice. 5. To find out how we process Personal Data, please refer to our Group Privacy Statement and other notices at <https://www.knightfrank.com/legals/privacy-statement>. Particulars dated April 2024. Photographs and videos dated April 2024.

Knight Frank is the trading name of Knight Frank LLP. Knight Frank LLP is a limited liability partnership registered in England and Wales with registered number OC305934. Our registered office is at 55 Baker Street, London W1U 8AN where you may look at a list of members' names. If we use the term 'partner' when referring to one of our representatives, that person will either be a member, employee, worker or consultant of Knight Frank LLP and not a partner in a partnership. If you do not want us to contact you further about our services then please contact us by either calling 020 3544 0692, email to marketing.help@knightfrank.com or post to our UK Residential Marketing Manager at our registered office (above) providing your name and address.