



Courtfield Gardens, London SW5

---



# Courtfield Gardens, London SW5

A superb two bedroom, two bathroom apartment situated on the third floor of a part stucco-fronted Victorian conversion overlooking the highly sought-after square of Courtfield Gardens SW5. This is an exciting opportunity to acquire a south-facing apartment with residents access to communal gardens in the esteemed Royal Borough of Kensington and Chelsea.

Upon entering the apartment, a welcoming hallway leads through to a spacious south-facing reception room with picturesque green viewings of the garden below. The space further benefits from a marble fireplace, hardwood flooring and high ceilings.



**Asking price:** £1,295,000

**Tenure:** Leasehold: approximately 928 years remaining

**Service charge:** approximately £4,022 per annum, reviewed once per annum (+ £1,562 into reserve fund)

**Ground rent:** a peppercorn per annum

**Local authority:** Royal Borough of Kensington & Chelsea

**Council tax band:** F





A well-appointed eat-in kitchen seamlessly connects to the reception room, which is complete with a period fireplace, integrated appliances, a gas hob, ample cabinetry and pristine worktops.

The principal bedroom is adjacent to the reception room, which is served by an exclusive dressing room and a sleek en suite. A further good-sized double bedroom is to the rear, with ample wardrobe storage and its own en suite. Additionally, there is a guest W/C and further storage conveniently in the hallway. The apartment has a well-balanced layout which measures to approximately 849 sq ft.





## Courtfield Gardens, SW5

Approximate Gross Internal Area  
78.86 sq m / 849 sq ft

( CH = Ceiling Heights )

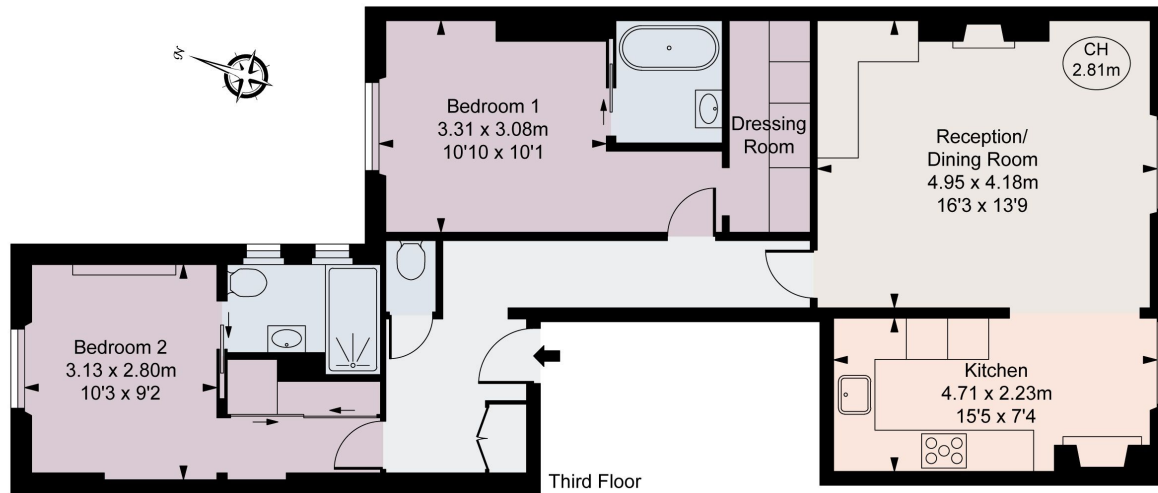

This plan is for guidance only and must not be relied upon as a statement of fact. Attention is drawn to the important notice on the last page of the text of the Particulars.

**Knight Frank**

**South Kensington Sales**

160 Old Brompton Road

London

SW5 0BA

[knightfrank.co.uk](https://www.knightfrank.co.uk)

I would be delighted to tell you more

**Jordanna Mancina**

020 3892 3573

[jordanna.mancina@knightfrank.com](mailto:jordanna.mancina@knightfrank.com)



Fixtures and fittings: A list of the fitted carpets, curtains, light fittings and other items fixed to the property which are included in the sale (or may be available by separate negotiation) will be provided by the Seller's Solicitors.

Important Notice: 1. Particulars: These particulars are not an offer or contract, nor part of one. You should not rely on statements by Knight Frank LLP in the particulars or by word of mouth or in writing ("information") as being factually accurate about the property, its condition or its value. Neither Knight Frank LLP nor any joint agent has any authority to make any representations about the property, and accordingly any information given is entirely without responsibility on the part of the agents, seller(s) or lessor(s). 2. Photos, Videos etc: The photographs, property videos and virtual viewings etc. show only certain parts of the property as they appeared at the time they were taken. Areas, measurements and distances given are approximate only. 3. Regulations etc: Any reference to alterations to, or use of, any part of the property does not mean that any necessary planning, building regulations or other consent has been obtained. A buyer or lessee must find out by inspection or in other ways that these matters have been properly dealt with and that all information is correct. 4. VAT: The VAT position relating to the property may change without notice. 5. To find out how we process Personal Data, please refer to our Group Privacy Statement and other notices at <https://www.knightfrank.com/legals/privacy-statement>.

Particulars dated September 2023. Photographs and videos dated May 2023.

All information is correct at the time of going to print. Knight Frank is the trading name of Knight Frank LLP. Knight Frank LLP is a limited liability partnership registered in England and Wales with registered number OC305934. Our registered office is at 55 Baker Street, London W1U 8AN. We use the term 'partner' to refer to a member of Knight Frank LLP, or an employee or consultant. A list of members names of Knight Frank LLP may be inspected at our registered office. If you do not want us to contact you further about our services then please contact us by either calling 020 3544 0692, email to [marketing.help@knightfrank.com](mailto:marketing.help@knightfrank.com) or post to our UK Residential Marketing Manager at our registered office (above) providing your name and address.