

Hornbeam Paddocks, Wolverton Fields, Norton Lindsey, Warwick

A wonderful equestrian opportunity in a desirable village close to Warwick, in 7.60 acres.

Situation

Hornbeam Paddocks is situated in Wolverton Fields, on the edge of Norton Lindsey. The village features a primary school, New Inn public house, village hall and church. The neighbouring village of Snitterfield is approximately 2 miles away and has a local village shop for everyday requirements and public house. There are more extensive shopping and recreational facilities in the nearby towns of Warwick, Leamington Spa and Stratford-upon-Avon. The area has an excellent range of state, private and grammar schools, including Stratford Prep School and The Croft Prep School in Stratford-upon-Avon. Warwick Prep School and Public School and King's High School for Girls in Warwick and in Leamington Spa, Kingsley School for Girls and Arnold Lodge.

Distances

M40 (J15) 3 miles, Warwick Parkway Station 3 miles (London Marylebone from 75 mins), Warwick 4 miles, Stratford-upon-Avon 5 miles, Birmingham 20 miles, Birmingham International Airport 24 miles (All distances and times approximate).

Description

Hornbeam Paddocks is an excellent equestrian smallholding in a popular village, accessed via a stoned road which leads to the entrance of the yard. This peaceful and private site has all the facilities you would require with the benefit of the village amenities within walking distance. This private site is located within close proximity to major motorway networks and equestrian facilities such as Solihull Riding Club, Swallowfield Equestrian and Moreton Morrell College.

There are four stables, including one foaling box and three further stables all with internal and external lighting and external electrical sockets. There is a securely fenced yard which consists of a tack room, stables, barn storage and feed room. There is an outside water tap on the yard, in the tack room and a further water tap in the front paddock. The land totals 7.6 acres with six field shelters, with all paddocks having access to self-filling water troughs.

There is a 40x20m all-weather manège topped with Flexiride® surface with surround lighting and drainage. The day cabin/office has gas, water, electricity, and a bathroom. Please note that the day cabin cannot be used as a residential dwelling (STPP).



Two wooden field shelters sit behind the cabin; one is fitted with a utility containing cold water supply, WC and shower. Just along from the cabin is a double level cold water pond. There is solar PIR lighting throughout and a hardcore parking area for vehicles.

There is a public footpath to the far right-hand side of the land, which is identified on the boundary plan and included within the boundary.



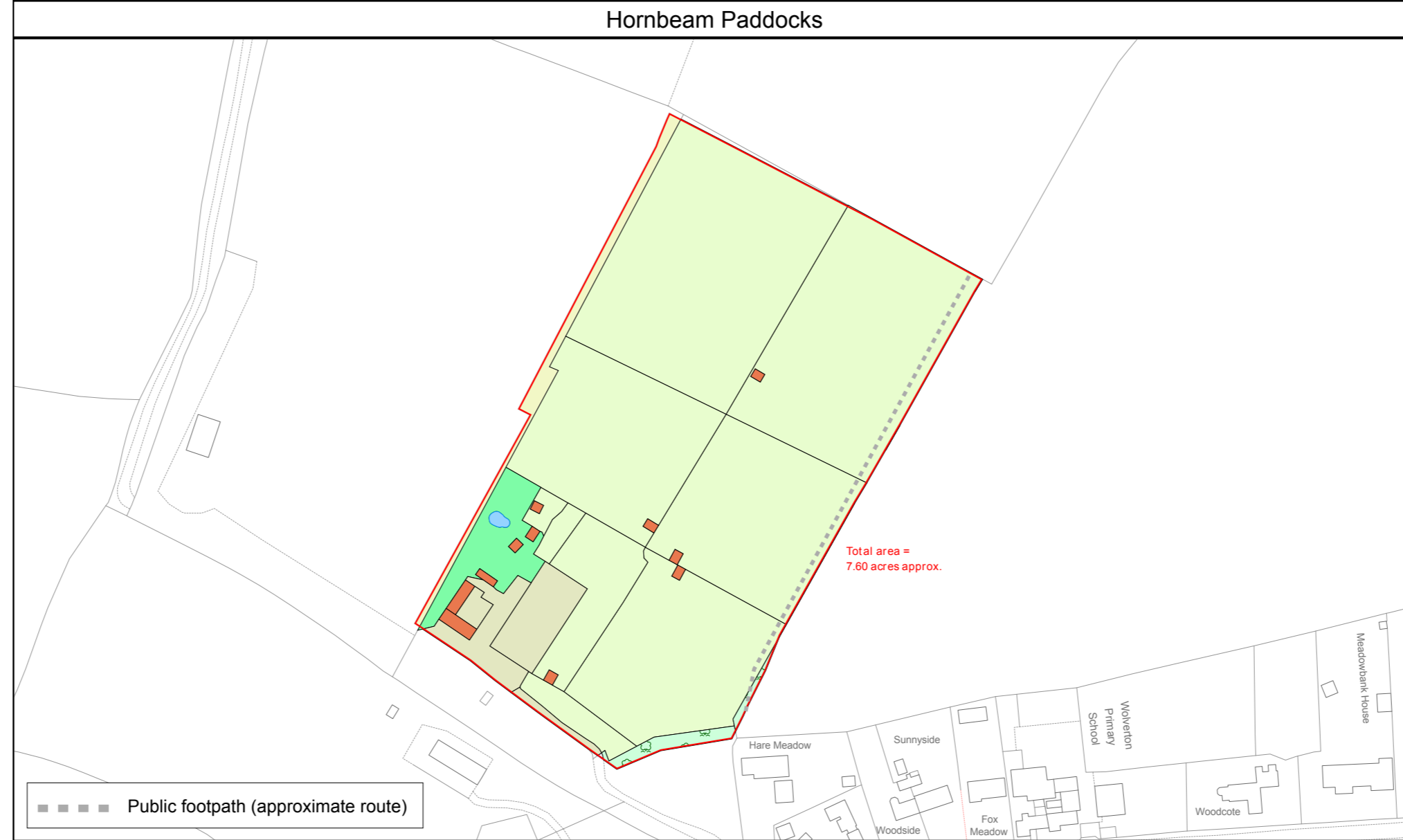

Public footpath (approximate route)

LDS Ltd
 Plan Preparation
 Unit 15, Glenmore Business Park
 Telford Road
 Salisbury SP2 7GL
 (e) planprep@lds-survey.co.uk

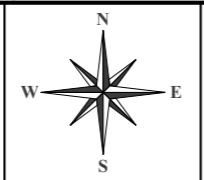

Date: 07:06:24
 Drawn By: CW
 Scale: 1:2000 @ A4
 Plan Ref: 18899

Title
Hornbeam Paddocks

This Plan is published for guidance only, and although it is believed to be correct its accuracy is not guaranteed, nor is it intended to form part of any contract. ©Crown copyright and database rights 2024. Licence No. AC000818786

Hornbeam Paddocks

Directions (CV35 9JN)
 What3words: // /ivory.insect.settle

Property information

Services Mains water, electricity and telephone landline/internet.
 Drainage is septic tank.

Local Authority Stratford on Avon District Council 01789 292522

Tenure Freehold.

Viewings By prior appointment only with the agents.



Approximate Gross Internal Floor Area

Day Cabin = 60 sq m / 646 sq ft

Outbuildings = 188 sq m / 2,024 sq ft

Total Area = 248 sq m / 2,670 sq ft

This plan is for guidance only and must not be relied upon as a statement of fact. Attention is drawn to the important notice on the last page of the text of the Particulars.

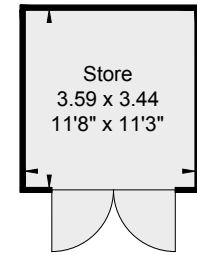
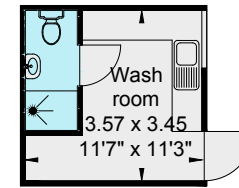
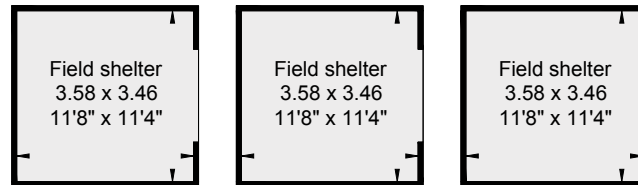
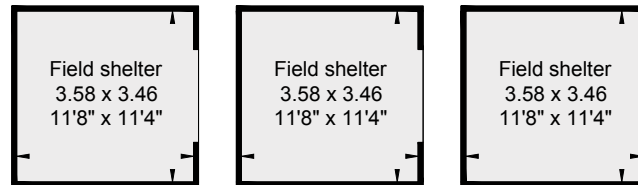
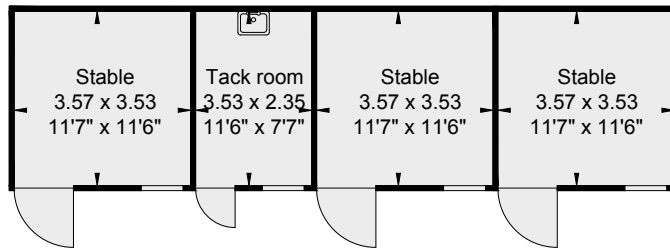
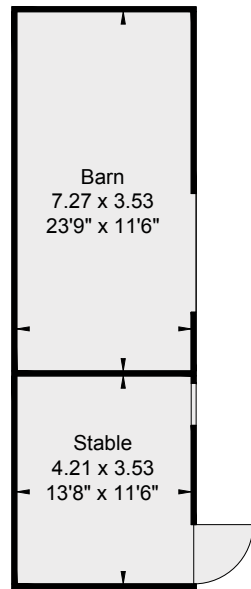

Outbuildings

Not shown in actual location / orientation

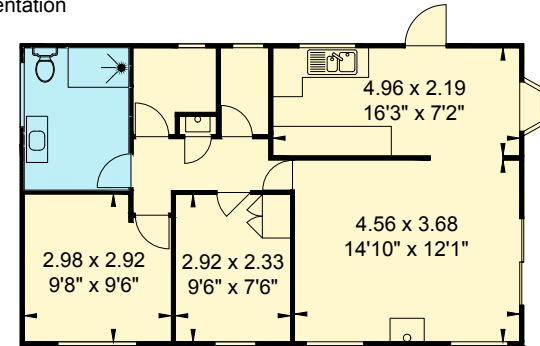

Day Cabin

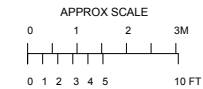

Knight Frank
Stratford Upon Avon
 Bridgeway
 CV37 6YX
knightfrank.co.uk

I would be delighted to tell you more
 Samantha Bysouth
 01789 206 954
samantha.bysouth@knightfrank.com



Fixtures and fittings: A list of the fitted carpets, curtains, light fittings and other items fixed to the property which are included in the sale (or may be available by separate negotiation) will be provided by the Seller's Solicitors.
 Important Notice: 1. Particulars: These particulars are not an offer or contract, nor part of one. You should not rely on statements by Knight Frank LLP in the particulars or by word of mouth or in writing ("information") as being factually accurate about the property, its condition or its value. Neither Knight Frank LLP nor any joint agent has any authority to make any representations about the property, and accordingly any information given is entirely without responsibility on the part of the agents, seller(s) or lessor(s). 2. Photos, Videos etc: The photographs, property videos and virtual viewings etc. show only certain parts of the property as they appeared at the time they were taken. Areas, measurements and distances given are approximate only. 3. Regulations etc: Any reference to alterations to, or use of, any part of the property does not mean that any necessary planning, building regulations or other consent has been obtained. A buyer or lessee must find out by inspection or in other ways that these matters have been properly dealt with and that all information is correct. 4. VAT: The VAT position relating to the property may change without notice. 5. To find out how we process Personal Data, please refer to our Group Privacy Statement and other notices at <https://www.knightfrank.com/legals/privacy-statement>.
 Particulars dated [June 2024]. Photographs and videos dated [June 2024].

All information is correct at the time of going to print. Knight Frank is the trading name of Knight Frank LLP. Knight Frank LLP is a limited liability partnership registered in England and Wales with registered number OC305934. Our registered office is at 55 Baker Street, London W1U 8AN. We use the term 'partner' to refer to a member of Knight Frank LLP or an employee or consultant. A list of members names of Knight Frank LLP may be inspected at our registered office. If you do not want us to contact you further about our services then please contact us by either calling 020 3544 0692, email to marketing.help@knightfrank.com or post to our UK Residential Marketing Manager at our registered office (above) providing your name and address.

Date: 28 June 2024
Our reference: STR012385172

Hornbeam Paddocks, Wolverton Fields, Norton Lindsey, Warwick, CV35 8JN

We have pleasure in enclosing details of the above land for which we are quoting a guide price of offers in excess of £500,000.

Please let us know if you need any further information about the land or surrounding area and we will be delighted to provide it.

Full details of all our properties and a wide range of services can be viewed online at knightfrank.co.uk. You can also receive early information on new properties coming on to the market by signing up to [My Knight Frank](#).

For additional information or to make arrangements to view the property, please get in touch.

We'd love to help you.

Yours faithfully



KNIGHT FRANK LLP

Enc:

Samantha Bysouth
Associate
+44 1789 206 953
samantha.bysouth@knightfrank.com

Knight Frank, Stratford
Bridgeway House, Bridgeway, Stratford upon Avon, CV37 6YX
+44 1789 297 735

knightfrank.co.uk

Your partners in property

Knight Frank LLP is a limited liability partnership registered in England and Wales with registered number OC305934. Our registered office is at 55 Baker Street, London W1U 8AN. We use the term 'partner' to refer to a member of Knight Frank LLP, or an employee or consultant. A list of members' names of Knight Frank LLP may be inspected at our registered office.

Regulated by RICS

V4.2 Feb 24