



13 Shakespeare Street
Stratford-upon-Avon, Warwickshire



**Knight
Frank**



A handsome double-fronted townhouse with an **unexpectedly large garden**, occupying a central location in Stratford-upon-Avon town centre.

Distances

Stratford-upon-Avon town centre 0.2 miles, M40 (J15) 7 miles
 Warwick and Warwick Parkway Station 9 miles, Leamington Spa 12 miles
 Chipping Campden 12 miles, Birmingham International Airport 23 miles
 (All distances and time are approximate)

Situation

Stratford-upon-Avon is renowned as the region's cultural centre and is the home of the Royal Shakespeare Company. In the town, there is a wide range of shopping and recreational facilities and many quality restaurants, public houses and gastro pubs with excellent reputations, all within easy walking distance.



5



4



3



Permit

EPC

C

Tenure

Freehold

Local Authority

Stratford on Avon District Council

Council Tax

Band E





The area is well served by schools, including The Croft Prep School, King Edward Grammar School for Boys, Shottery Grammar School for Girls and Stratford High School. Warwick and Leamington Spa, also nearby, provide additional shopping facilities and schools.

The M40 is easily accessible for the commuter, and there are regular trains from Stratford-upon-Avon and Warwick Parkway to Birmingham and London.

The property

13 Shakespeare Street occupies a prominent position on Shakespeare Street in Stratford-upon-Avon, totalling approximately 2,900 sq ft. This beautifully presented mid-terraced family home is ideally located in the town centre and has an array of period features including high ceilings and deep skirtings. The property has been sympathetically renovated and extended and offers extensive family accommodation arranged over three floors plus a cellar.

Upon entering the townhouse, you are greeted by a spacious dining hallway, which is a great room for entertaining, with front bay window and engineered oak flooring.





The cellar is accessed from the hallway as well as a guest cloakroom, and a door from the dining hall opens into a study, which has a window into the kitchen. The ground floor features well-proportioned living spaces, including a drawing room with front aspect, bay window with wooden blinds, alcove cupboards, radiator cover and a Firefox wood burning stove. There is underfloor heating in the dining hallway and the open plan kitchen.

The rear open-plan kitchen extension is a wonderful, expansive area ideal for modern-day living. A contemporary kitchen with high-quality appliances features a central island, breakfast seating, wooden worktops and tiled flooring. Sliding glazed doors open to the garden, creating a seamless connection between the indoor and outdoor spaces. Off the kitchen is a good-sized utility with built-in cupboards, basin and space for a washing machine and dryer.

Upstairs, the principal bedroom suite has a bay window, front aspect, walk-in wardrobe and en suite shower room. The other large bedroom is a similar size and has a built-in wardrobe and, an en suite-bathroom and walk-in shower.

On the second floor, the smallest bedroom (bedroom five) is currently used as a home office/dance studio. There are two further large double bedrooms with sash windows, built-in wardrobes and en suites – one with a bath and shower and the other with a large walk-in shower.







An attractive, large west-facing garden has a large terrace, which is ideal for entertaining. The length of the garden is rare for the location and ideal for a family, with a cladded outbuilding/shed located at the far end.

There is gated side access from the garden through a private passageway to the front of the house, which is a rarity for houses in town. Permitted parking is available on-street at the front of the property.

Services

All mains services are connected to the property. Gas-fired central heating.

Directions (CV37 6RN)

What3words: ///indoor.bliss.bound

Viewing

By prior appointment only with the agents.



Approximate Gross Internal Floor Area

House: 253 sq m (2,724 sq ft)

Store: 12 sq m (133 sq ft)

Total: 265 sq m (2,857 sq ft)

This plan is for guidance only and must not be relied upon as a statement of fact. Attention is drawn to the Important Notice on the last page of the text of the Particulars.

- Reception
- Bedroom
- Bathroom
- Kitchen/Utility
- Storage
- Outside

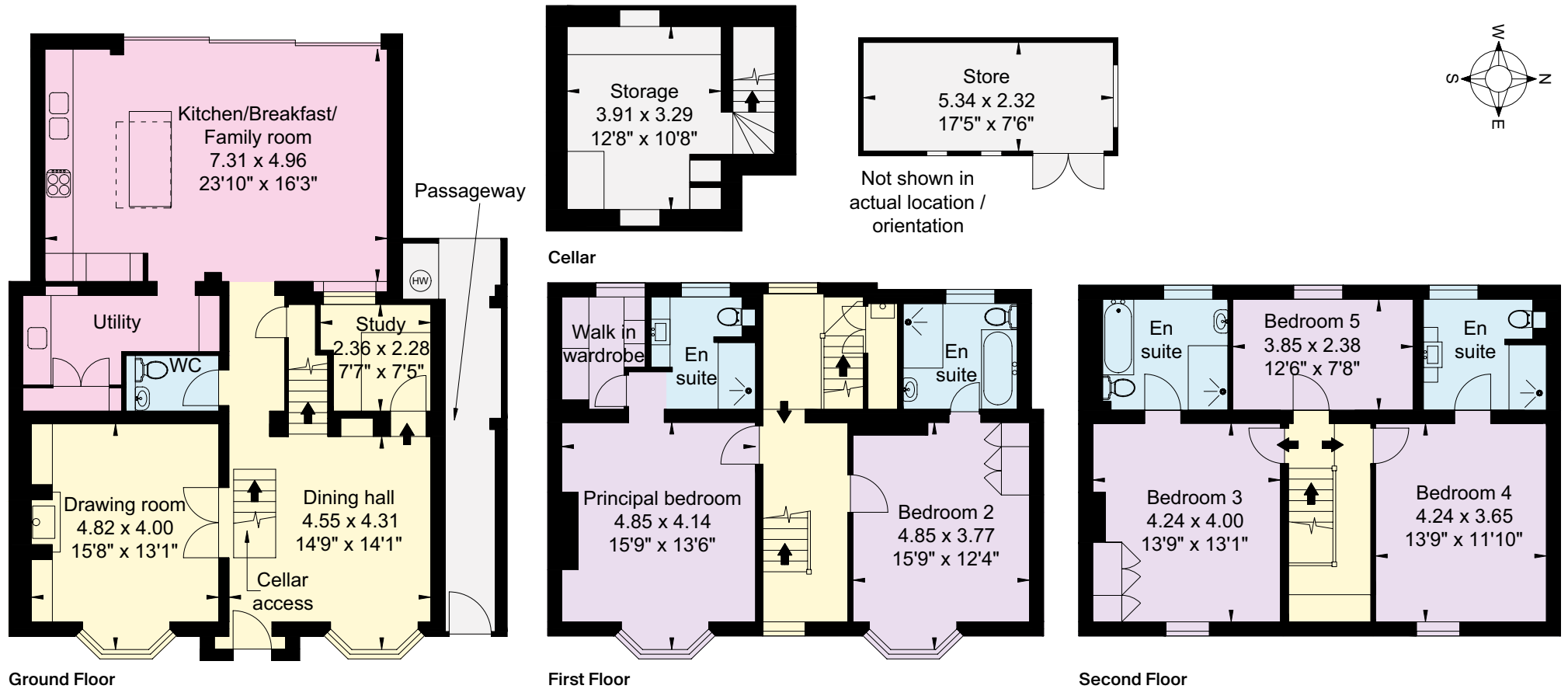



Knight Frank Stratford-upon-Avon
Bridgeway House, Bridgeway
Stratford-upon-Avon
Warwickshire CV37 6YX
[knightfrank.co.uk](https://www.knightfrank.co.uk)

I would be delighted to tell you more

Samantha Bysouth
01789 297735
samantha.bysouth@knightfrank.com



Fixtures and fittings: A list of the fitted carpets, curtains, light fittings and other items fixed to the property which are included in the sale (or may be available by separate negotiation) will be provided by the Seller's Solicitors.

Important Notice: 1. Particulars: These particulars are not an offer or contract, nor part of one. You should not rely on statements by Knight Frank LLP in the particulars or by word of mouth or in writing ("information") as being factually accurate about the property, its condition or its value. Neither Knight Frank LLP nor any joint agent has any authority to make any representations about the property, and accordingly any information given is entirely without responsibility on the part of the agents, seller(s) or lessor(s). 2. Photos, Videos etc: The photographs, property videos and virtual viewings etc. show only certain parts of the property as they appeared at the time they were taken. Areas, measurements and distances given are approximate only. 3. Regulations etc: Any reference to alterations to, or use of, any part of the property does not mean that any necessary planning, building regulations or other consent has been obtained. A buyer or lessee must find out by inspection or in other ways that these matters have been properly dealt with and that all information is correct. 4. VAT: The VAT position relating to the property may change without notice. 5. To find out how we process Personal Data, please refer to our Group Privacy Statement and other notices at <https://www.knightfrank.com/legals/privacy-statement>.

Particulars dated November 2024. Photographs and videos dated November 2024.

All information is correct at the time of going to print. Knight Frank is the trading name of Knight Frank LLP. Knight Frank LLP is a limited liability partnership registered in England and Wales with registered number OC305934. Our registered office is at 55 Baker Street, London W1U 8AN. We use the term 'partner' to refer to a member of Knight Frank LLP, or an employee or consultant. A list of members names of Knight Frank LLP may be inspected at our registered office. If you do not want us to contact you further about our services then please contact us by either calling 020 3544 0692, email to marketing.help@knightfrank.com or post to our UK Residential Marketing Manager at our registered office (above) providing your name and address. Brochure by [wordperfectprint.com](https://www.wordperfectprint.com)



Date: 15 November 2024
Our reference: STR012388962

13 Shakespeare Street, Stratford-upon-Avon, CV37 6RN

We have pleasure in enclosing details of the above property for which we are quoting a guide price of £1,295,000.

Please let us know if you need any further information about the property or surrounding area and we will be delighted to provide it.

Full details of all our properties and a wide range of services can be viewed online at knightfrank.co.uk. You can also receive early information on new properties coming on to the market by signing up to [My Knight Frank](#).

For additional information or to make arrangements to view the property, please get in touch.

We'd love to help you.

Yours faithfully



KNIGHT FRANK LLP

Enc:

Samantha Bysouth
Associate
+44 1789 206 953
samantha.bysouth@knightfrank.com

Knight Frank, Stratford
Bridgeway House, Bridgeway, Stratford upon Avon, CV37 6YX
+44 1789 297 735

knightfrank.co.uk

Your partners in property

Knight Frank LLP is a limited liability partnership registered in England and Wales with registered number OC305934. Our registered office is at 55 Baker Street, London W1U 8AN. We use the term 'partner' to refer to a member of Knight Frank LLP, or an employee or consultant. A list of members' names of Knight Frank LLP may be inspected at our registered office.

Regulated by RICS

V4.2 Feb 24