

First Floor

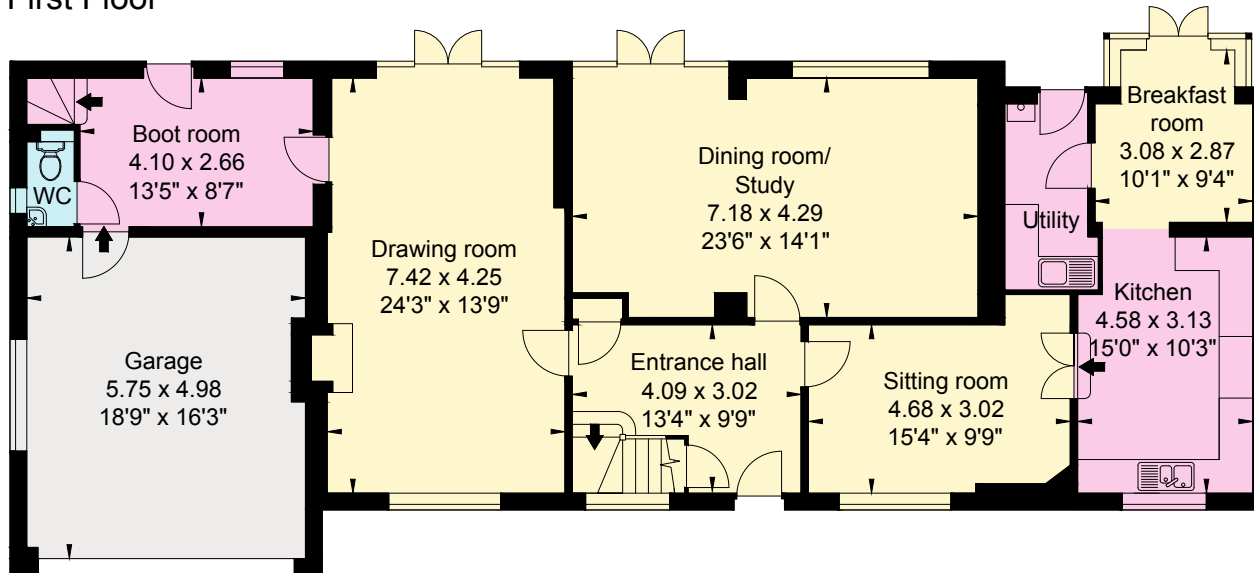

Ground Floor

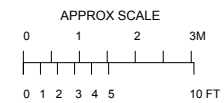

APPROXIMATE GROSS INTERNAL FLOOR AREA:

House: 281 sq m (3,025 sq ft)

Garage: 29 sq m (312 sq ft)

Total: 310 sq m (3,337 sq ft)

© Cotswold Plans Ltd ma/16276

This plan is for guidance only and must not be relied upon as a statement of fact. Attention is drawn to the Important Notice on the last page of text of the Particulars.

107 Tiddington Road
Stratford-upon-Avon